

## Setting Up Your MX870 In Default Mode (Tel Priority Mode) With An Answering Machine

# Connecting The Phone Lines

# Connecting Your Phone/Answering Machine

Is your answering machine built into your phone?

**YES**

[Click Here](#) or [Go To Page 12](#)

**NO**

Click the Next Button

# Fax to Phone Line Connection

## Before

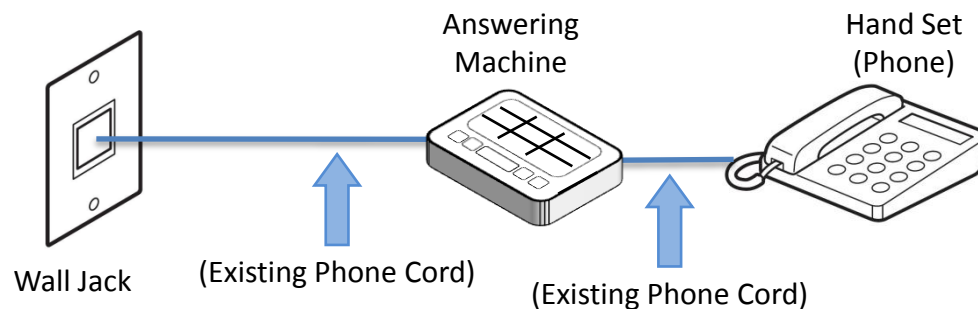

## After

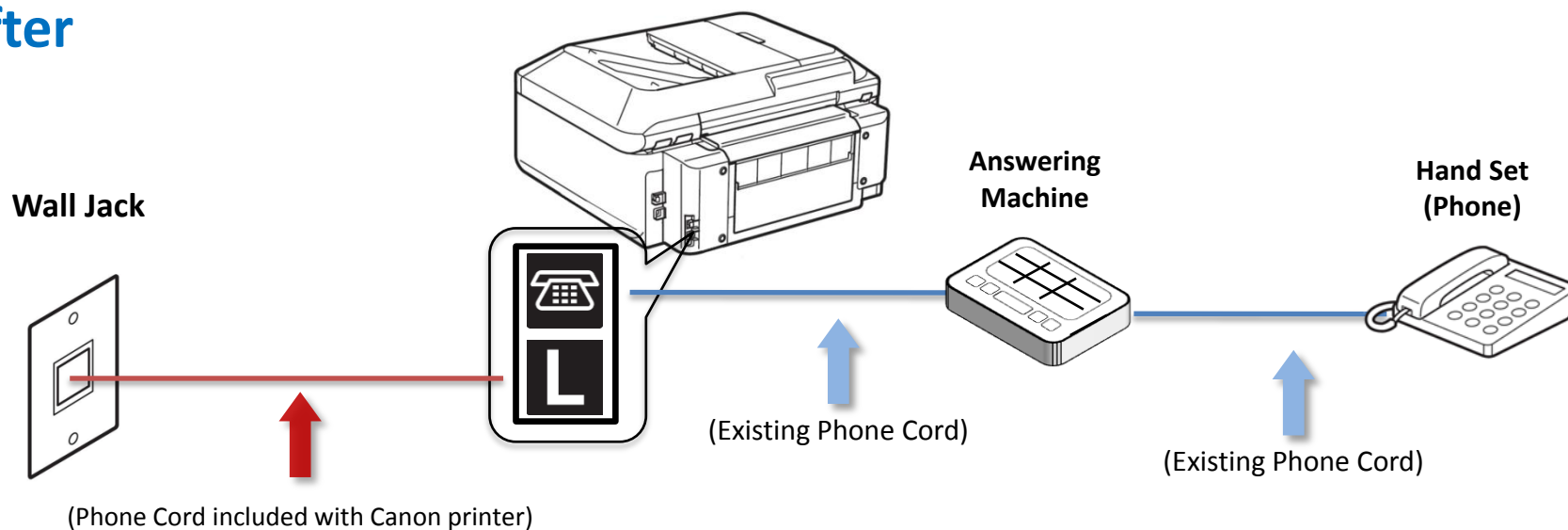

Previous

Next



# Fax to Phone Line Connection

- Plug the provided phone cord into the wall jack

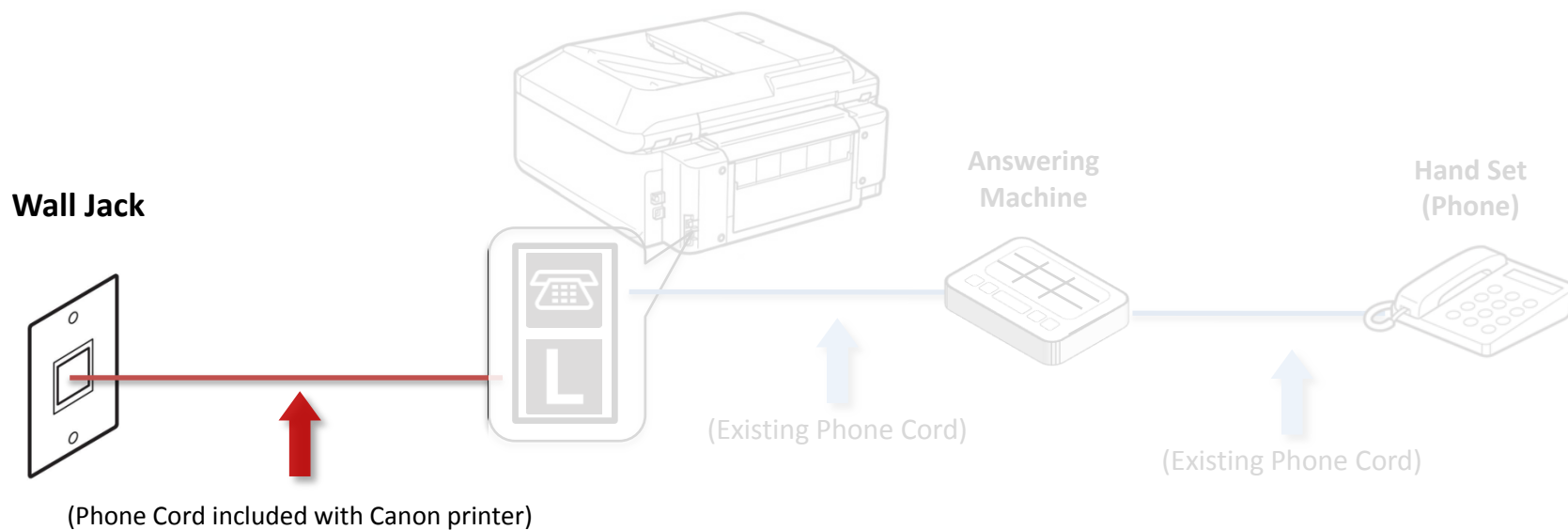

**Previous**

**Next**



# Fax to Phone Line Connection

- Plug the provided phone cord into the “L” jack located on the rear of the multifunction

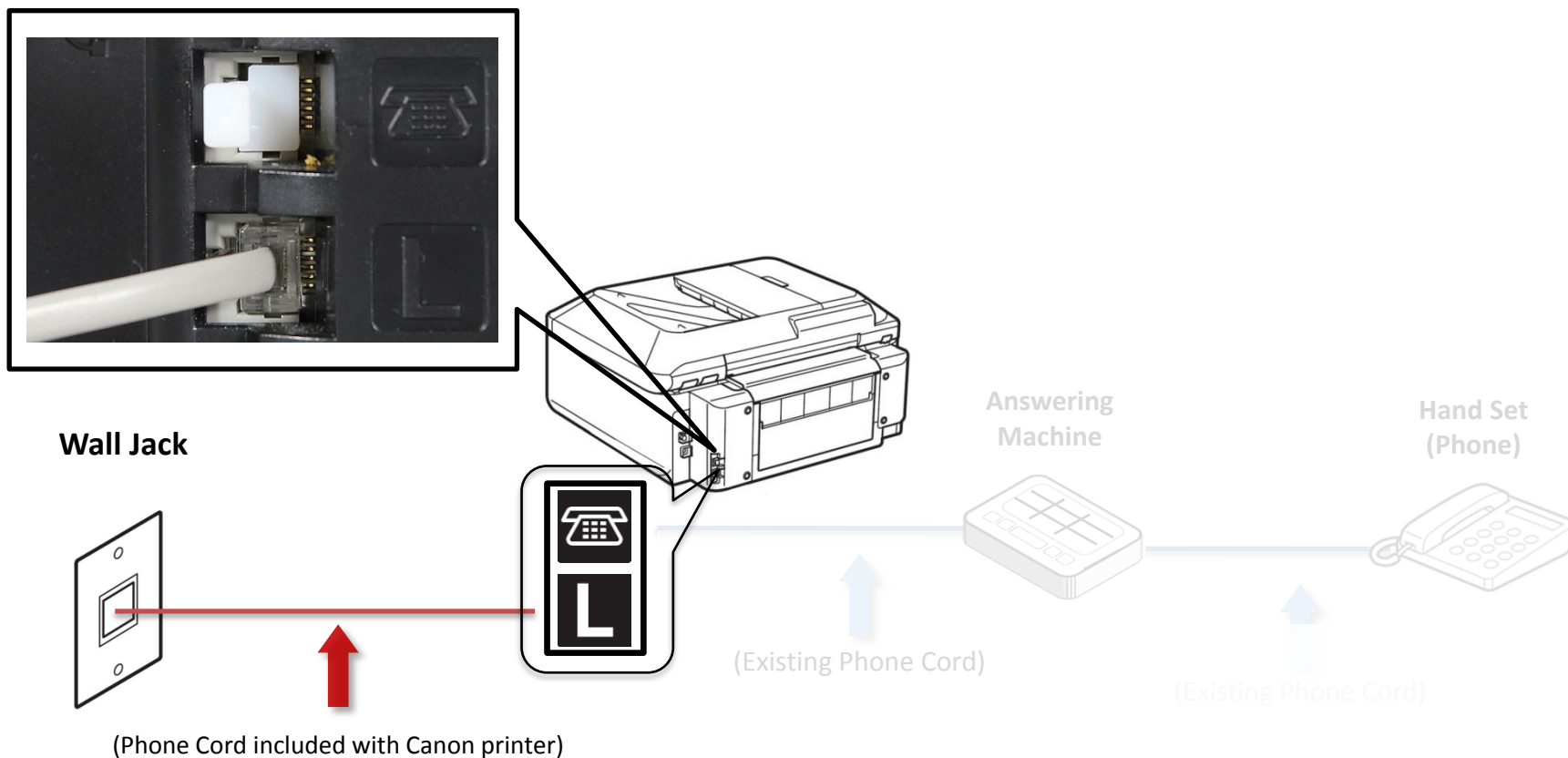

# Fax to Phone Line Connection

- Remove the white plug from the upper jack

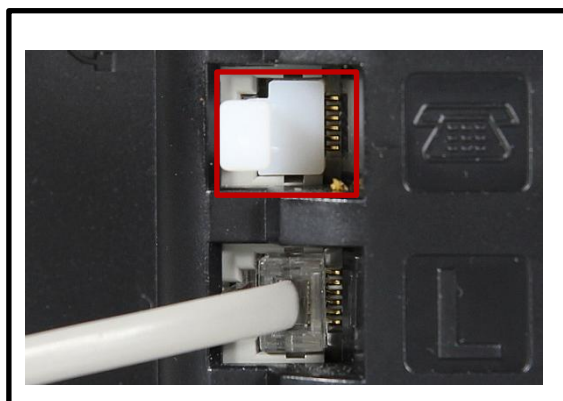

Wall Jack



(Phone Cord included with Canon printer)

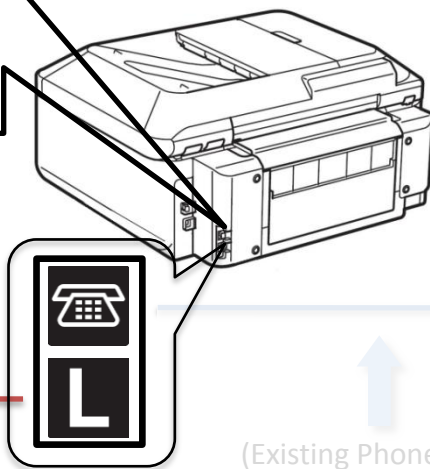

(Existing Phone Cord)

Answering Machine



Hand Set (Phone)



(Existing Phone Cord)



Previous

Next



# Fax to Phone Line Connection

- Plug the second phone cord into jack marked with an image of a “telephone” located on the rear of the multifunction.

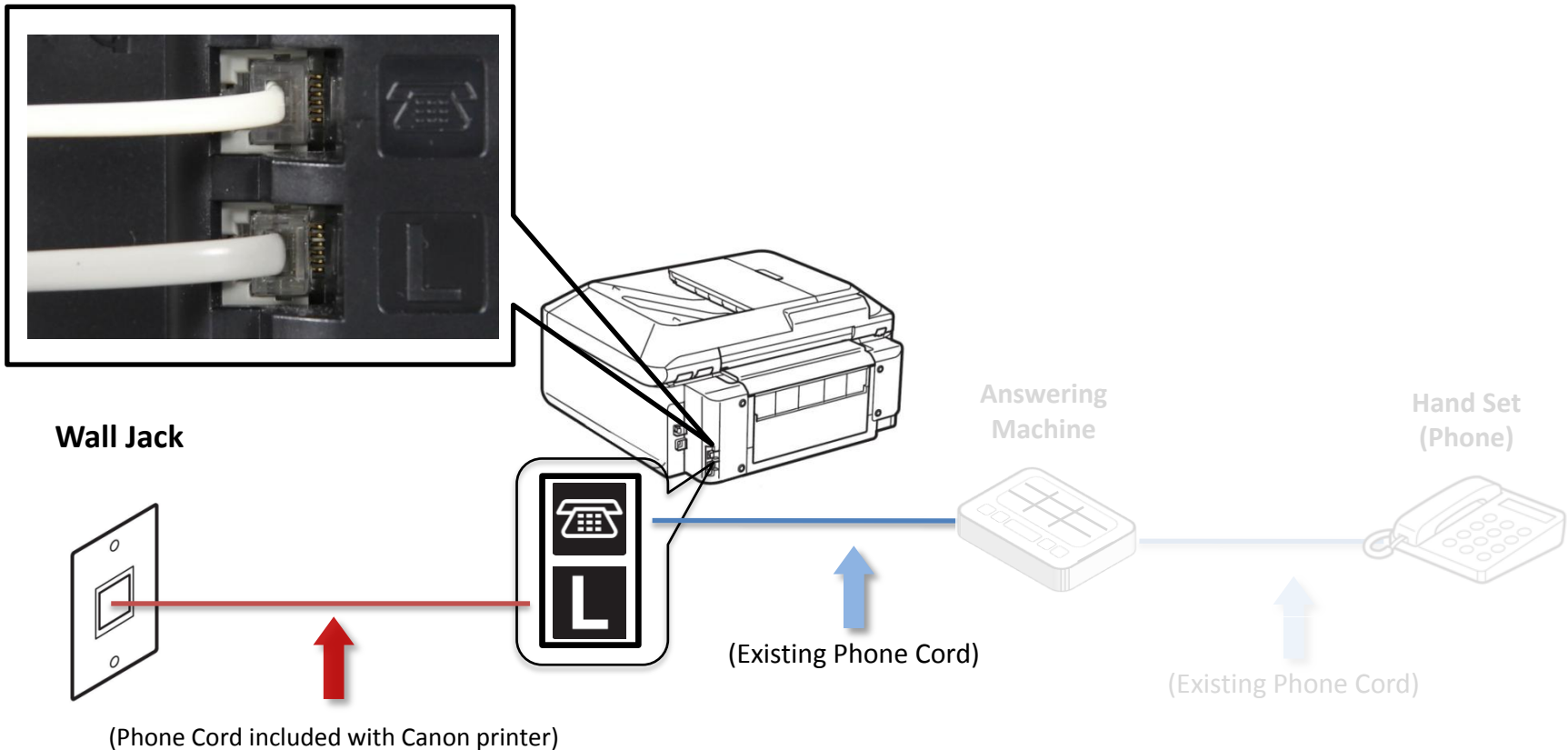



# Fax to Phone Line Connection

- Plug the second phone cord into the answering machine

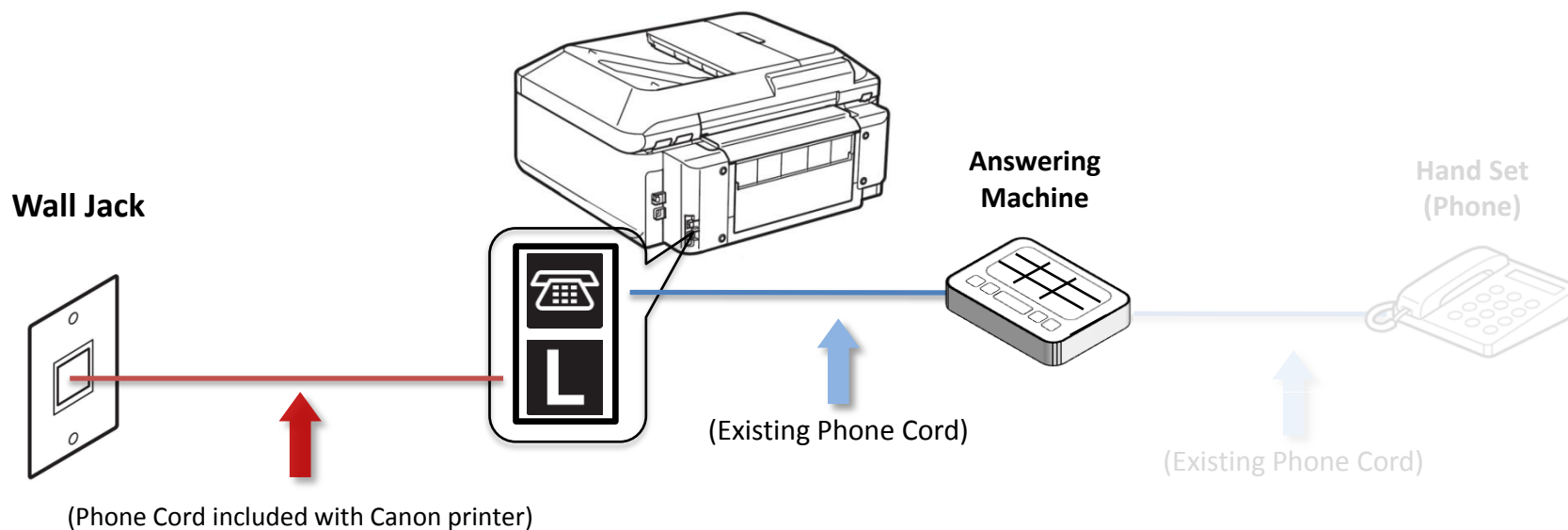

# Fax to Phone Line Connection

- Plug the third phone cord into the answering machine

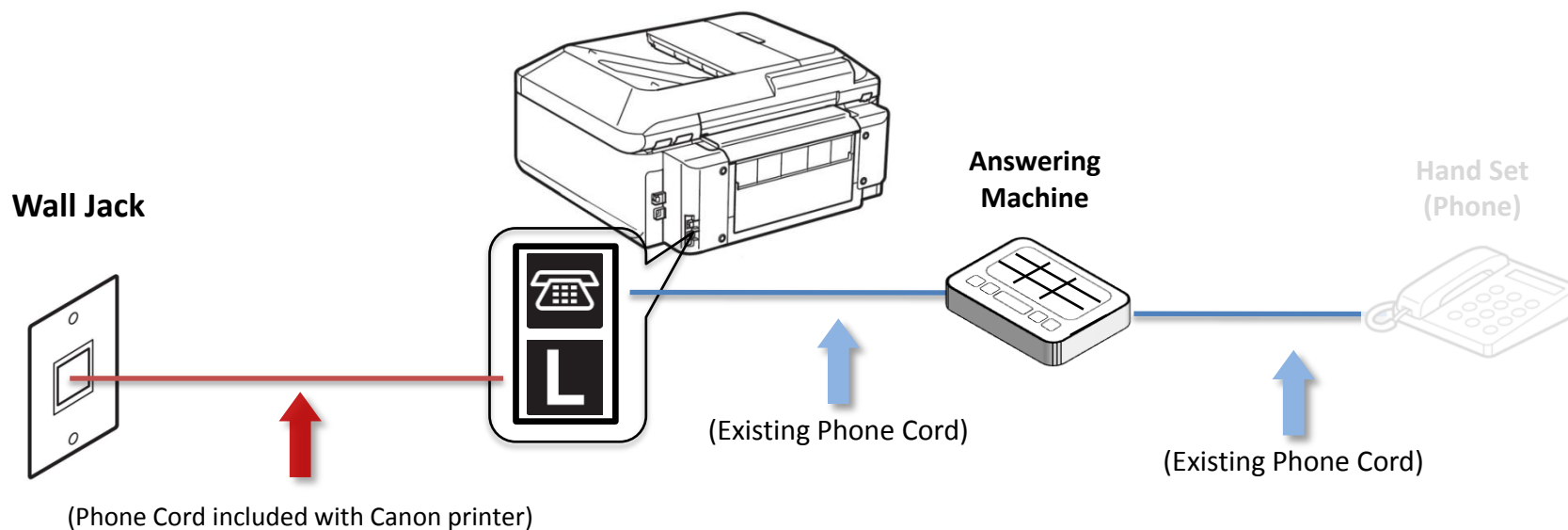

**Previous**

**Next**



# Fax to Phone Line Connection

- Plug the third phone cord into the phone

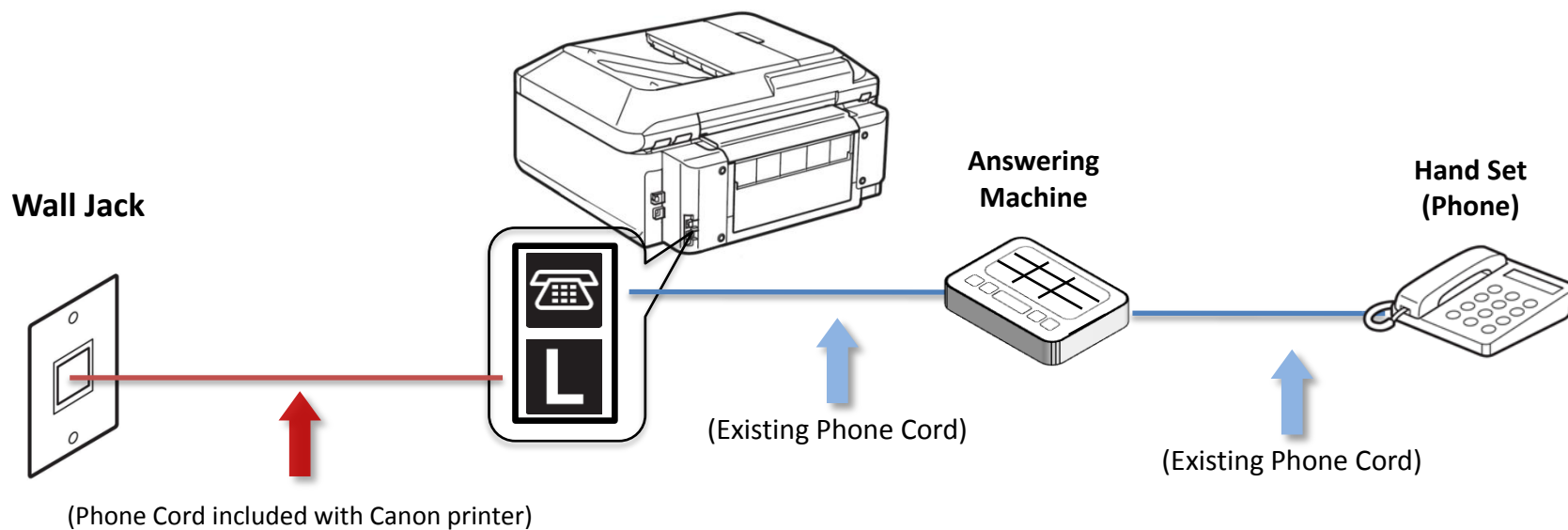

# Fax to Phone Line Connection

**Before**

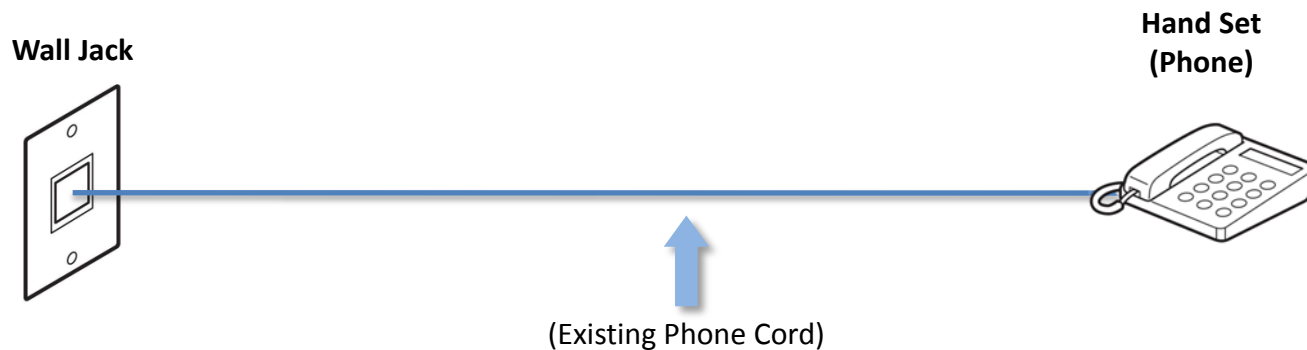

**After**

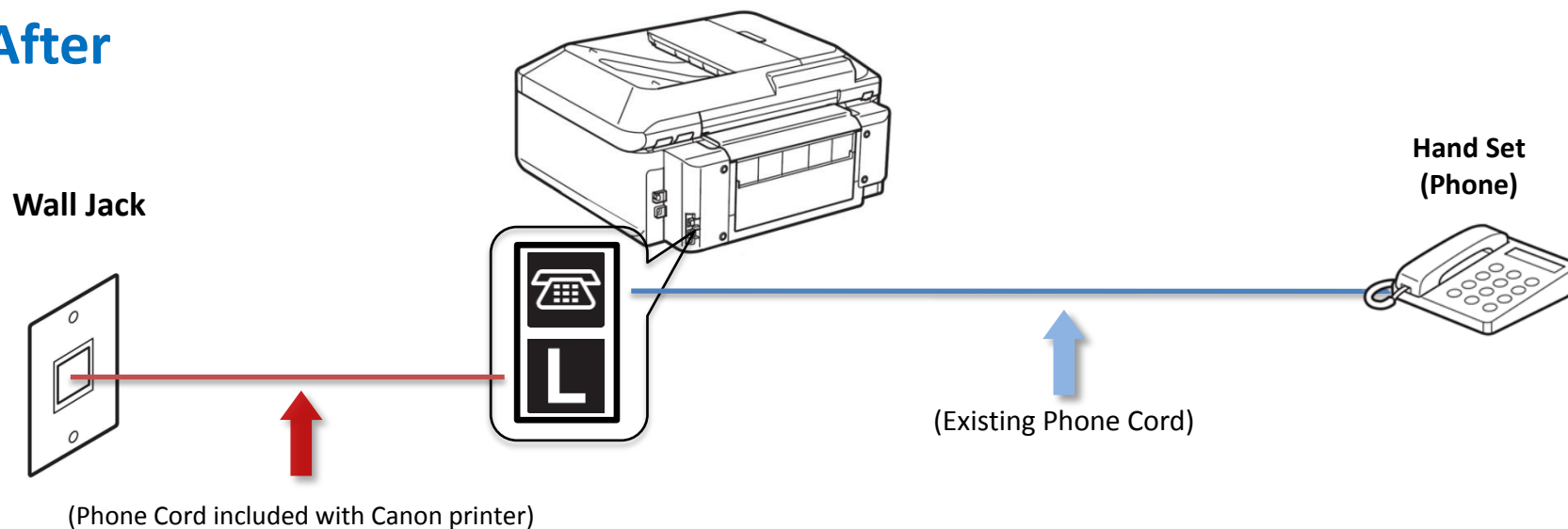

**Previous**

**Next**



# Fax to Phone Line Connection

- Plug the provided phone cord into the wall jack

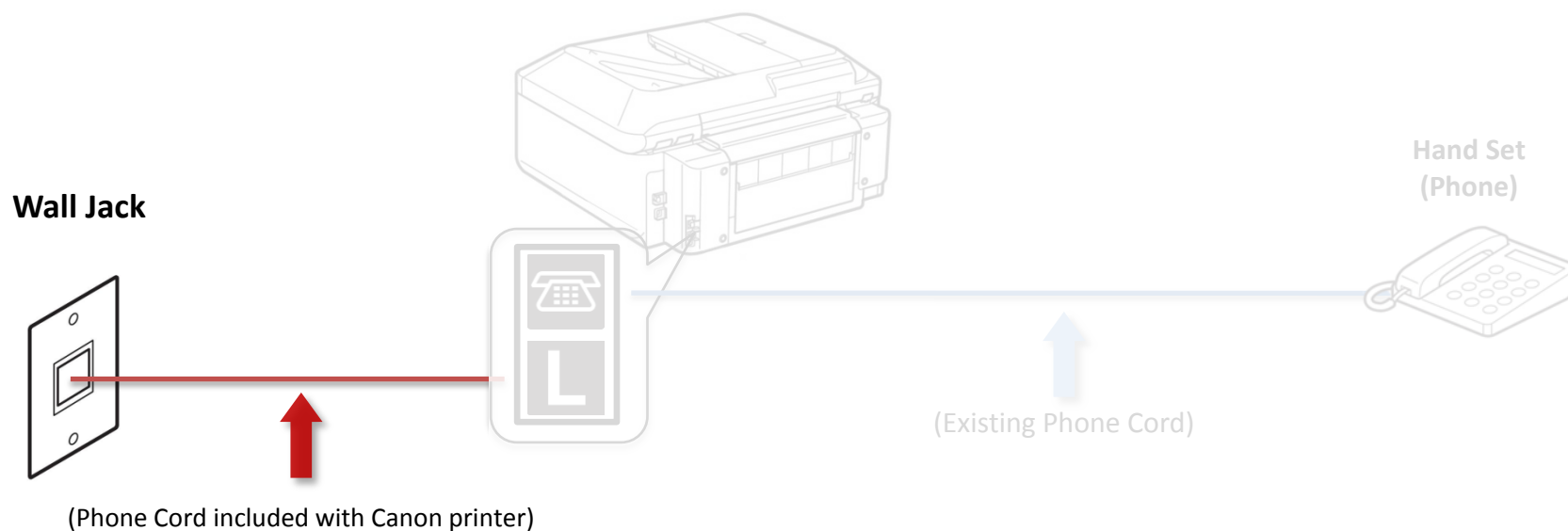

# Fax to Phone Line Connection

- Plug the provided phone cord into the “L” jack located on the rear of the multifunction

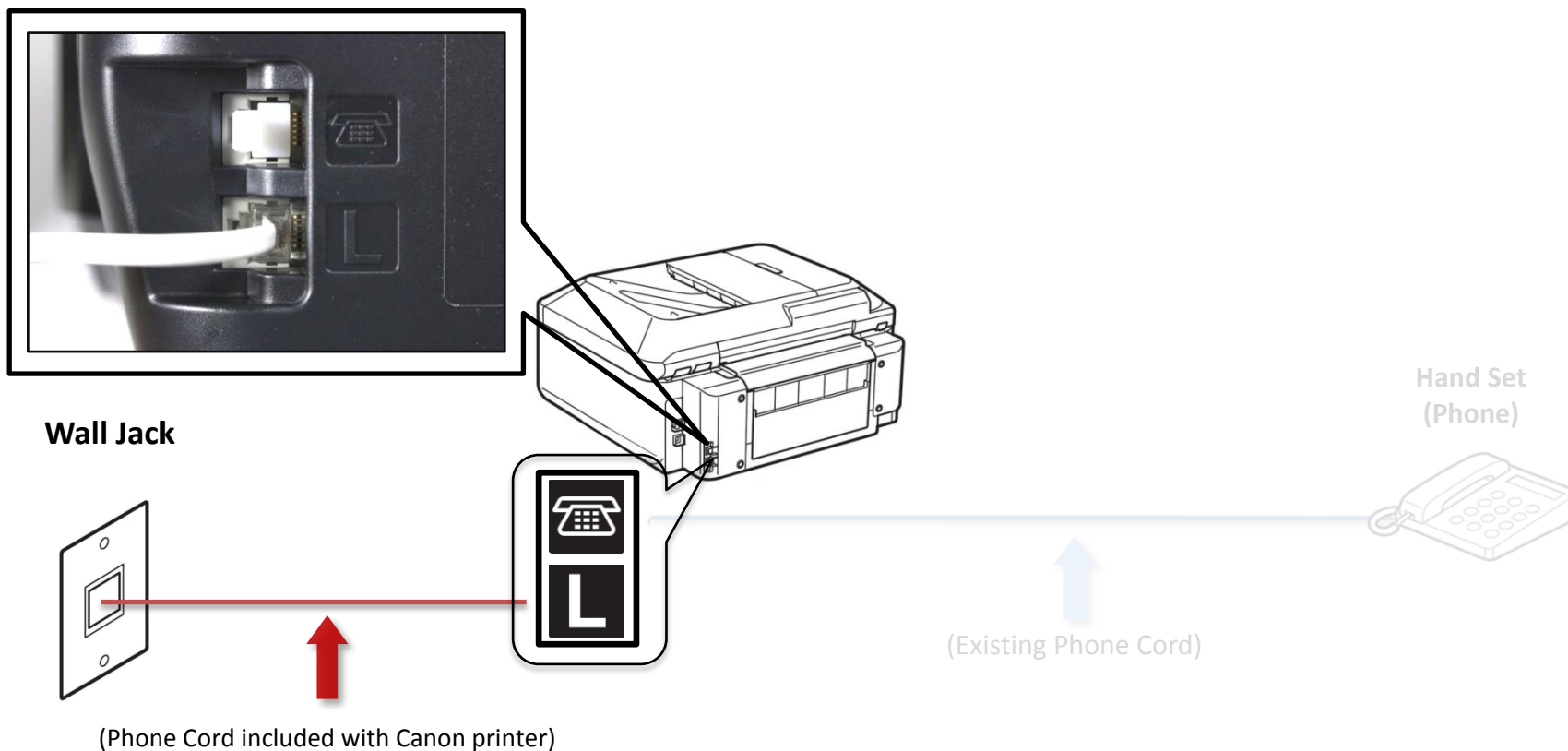

# Fax to Phone Line Connection

- Remove the white plug from the upper jack

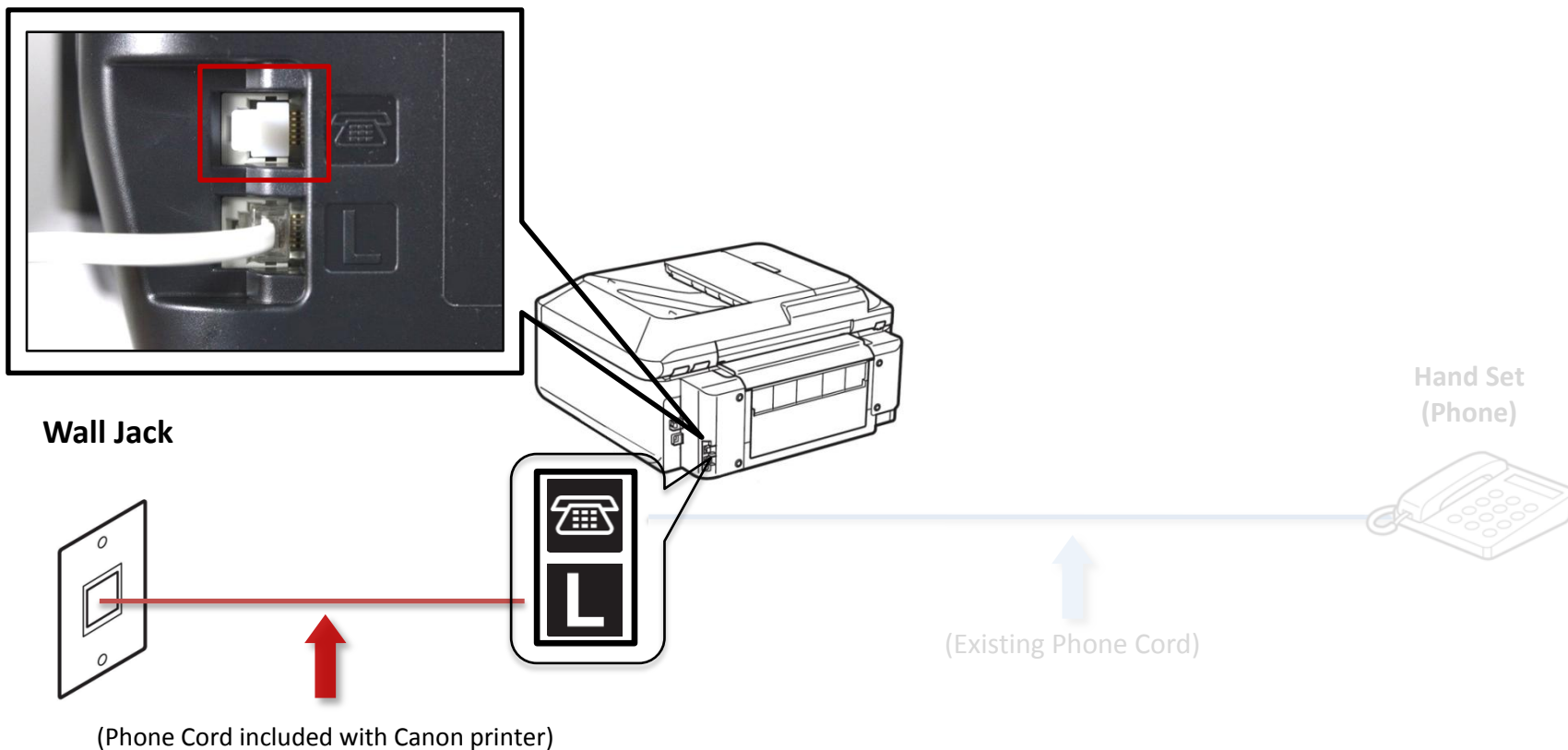

# Fax to Phone Line Connection

- Plug the second phone cord into jack marked with an image of a “telephone” located on the rear of the multifunction.

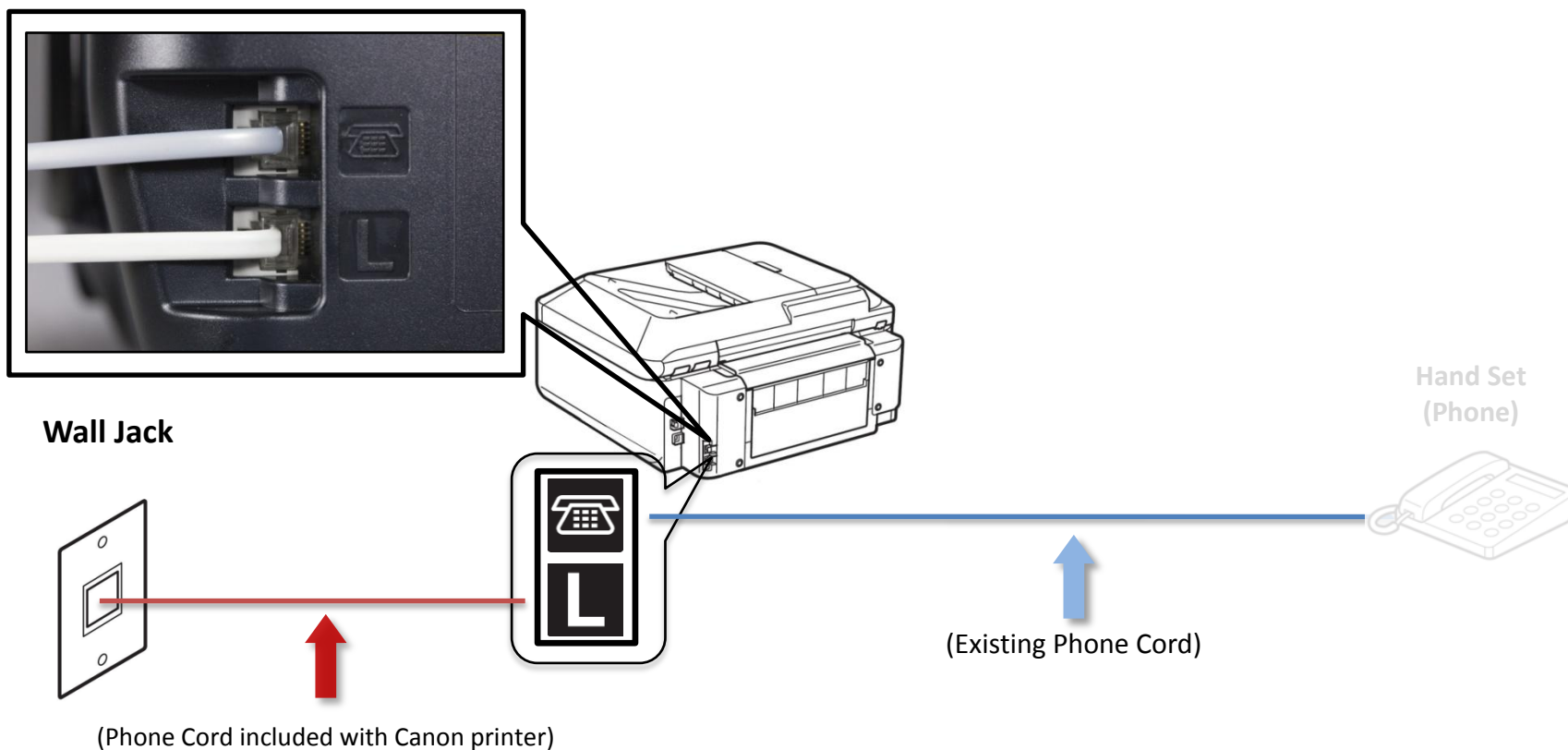



# Fax to Phone Line Connection

- Plug the second phone cord into the phone

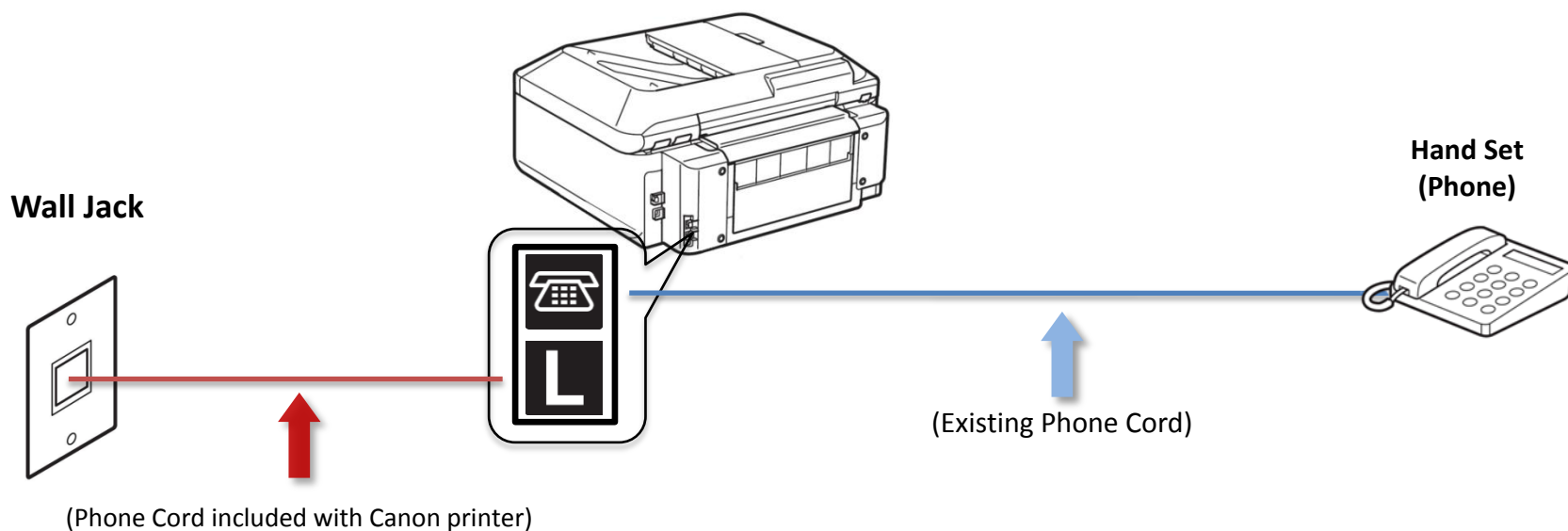

**Previous**

**Next**



# Setting Up The Receive Mode



**Return To “Connecting Your Phone/Answering Machine”**

**Next**



## Step 1

Turn on the MX870 by pressing the **ON** button.



## Step 2

Press the **FAX** button.



## Step 3

The fax standby screen will appear.



## Step 4

Press the center **FUNCTION** button.



## Step 5

The Receive mode settings screen will appear.



## Step 6

Use the **UP** or **DOWN** button to select "TEL priority mode".



## Step 7

Ensure that “TEL priority mode” is highlighted.



## Step 8

Press the **OK** button.



## Step 9

Your MX870 is now set to Tel priority mode. Notice that the mode is listed on the fax standby screen.





# Receiving A Fax

To receive a fax when you are home you will:

- Pick up the handset on the phone connected to the MX870.
- Listen for fax tones.
- When the tones stop hang up the handset.
- The MX870 will receive the fax document.

To receive a fax while you are away:

- The answering machine will answer the call.
- If fax tones are heard by the MX870 it will take over the call and receive the fax document.

**IMPORTANT:** In order to receive a fax, you must either pick up the handset on a phone that is connected to the MX870 or let your answering machine answer the call.

