



# Dedicated Fax Line Setup Guide

MX330





# Connecting The Phone Lines



# Connecting The Phone Lines

**Before**

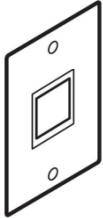

Wall jack

**After**

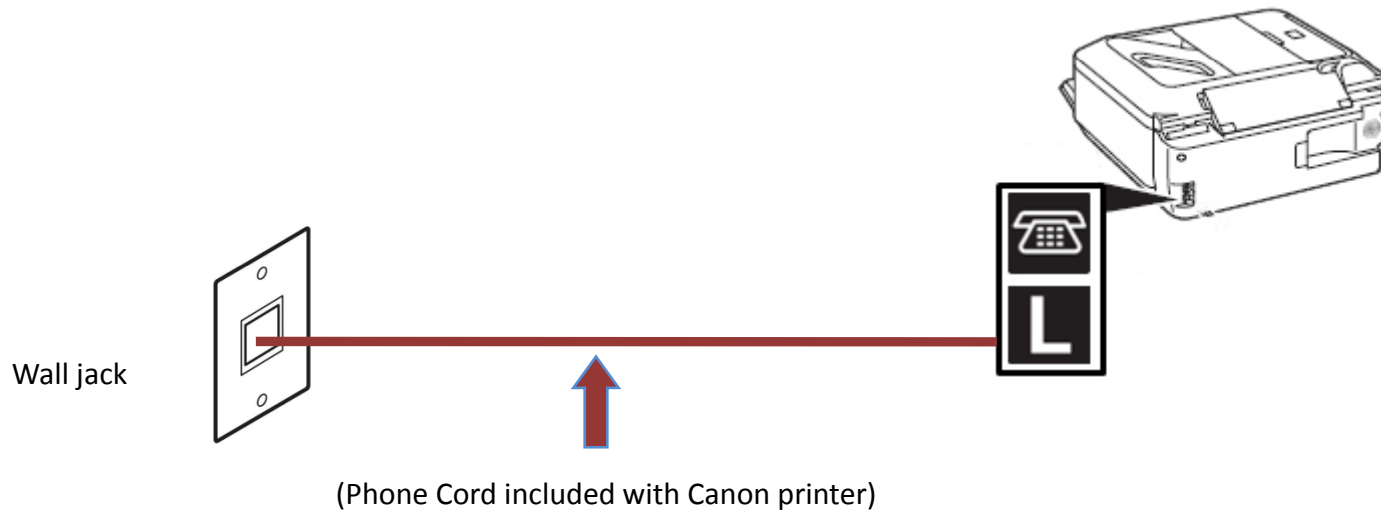

# If Your Wall Plate Has Two Jacks

Use the jack that supports the fax line.



# If Your Wall Plate Has One Jack For Two Lines

If your wall jack provides one jack for two phone lines, it would be best to use a “2 Line 3 Way Adapter.” This adapter can be purchased at most stores that sell electronics. This device creates three plugs where there was one. One jack will be for your voice line. The other jack can be used for your fax transactions. In most cases, line 1 (L1) is used for phone calls; L2 is used of faxing. The third jack (L1+L2) allows access to both lines. This is where you would plug in a 2-line telephone, if available.



The L1 jack is usually your voice line

The L2 jack is usually your fax line

# Fax to Phone Line Connection

First, connect one end of the supplied telephone cord to the telephone jack on the wall.

---

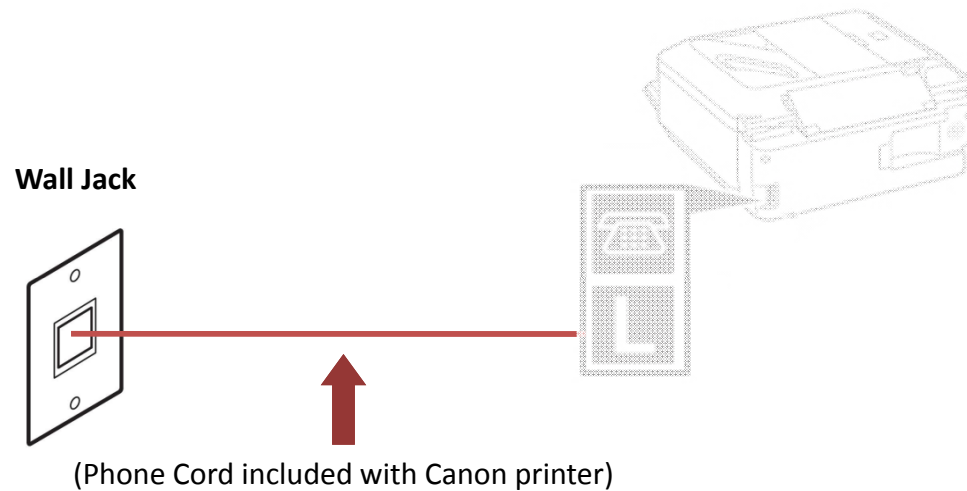

# Fax to Phone Line Connection

Next, connect the other end of the supplied telephone cord to the lower jack (labeled "L") on the MX330.

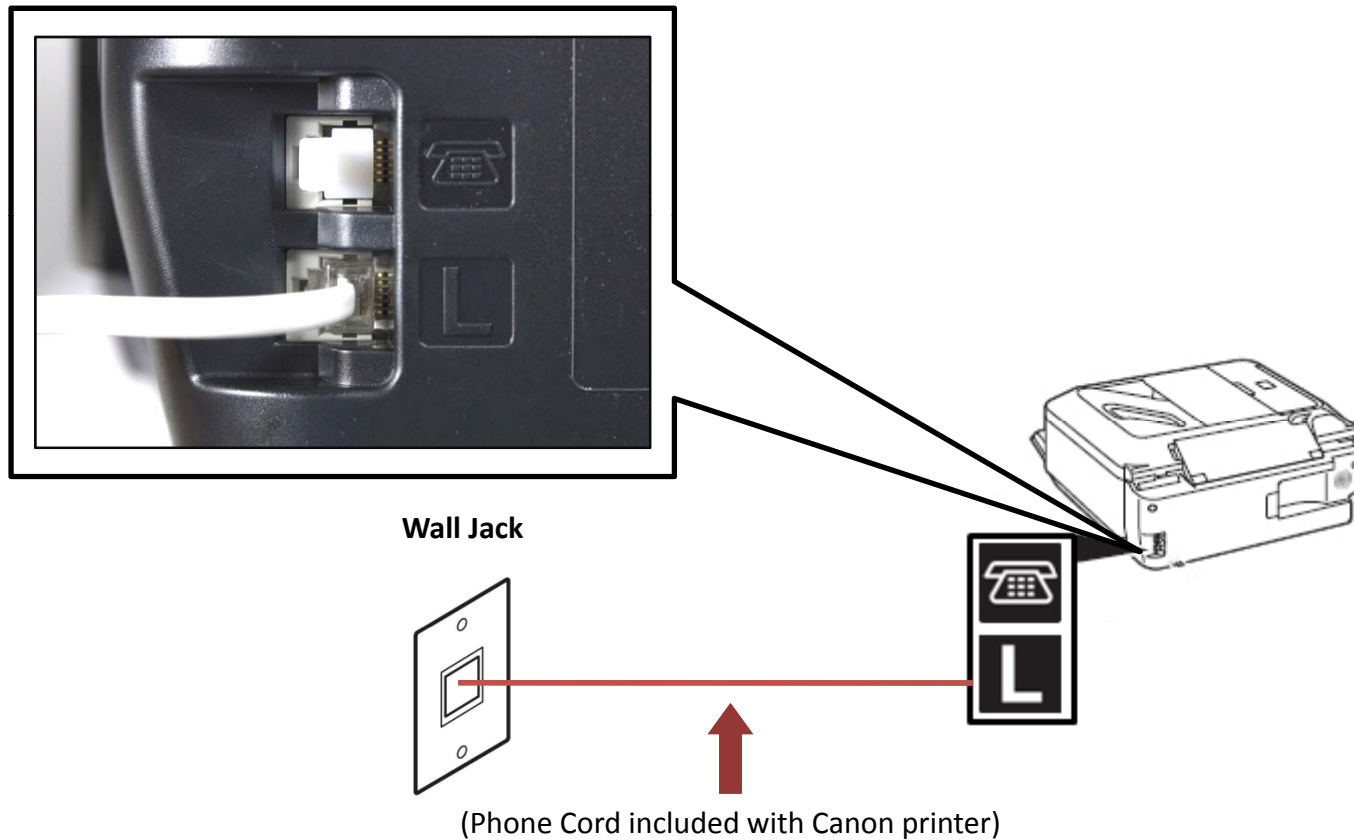



# Setting Up The Receive Mode





## Step 1

Turn on the MX330 by pressing the **ON** button.



## Step 2

Press the **FAX** button.



## Step 3

The fax standby screen will appear.



## Step 4

Press the **MENU** button.



## Step 5

The FAX menu will appear.



## Step 6

Press the **OK** button.



## Step 7

The Receive mode settings screen will appear.



## Step 8

Use the **UP** or **DOWN** button to select "FAX only mode".



## Step 9

Ensure that “FAX only mode” is highlighted.



## Step 10

Press the **OK** button.



## Step 11

The FAX menu will appear.



## Step 12

Press the **FAX** button.



## Step 13

Your MX330 is now set to FAX only mode. Notice that the mode is listed on the fax standby screen.



## To Receive A Fax

When a call comes in on the fax line, the MX330 will answer the call and begin receiving the fax.

You do not have to be home or interact with the MX330 to receive a fax.

