



Connecting to a Smartphone

Connecting to a Smartphone

When establishing a Wi-Fi connection with a smartphone, you can either use the camera as an access point or use another access point.

Follow these instructions when using the camera as an access point. When using another access point, see “Connecting to Access Points in the List” (📖 137).

Installing CameraWindow on a Smartphone

Before connecting your camera to a smartphone, first install the free dedicated application, CameraWindow, on your smartphone.



1 Connect the smartphone to a network.



2 Install CameraWindow.

- For an iPhone, iPad, or iPod touch, download and install CameraWindow from the Mac App Store.
- For an Android device, download and install CameraWindow from Google Play.



3 Register the smartphone name.

- On the smartphone, start CameraWindow and enter a name for the smartphone that will be displayed on the camera.



- For details on this application (supported smartphones and included functions), refer to the Canon website.

Establishing the Smartphone Connection

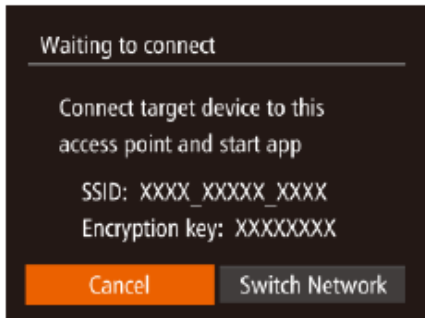
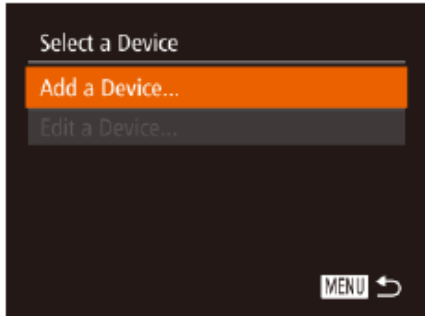

1 Access the Wi-Fi menu.

- Press the <▲> button.

2 Choose a smartphone.

- Press the <▲><▼><◀><▶> buttons or turn the <⦿> dial to choose , and then press the <FUNC SET> button.

3 Choose [Add a Device].

- Press the <▲><▼> buttons or turn the <⦿> dial to choose [Add a Device], and then press the <FUNC SET> button.

- ▶ The camera's SSID and encryption key are displayed on the screen.

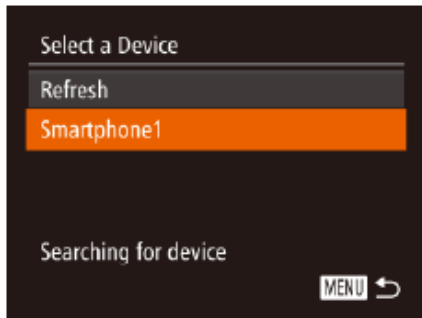

4 Use the smartphone to connect to the network displayed on the camera screen.

- Choose the displayed SSID (network name) from the smartphone's Wi-Fi setting menu.
- Enter the encryption key displayed on the camera screen into the password field on the smartphone.

5 Start CameraWindow on the smartphone.

- ▶ Once the smartphone is recognized on the camera, the device connection screen will be displayed on the camera.

6 Choose a smartphone to connect to.

- Choose the smartphone for the connection (📖 130) (either by pressing the <▲><▼> buttons or by turning the <🌀> dial), and then press the <FUNC SET> button.

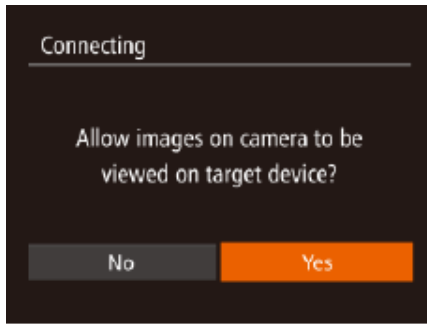

7 Adjust the privacy settings.

- Press the <◀><▶> buttons or turn the <⊙> dial to choose [Yes], and then press the <FUNC SET> button.
- ▶ You can now use the smartphone to receive images sent from the camera, or to geotag images on the camera (📖144).
- ▶ When the smartphone has been added successfully, the image transfer screen will be displayed. Proceed to “Sending Images” (📖141).



- When you are in the vicinity of an access point that you have previously connected to, the camera will automatically connect to it in step 3. To change access points, select [Switch Network] from the screen that will be displayed when the connection is being established, and follow steps 4 – 5 in “Adding a Computer” (📖136).
- All camera images can be viewed from the connected smartphone when you choose [Yes] in step 7. To keep camera images private, so that they cannot be viewed from the smartphone, choose [No] in step 7.

Connecting to a Smartphone



- You can connect to smartphones that you have already connected to by choosing them on the [Select a Device] screen in step 3.
- After you have accessed the Wi-Fi menu once, you can access it again by pressing the <▲> button. The recent target device is listed first, so you can easily connect again by pressing the <▲><▼> buttons to choose it. To add a new device, display the device selection screen by pressing the <◀><▶> buttons, and then configure the setting. If you prefer not to display recent target devices, press the <MENU> button, and on the [f†] tab, choose [Wi-Fi Settings] ▶ [Target History] ▶ [Off].
- The image quality level for movies that can be sent may differ depending on the smartphone. Refer to the instruction manual provided with your smartphone for details.
- To add multiple smartphones, repeat the above procedures starting from step 1.
- To change privacy settings for smartphones added to the list, choose the smartphone whose settings you want to change from [Edit a Device] in step 3, and then choose [View Settings].