



Connecting to a Printer

Connecting to a Printer

Connect the camera to a printer via Wi-Fi to print as follows.

When establishing a Wi-Fi connection with a printer, you can either use the camera as an access point (Camera Access Point mode) or use another access point.

Follow these instructions when using the camera as an access point. When using another access point, see "Connecting to Access Points in the List" (📖 96) in "Adding a Computer".

1 Access the Wi-Fi menu.

- Touch [(📶)] (📖 88).



2 Choose a printer.

- Touch [(🖨️)].

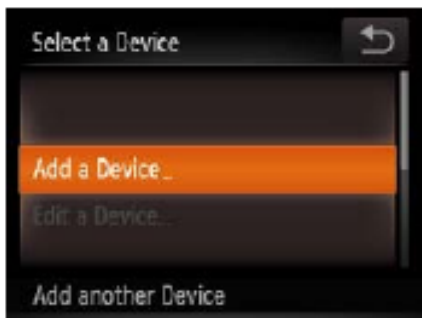

3 Choose [Add a Device].

- Touch [Add a Device].

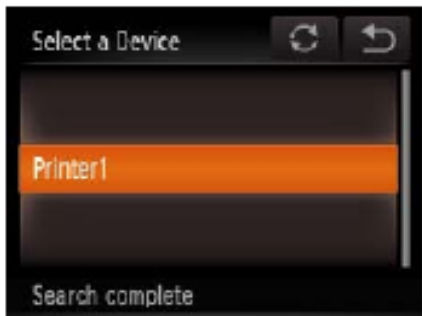
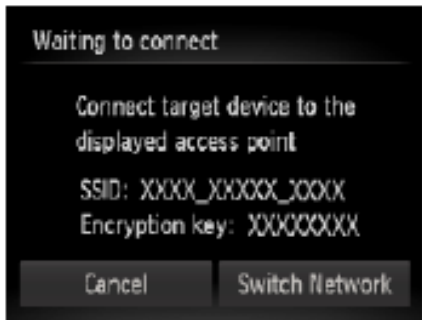

4 Use the printer to connect to the network displayed on the camera screen.

- Choose the displayed SSID (network name) from the printer's Wi-Fi setting menu.

5 Choose the printer.

- Once the printer is ready for the connection, touch the printer name when it is displayed on the camera.
- ▶ When the printer has been added successfully, the printing screen will be displayed.

6 Choose an image to print.

- Drag left or right across the screen to choose an image. Touch [FUNC.] and then [🖨️].
- ▶ Printing now begins.
- For detailed printing instructions, see "Printing Images" (📖 115).



- You can connect to access points that you have already connected to by choosing them on the [Select a Device] screen in step 3.
- When a connection destination is set using the Touch Actions setting (📖 76), you can automatically access the function to connect to the last connected destination from the next time by just dragging on the screen without needing to perform the connection operation.