



Easy Connection to a Connect Station

Easy Connection to Connect Station

Connect Station (sold separately) is a device that allows you to import captured still photos and movies for viewing on your TV set, smartphone, etc., or sharing them over a network.

You can easily save still photos and movies to Connect Station by holding this camera close to Connect Station.

This section explains how to connect the camera and Connect Station (sold separately) via a wireless LAN. To save images in other ways, refer to the Connect Station instruction manual.

- Set up the camera to allow use of its NFC function in advance (p.28).

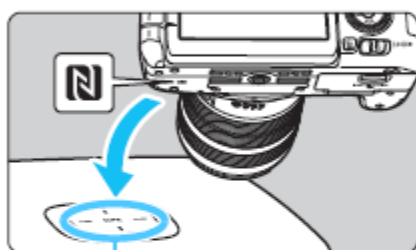

NFC connect point

1 Set up the camera to allow use of its NFC function (p.28).

2 Hold the camera close to Connect Station.

- Turn on the camera and Connect Station, then hold the camera's **N** mark close to the Connect Station's NFC connect point.
- ▶ A message indicating the connection is displayed on the camera's LCD monitor.
- When a connection is established, Connect Station checks the images on the memory card, then saves only the unsaved images.

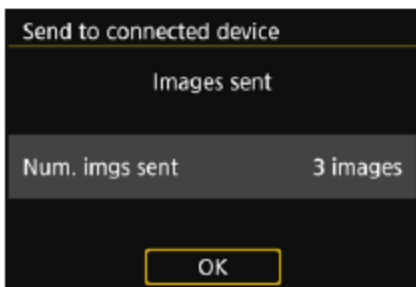

3 Terminate the connection.

- After images are saved, the screen on the left will appear on the camera's LCD monitor. Press **< (SET) >** to terminate the connection.



- Do not drop the camera on Connect Station or touch the camera to it with too much force. Doing so may damage Connect Station's internal hard disk.
- Since the camera may not be recognized readily, hold it carefully close to Connect Station while changing the camera's position or angle.
- Just holding the camera close to Connect Station may not establish a connection. In such a case, gently touch Connect Station with the camera.
- A connection cannot be established via the NFC function while shooting with the camera, when the power switch is set to <[OFF]>, when there is no card, or when the LCD monitor is closed with the screen facing inward.
- When holding the camera close to Connect Station, do not leave anything between the camera and Connect Station. In addition, when a case is attached to the camera, communication may not be possible via NFC function.
- When Battery Grip BG-E18 (sold separately) is attached, a connection cannot be established via the NFC function.
- If the camera and Connect Station are moved too far away from each other while importing images, import may take time or the connection may be terminated.
- If the camera's battery runs out during import, the import will stop. Charge the battery, then try importing again.



- A connection can be established even when the camera's power is in the auto power off state. However, if a connection cannot be established, cancel auto power off, then establish a connection.
- When all images are already imported, import does not start. In such a case, select [OK] to terminate the connection.
- When there are a large number of images on the memory card, it may take time to check and save the images.