

PRODUCT SPECIFICATIONS

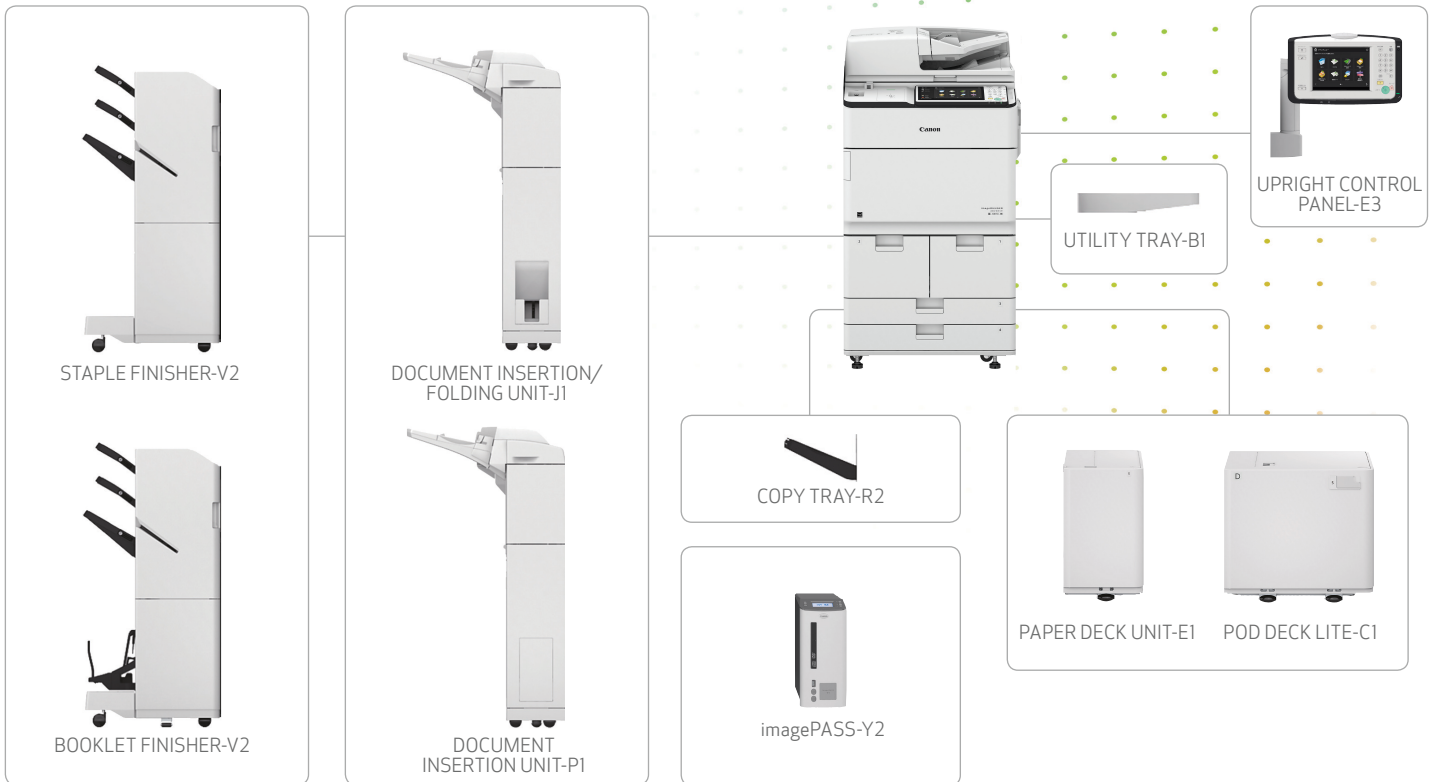

Main Unit

Type
Monochrome Laser Multifunctional

Core Functions
Standard: Print, Copy, Scan, Send, Store
Optional: Fax

Processor
Canon Dual Custom Processor (Shared)

Control Panel
Standard: 10.1" TFT LCD WSVGA Color Flat-panel
Optional: 10.4" TFT LCD SVGA Color Upright-panel

Memory
3.0 GB RAM

Hard Disk Drive
Standard: 250 GB
Maximum: 1 TB

Mirroring Hard Disk Drive
Optional (250 GB, 1 TB), Method: Raid1

Interface Connection

Network 1000Base-T/100Base-TX/10Base-T,
Wireless LAN (IEEE 802.11 b/g/n)

Others
Standard: USB 2.0 x2 (Host), USB 3.0 x1 (Host),
USB 2.0 x1 (Device)
Optional: Serial Interface, Copy Control Interface

Paper Capacity (LTR, 20 lb. Bond)

Standard: 4,200 Sheets
Maximum: 7,700 Sheets

Paper Sources (LTR, 20 lb. Bond)

Standard: Dual 1,500-sheet Paper Drawers, Dual
550-sheet Paper Cassettes, 100-sheet
Stack Bypass
Optional: 3,500-sheet Paper Deck
(POD DECK LITE-C1 or
PAPER DECK UNIT-E1)

Paper Output Capacity (LTR, 20 lb. Bond)

With Copy Tray: 250 Sheets
With External 3,500 Sheets
Finishers:

Finishing Capabilities

With External Collate, Group, Offset, Staple, Staple
Finishers: On Demand, Staple-free Staple, Booklet,
Hole Punch, Document Insertion, C and Z
Folding

Supported Media Types

Paper Drawers (1/2): Thin, Plain, Recycled, Color, Heavy,
Pre-punched, Letterhead, Bond
Paper Cassettes (3/4): Thin, Plain, Recycled, Color, Heavy,
Pre-punched, Letterhead, Bond, Tab.
Stack Bypass: Thin, Plain, Recycled, Color, Heavy,
Pre-punched, Bond, Transparency, Labels,
Letterhead, Tab, Tracing!
POD DECK LITE-C1: Thin, Plain, Recycled, Color, Heavy, Pre-
punched, Letterhead, Bond, Transparency,
Labels, Tab
PAPER DECK UNIT-E1: Thin, Plain, Recycled, Color, Heavy,
Pre-punched, Letterhead, Bond

Supported Media Sizes

Paper Drawers (1/2):	Letter
Paper Cassettes (3/4):	11" x 17", Legal, Letter, Letter-R, Executive, Statement-R, Custom Size (5-1/2" x 7-1/8" to 11-3/4" x 17")
Stack Bypass:	11" x 17", Legal, Letter, Letter-R, Executive, Statement-R, Custom Size (4" x 5-7/8" to 11-3/4" x 17"), Free Size (4" x 7-1/4" to 11-3/4" x 17")
POD DECK LITE-Ci:	11" x 17", Legal, Letter, Letter-R, Executive, Statement-R, Custom Size (5-1/2" x 7-1/8" to 11-3/4" x 17")

PAPER DECK UNIT-EI:	Letter
---------------------	--------

Supported Media Weights

Paper Decks/ Cassettes:	14 lb. Bond to 80 lb. Cover (52 to 220 g/m ²)
Stack Bypass:	14 lb. Bond to 140 lb. Index (52 to 256 g/m ²)
Duplexing:	14 lb. Bond to 80 lb. Cover (52 to 220 g/m ²)

Warm-up Time²

From Power On:	30 Seconds
From Sleep Mode:	30 Seconds

Dimensions (W x D x H)

26-3/8" x 30-5/8" x 48"
(670 mm x 779 mm x 1220 mm)

Installation Space (W x D)

Basic:	Stack Bypass Extended+ Cassette Drawers open + Copy Tray: 60-3/8" x 53-1/4" (1533 mm x 1353 mm)
Fully Configured:	Booklet finisher + Paper Deck + Insertion and Folding Unit + Puncher Unit + Cassette Drawers open: 94-3/4" x 53-1/4" (2407 mm x 1353 mm)

Weight

Approx. 515.9 lb. (234 kg)³

Print Specifications

Print Speed

6575i II:	Up to 75 ppm (Letter) Up to 58 ppm (Letter-R) Up to 45 ppm (Legal) Up to 37 ppm (11" x 17")
6565i II:	Up to 65 ppm (Letter) Up to 50 ppm (Letter-R) Up to 39 ppm (Legal) Up to 32 ppm (11" x 17")
6555i II:	Up to 55 ppm (Letter) Up to 43 ppm (Letter-R) Up to 39 ppm (Legal) Up to 32 ppm (11" x 17")

Print Resolution

1200 dpi x 1200 dpi, 600 dpi x 600 dpi

Standard Page Description Languages

UFR II, PCL[®]6, Adobe[®] PS[®] 3

Direct Print

Available from USB, Advanced Box, Remote UI, and Web Access⁴

Supported File Types

PDF, TIFF, JPEG, EPS,⁵ XPS

Printing from Mobile and Cloud

A range of software and MEAP-based solutions are available to provide printing from mobile devices or Internet-connected devices and cloud-based services depending on your requirements.

Fonts

PCL fonts:	93 Roman, 10 Bitmap fonts, 2 OCR fonts, Andalé Mono WT J/K/S/T (Japanese, Korean, Simplified and Traditional Chinese) ⁶
PS fonts:	136 Roman

Operating System⁷

UFR II:	Server 2008/Windows 7/Server 2008 R2/Server 2012/Windows 8.1/Server 2012 R2/Windows 10/Server 2016, MAC OS X (10.7 or later)
PCL:	Server 2008/Windows 7/Server 2008 R2/Server 2012/Windows 8.1/Server 2012 R2/Windows 10/Server 2016
PS:	Server 2008/Windows 7/Server 2008 R2/Server 2012/Windows 8.1/Server 2012 R2/Windows 10/Server 2016, MAC OS X (10.7 or later)

Print Features

Suspend Job Timeout, Subset Finishing (PS only), Profile Settings, Secured Print, Watermark, Page Border, Header/Footer, Page Layout, Two-sided Printing, Collating, Booklet Printing, Grouping, Mixed Paper Sizes/Orientations, Offsetting, Printing on Transparencies, Front/Back Covers, Toner Reduction, Poster Printing

Copy Specifications

Copy Speed

6575i II:	Up to 75 ppm (Letter) Up to 58 ppm (Letter-R) Up to 45 ppm (Legal) Up to 37 ppm (11" x 17")
6565i II:	Up to 65 ppm (Letter) Up to 50 ppm (Letter-R) Up to 39 ppm (Legal) Up to 32 ppm (11" x 17")
6555i II:	Up to 55 ppm (Letter) Up to 43 ppm (Letter-R) Up to 39 ppm (Legal) Up to 32 ppm (11" x 17")

First-Copy-Out Time (Letter)

6555i II:	As fast as 3.3 seconds
6565i II:	As fast as 3.3 seconds
6575i II:	As fast as 3.1 seconds

Copy Resolution (dpi)

Reading:	600 x 600
Printing:	1200 x 1200

Multiple Copies

Up to 9,999 Copies

Copy Exposure

Automatic or Manual (9 Levels)

Magnification

25%-400% (1% Increments)

Preset Reductions

25%, 50%, 64%, 73%, 78%

Preset Enlargements

121%, 129%, 200%, 400%

Basic Copy Features

Preset Reduction/Enlargement Ratios by Area, Paper Setting, Previous Settings, Favorite Settings, Finishing, Two-Sided, Density Adjustment, Original Type Selection, Interrupt Mode, Setting Confirmation/Cancel

Special Copy Features

Book to Two Pages, Two-sided Original, Finishing, Booklet, Job Build, N on 1, Add Cover, Insert Sheets, Different Size Originals, Density Adjustment, Original Type Selection, Transparency Cover Sheets, Page Numbering, Copy Set Numbering, Sharpness, Erase Frame, Secure Watermark, Print Date, Shift, Gutter, Print & Check, Negative/Positive, Repeat Images, Merge Job Blocks, Job Done Notice, Mirror Image, Print on Tab, Store in Mail Box, Superimpose Image, Cascade Copy, Copy ID Card, Detect Feeder Multi Sheet Feed, Free Size Original

Scan Specifications

Type

Color Platen and Single-pass Duplexing Automatic Document Feeder

Document Feeder Paper Capacity

300 Sheets (20 lb. Bond)

Document Feeder Supported Media Sizes

11" x 17", Legal, Letter, Letter-R, Statement, Statement-R

Document Feeder Supported Media Weights

BW Original:	13 lb. Bond to 80 lb. Cover (50 to 220 g/m ²)
CL Original:	17 lb. Bond to 80 lb. Cover (64 to 220 g/m ²)

Platen Acceptable Originals

Sheet, Book, 3-Dimensional Objects [Up to 4.4 lb. (2 kg)]

Pull Scan

Color Network ScanGear2 for both Twain and WIA
Supported OS: Windows Vista/7/8.1/10
Server 2008/Server 2008 R2/Server 2012/Server 2012 R2/Server 2016

Scan Resolution (dpi)

600 x 600, 400 x 400, 300 x 300, 200 x 400, 200 x 200, 200 x 100, 150 x 150, 100 x 100

Scan to Mobile Devices and Cloud-based Services

A range of solutions is available to provide scanning to mobile devices and cloud-based services depending on your requirements.

Scan Speed (Letter)

Single-sided Scanning
BW: 120 ipm (300 dpi)/120 ipm (600 dpi)
Color: 120 ipm (300 dpi)/60 ipm (600 dpi)

Double-sided Scanning
BW: 240 ipm (300 dpi)/150 ipm (600 dpi)
Color: 220 ipm (300 dpi)/60 ipm (600 dpi)

Send Specifications

Destination

E-mail/Internet Fax (SMTP), SMB, FTP, WebDAV, Mail Box, Super G3 Fax (Optional), IP Fax (Optional)

Color Mode

Automatic-Color Select (Full Color/Grayscale), Automatic-Color Select (Full Color/Black-and-White), Full color, Grayscale, and Black-and-White

Address Book

LDAP (2,000)/Local (1,600)/Speed dial (200)

Send Resolution (dpi)

600 x 600, 400 x 400, 300 x 300, 200 x 400, 200 x 200, 200 x 100, 150 x 150, 100 x 100

Communication Protocol

File:	FTP, SMB v3.0, WebDAV
E-mail/I-Fax:	SMTP, POP3, I-Fax (Simple, Full)

File Format

Standard:	TIFF, JPEG, PDF (Encrypted, Compact, Searchable, Apply Policy, Optimize for Web, PDF A/1-b), XPS (Compact, Searchable), Office Open XML (PowerPoint, Word), Digital Signature (PDF/XPS)
Optional:	PDF (Trace & Smooth)

Universal Send Features

Original Type Selection, Two-sided Original, Book to Two Pages, Different-size Originals, Density Adjustment, Sharpness, Copy Ratio, Erase Frame, Job Build, Sender's Name (TTI), Select Line, Direct Send, Delayed Send, Preview, Finished Stamp, Job Done Notice, File Name, Subject/Message, Reply-to, E-mail Priority, TX Report, Original Content Orientation, Skip Blank Originals, Multi Sheet Feed Detection

Fax Specifications

Maximum Number of Connection Lines

4

Modem Speed

Super G3: 33.6 Kbps

G3: 14.4 Kbps

Compression Method

MH, MR, MMR, JBIG

Resolution (dpi)

400 x 400, 200 x 400, 200 x 200, 200 x 100

Sending/Recording Size

Statement-R to 11" x 17"

Fax Memory

Up to 30,000 Pages

Speed Dials

Max. 200

Group Dials/Destinations

Max. 199 Dials

Sequential Broadcast

Max. 256 Addresses

Memory Backup

Yes

Fax Features

Original Type Selection, Two-sided Original, Book to Two Pages, Different-size Originals, Density for Scanning, Sharpness, Copy Ratio, Erase Frame, Job Build, Specifying the Sender's Name (when sending fax), Sender's Name (TTI), Selecting the Telephone Line (when sending fax), Direct Send, Delayed Send, Preview, Finished Stamp, Job Done Notice, TX Report, Multi Sheet Feed Detection

Store Specifications

Mail Box (Number Supported)

100 User In-boxes, 1 Memory RX In-box, 50 Confidential Fax In-boxes, 30,000 Maximum Pages Stored

Advanced Box

Communication Protocol: SMB or WebDAV

Supported Windows (Windows Vista/7/8/8.1/10)

Client PC:

Concurrent Connections (Max.):

SMB: 64

WebDAV: 3 (Active Sessions)

Advanced Box Available Disc Space

Approx. 16 GB (Standard HDD)

Approx. 480 GB (1 TB HDD)

Advanced Box Features

Disabling Advanced Box, Storage Filtering, Authentication for Advanced Box Log-in, Search Function, Sort Function, Printing a PDF File with a Password, imageWARE Secure Audit Manager Support

Memory Media

Standard: USB

Security Specifications

Authentication

Standard: Universal Login Manager, uniFLOW Online Express,^{8,9} User Authentication, Department ID Authentication, (Device and Function Level Log-in), Access Management System

Optional: uniFLOW

Data

Standard: Trusted Platform Module (TPM), Hard Disk Password Lock, Hard Disk Drive Erase, Mail Box Password Protection, Hard Disk Drive Encryption(FIPS140-2 Validated)

Optional: Hard Disk Drive Mirroring, Hard Disk Drive removal, IEEE 2600.2 Common Criteria Certification, Data Loss Prevention (Requires uniFLOW)

Network

Standard: Encrypted Secure Print, IP/Mac Address Filtering, IPsec, TLS Encrypted Communication, SNMP V3.0, IEEE 802.1X, IPv6, SMTP Authentication, POP Authentication before SMTP

Document

Standard: Secure Watermark, Secure Print, Adobe LiveCycle® Rights Management ES2.5 Integration, Encrypted PDF, Encrypted Secure Print, Device Signature

Optional: User Signature, Document Scan Locking

Environmental Specifications

Operating Environment

Temperature: 50 to 86 °F

Humidity: 20 to 80 % RH (no condensation)

Power Requirements

120-127 V AC, 60 Hz, 16 A

Plug (Main Unit)

NEMA 5-20P

Power Consumption

Maximum: Approx. 2.1 kW

Standby: Approx. 238 Wh

Energy Saver

Mode: Approx. 192 Wh

Sleep mode: Approx. 0.9 W or less¹⁰

Typical Electricity Consumption (TEC) Rating:

iR ADV 6575i II: 6.3 kWh

iR ADV 6565i II: 5.8 kWh

iR ADV 6555i II: 5.2 kWh

Standards

ENERGY STAR® Certified

Rated EPEAT® Gold¹¹

EU RoHS Compliant

Ecomark

Blue Angel

Consumables

Toner

GPR-38 Black Toner

Toner Yield (Estimated @ 6% Coverage)

56,000 Images

Fiery Print Controller Specifications (Optional)

Name

imagePASS-Y2 (External)

System

Fiery FS150Pro

Print Resolution

1200 dpi x 1200 dpi, 600 dpi x 600 dpi

Standard Page Description Languages

PCL, Adobe PS 3, APPE

Memory

4 GB

Hard Disk Drive

500 GB

Processor

Intel Celeron G1820 2.7 GHz

Fonts

PS: 138 Adobe PS Fonts

PCL: 113 PCL Fonts

Supported Operating Systems

Windows VISTA 32 and

64 bit/Windows 8 32 and 64 bit/Windows 8.1 32 and 64 bit/

Windows 7 32 and 64 bit/Windows Server 2008 32 and 64

bit/Windows Server 2008 R2 64 bit only/Windows Server

2012 64 bit only/Windows Server 2012 R2 64bit only/

Windows 10 32 bit and 64 bit/Windows Server 2016 64 bit

only, MAC OS (10.7 or higher)

Interface

2 x Ethernet (1000Base-T/100Base-TX/10Base-T),

USB x 7 (Front x 1: USB 2.0, Rear x 6: USB 2.0 x 4, USB 3.0 x 2)

Network Protocols

TCP/IP (LPD/Port 9100/IPP/SMB/FTP)/

Direct mobile printing/PrintMe cloud printing

Fiery Print Controller Features

Hot Folders, Secure Erase, Paper Catalog Kit,

VDP-A1 Kit, Virtual Printer

Fiery Print Controller Options

FIERY IMPOSE, FIERY COMPOSE, FIERY IMPOSE AND

COMPOSE, Removable Hard Disk Drive, Integration Interface

and Stand (19" display, keyboard, mouse,

and furniture stand), Fiery ImageViewer

Dimensions (W x D x H)

9-1/4" x 20-7/8" x 18-1/4" (233 mm x 530 mm x 464 mm)

Paper Supply Options

PAPER DECK UNIT-E1

Paper	3,500 Sheets [20 lb. Bond (80 g/m ²)]
Capacity:	
Paper Size:	Letter
Paper Weight:	14 lb. Bond to 140 lb. Index (52 to 256 g/m ²)
Power Source:	From the Main Unit
Dimensions (W x D x H):	14-1/4" x 24-7/8" x 22-1/2" (363 mm x 630 mm x 572 mm)
Weight:	Approx. 75.0 lb. (34 kg)

POD DECK LITE-C1

Paper	3,500 Sheets [20 lb. Bond (80 g/m ²)]
Capacity:	
Paper Size:	11"x17", Legal, Letter, Letter-R, Executive, Statement-R, and Custom Size (5-1/2" x 7-1/8" to 11-3/4" x 17")
Paper Weight:	14 lb. Bond to 140 lb. Index (52 to 256 g/m ²)
Power Source:	120-127 V AC, 60 Hz, 2.2 A
Dimensions (W x D x H):	25-7/8" x 27" x 22-1/2" (656 mm x 686 mm x 570 mm)
Weight:	Approx. 149.9 lb. (68 kg)

Output Options

STAPLE FINISHER-V2

Number of Trays:	3
Tray A (Upper) Capacity:	Letter/Executive/Statement-R 250 Sheets 11" x 17"/Legal/Letter-R 125 Sheets
Tray B (Middle) Capacity:	Letter/Executive/Statement-R 250 Sheets 11" x 17"/Legal/Letter-R 125 Sheets
Tray C (Lower) Capacity:	Letter/Letter-R/Executive/Statement-R 3,000 Sheets 11" x 17" 1,500 Sheets
Acceptable Paper Weight:	14 lb. Bond to 140 lb. Index (52 to 256 g/m ²)
Staple Position:	Corner, Double
Staple Capacity:	
Corner Staple and Double Staple:	
Letter/ Executive:	65 Sheets [24 lb. Bond (90 g/m ²)]
11" x 17"/ Legal/ Letter-R:	30 Sheets [24 lb. Bond (90 g/m ²)]
Staple-Free Staple:	
11"x17"/ Letter:	5 Sheets [14 to 17 lb. Bond (52 to 64 g/m ²)] 4 Sheets [17.3 to 21.7 lb. Bond (65 to 81.4 g/m ²)] 3 Sheets [21.7 to 28 lb. Bond (81.5 to 105 g/m ²)]
Staple On Demand:	65 sheets [24 lb. Bond (90 g/m ²)]
Power Source:	From the Main Unit
Dimensions (W x D x H):	20-3/4" x 24-1/2" x 43-1/4" (527 mm x 623 mm x 1099 mm) ¹²
Weight:	Approx. 77.2 lb. (35 kg)

BOOKLET FINISHER-V2

Number of Trays:	3
Tray A (Upper) Capacity:	Letter/Executive/Statement-R 250 Sheets 11" x 17"/Legal/Letter-R 125 Sheets
Tray B (Middle) Capacity:	Letter/Executive/Statement-R 250 Sheets 11" x 17"/Legal/Letter-R 125 Sheets
Tray C (Lower) Capacity:	Letter/Executive/Statement-R 3,000 Sheets 11" x 17" 1,500 Sheets
Acceptable Paper Weight:	14 lb. Bond to 140 lb. Index (52 to 256 g/m ²)
Staple Position:	Corner, Double

Staple Capacity:

Corner Staple and Double Staple:	
Letter/ Executive:	65 Sheets [24 lb. Bond (90 g/m ²)]
11" x 17"/ Legal/ Letter-R:	30 Sheets [24 lb. Bond (90 g/m ²)]
Staple-Free Staple:	
11"x17"/ Letter:	5 Sheets [14 to 17 lb. Bond (52 to 64 g/m ²)] 4 Sheets [17.3 to 21.7 lb. Bond (65 to 81.4 g/m ²)] 3 Sheets [21.7 to 28 lb. Bond (81.5 to 105 g/m ²)] 65 Sheets [24 lb. Bond (90 g/m ²)]
Staple On Demand:	
Saddle-Stitch Paper Size:	11" x 17", Legal, Letter-R, Custom Size 7-3/4" x 10-5/8" to 11-3/4" x 17"
Paper Capacity of Saddle- Stitch Mode:	20 Sheets [22 lb. Bond (81 g/m ²)] [including 1 cover Sheet up to 140 lb. Index (256 g/m ²)]
Power Source:	From the Main Unit
Dimensions (W x D x H):	20-3/4" x 24-1/2" x 43-1/4" (527 mm x 623 mm x 1099 mm) ¹²
Weight:	Approx. 127.9 lb. (58 kg)

2/3 HOLE PUNCHER-A1¹³

Acceptable Punch Paper Weight:	14 lb. Bond to 140 lb. Index (52 to 256 g/m ²)
Acceptable Punch Paper Size:	Two holes 11" x 17", Legal, Letter, Letter-R, Executive Three holes 11" x 17", Letter, Executive
Power Source:	From the Main Unit

COPY TRAY-RI:

Capacity:	250 Sheets [20 lb. Bond (80 g/m ²)]
Acceptable Paper Weight:	14 lb. Bond to 140 lb. Index (52 to 256 g/m ²)
Dimensions (W x D x H):	16-1/2" x 15" x 6-7/8" (420 mm x 382 mm x 175 mm)
Weight:	Approx. 2.4 lb. (1.1 kg)

DOCUMENT INSERTION UNIT-P1¹³

Number of Insertion Trays:	1 Tray
Acceptable Insertion Paper Size:	11" x 17", Legal, Letter, Letter-R, Executive
Acceptable Insertion Paper Weight:	16 lb. Bond to 140 lb. Index (60 to 256 g/m ²)
Insertion Capacity:	100 Sheets [20 lb. Bond (80 g/m ²)]
Power Source:	100-240 V AC, 50/60 Hz, 1.0 A
Dimensions (W x D x H):	26-1/8" x 26-3/4" x 48-7/8" (662 mm x 679 mm x 1242 mm)
Weight:	Approx. 88.2 lb. (40 kg)

DOCUMENT INSERTION/FOLDING UNIT-J1¹³

Number of Insertion Trays:	1 Tray
Acceptable Insertion Paper Size:	11" x 17", Legal, Letter, Letter-R, Executive
Acceptable Insertion Paper Weight:	16 lb. Bond to 140 lb. Index (60 to 256 g/m ²)
Insertion Capacity:	100 Sheets [20 lb. Bond (80 g/m ²)]
Supported Fold Types:	C-Fold, Z-Fold
C-Fold Paper Size/ Weight:	Letter-R/ 16 to 28 lb. Bond (60 to 105 g/m ²)
C-Fold Output Capacity:	40 Sheets [20 lb. Bond (80 g/m ²)]
Z-Fold Paper Size/ Weight:	11" x 17", Legal, Letter-R/16 to 28 lb. Bond (60 to 105 g/m ²)
Z-Fold Output Capacity:	40 Sheets [21 lb. Bond (80 g/m ²)]
Power Source:	100-240 V AC, 50/60 Hz, 1.0 A
Dimensions (W x D x H):	26-1/8" x 26-3/4" x 48-7/8" (662 mm x 679 mm x 1242 mm)
Weight:	Approx. 168 lb. (76 kg)

Hardware Options

Card Readers

MiCARD PLUS PROXIMITY CARD READER
COPY CARD READER-F1
COPY CARD READER ATTACHMENT-A4

Others

PRINTER COVER-H1
TAB FEEDING ATTACHMENT KIT-B1
STAMP INK CARTRIDGE-C1
UPRIGHT CONTROL PANEL-E3
UTILITY TRAY-B1

Security Options

Document Security

DOCUMENT SCAN LOCK KIT-B1

Data Security

HDD MIRRORING KIT-J1
2.5INCH/250GB HDD-N1
2.5INCH/1TB HDD-P1
REMOVABLE HDD KIT-AL1

System and Controller Options

Print Accessories

PCL INTERNATIONAL FONT SET-A1

Barcode Printing

BARCODE PRINTING KIT-D1

EFI-Fiery Based Controller

imagePASS-Y2
REMOVABLE HARD DISK DRIVE KIT-B4
FIERY IMPOSE
FIERY COMPOSE
FIERY IMPOSE AND COMPOSE
FIERY IMAGE VIEWER

System Accessories

SERIAL INTERFACE KIT-K3
MEAP WEB CONNECTION KIT-G3 ¹⁴

Fax Accessories

SUPER G3 FAX BOARD-AS2
SUPER G3 2ND LINE FAX BOARD-AS2
SUPER G3 3RD/4TH LINE FAX BOARD-AS2
REMOTE FAX KIT-A1

Other Options

Accessibility Accessories

ADF ACCESS HANDLE-A1
VOICE GUIDANCE KIT-G1
VOICE OPERATION KIT-D1

Staples

STAPLE CARTRIDGE-X1 ¹⁵
STAPLE CARTRIDGE-Y1 ¹⁶

¹ Some types of tracing paper cannot be used.

² Warm-up time shown for when "Quick Startup Settings for Main Power" is set to "OFF". For significantly faster warm-up set "Quick Startup Settings for Main Power" to "ON".

³ Including the toner bottle.

⁴ PDF print from Websites is supported.

⁵ EPS can be printed directly only from the Remote User Interface.

⁶ Requires the optional PCL International Font Set-A1.

⁷ Other operating systems and environments including AS/400, UNIX, Linux and Citrix may be supported. Some of these solutions are chargeable. SAP Device Types are available via the SAP Market Place. For more information, contact your sales representative.

⁸ No charge for this solution; however activation is required.

⁹ Check for availability.

¹⁰ 0.9 W sleep mode not available in all circumstances due to certain settings.

¹¹ For current EPEAT rating (Gold/Silver/Bronze), please visit www.epeat.net.

¹² When the extension tray is not extended.

¹³ Requires either Staple Finisher-V2 or Booklet Finisher-V2.

¹⁴ No charge for this option; however it does need to be ordered.

¹⁵ Used for corner/double stapling only. 3 cartridges per case, 5,000 staples per cartridge.

¹⁶ Used for booklet finishing only, 2 cartridges per case, 2,000 staples per cartridge.

 USA.CANON.COM/SIMPLYADVANCED



As an ENERGY STAR® Partner, Canon U.S.A., Inc. has certified these models as meeting the ENERGY STAR energy efficiency criteria through an EPA recognized certification body. ENERGY STAR and the ENERGY STAR mark are registered U.S. marks. AirPrint and the AirPrint logo are trademarks of Apple Inc. Canon, imageRUNNER, imageWARE, imagePASS, and the GENUINE logo are registered trademarks or trademarks of Canon Inc. in the United States and may also be registered trademarks or trademarks in other countries. II indicates that this model has been upgraded to new system software and includes additional security features as standard. All other referenced product names and marks are trademarks of their respective owners. All printer output images are simulated. All features presented in this brochure may not apply to all Series and/or products and may be optional; please check with your Canon Authorized Dealer for details. Products shown with optional accessories. Canon U.S.A. does not provide legal counsel or regulatory compliance consultancy, including without limitation, Sarbanes-Oxley, HIPAA, GLBA, Check 21 or the USA Patriot Act. Each customer must have its own qualified counsel determine the advisability of a particular solution as it relates to regulatory and statutory compliance. Specifications and availability subject to change without notice. Not responsible for typographical errors.
©2018 Canon U.S.A., Inc. All rights reserved.

0218-iRA65xxIISS-PDF-SP

