



# Setting Up Your MX922 In Default Mode (Tel Priority Mode) With An Answering Machine



# Fax Easy Setup

Click [Next](#) to step through this image-friendly version of **Fax Easy Setup**.

---

If you started **Fax Easy Setup**, on the fax machine's operation panel, and prefer to go through this image-friendly version...

## Step 1

Press the **FAX** button at any screen to go to fax standby mode.

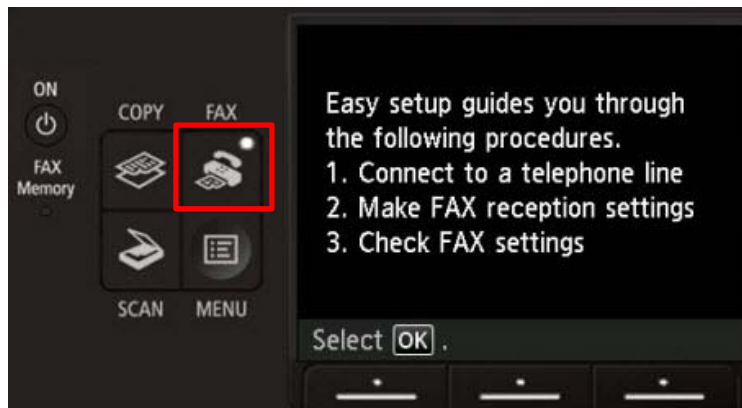

## Step 2

Click [Next](#) to proceed through the setup.

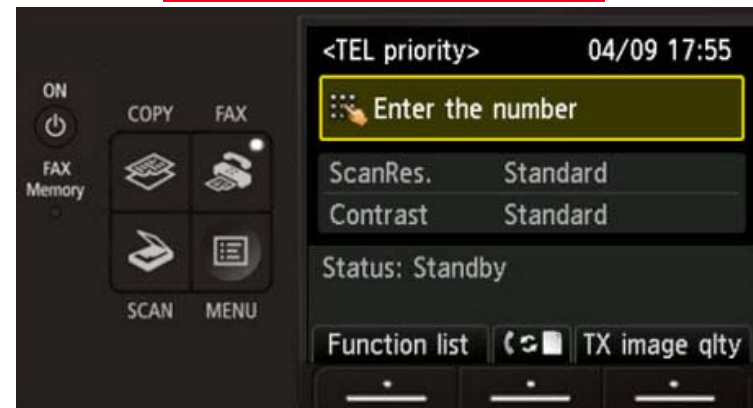



# Connecting The Phone Lines



# Connecting Your Phone/Answering Machine

Is your answering machine built into your phone?

**YES**

Click Here or Go To Page 13

**NO**

Click the Next Button



# Fax to Phone Line Connection

## Before

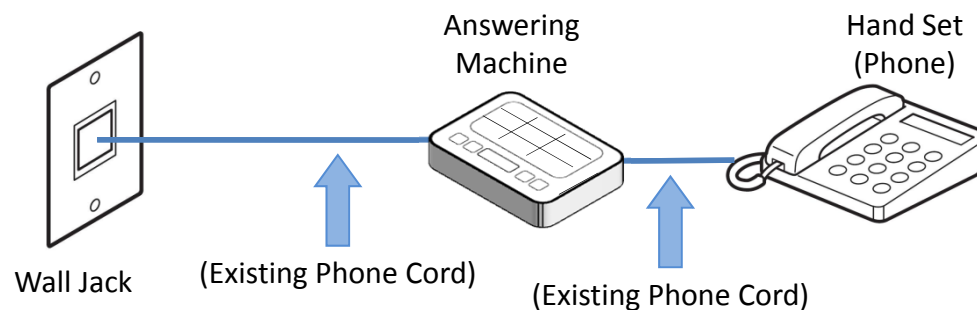

## After

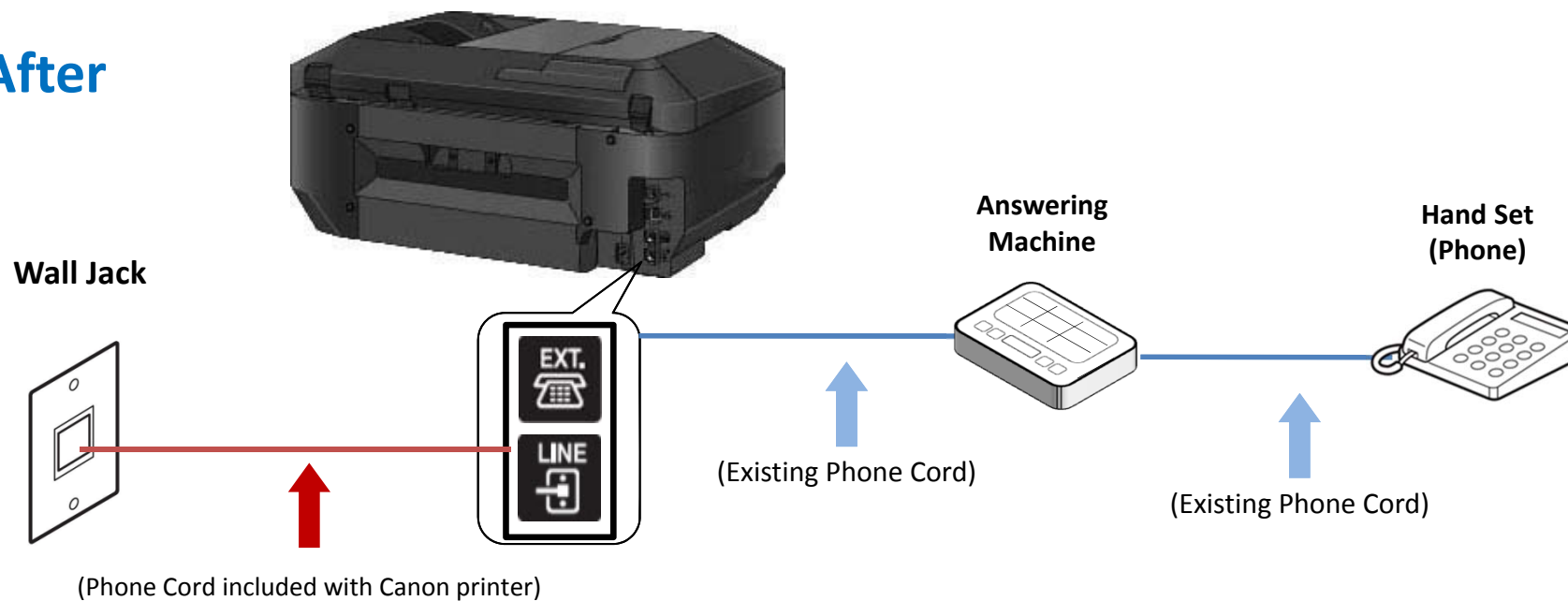

# Fax to Phone Line Connection

- Plug the provided phone cord into the wall jack

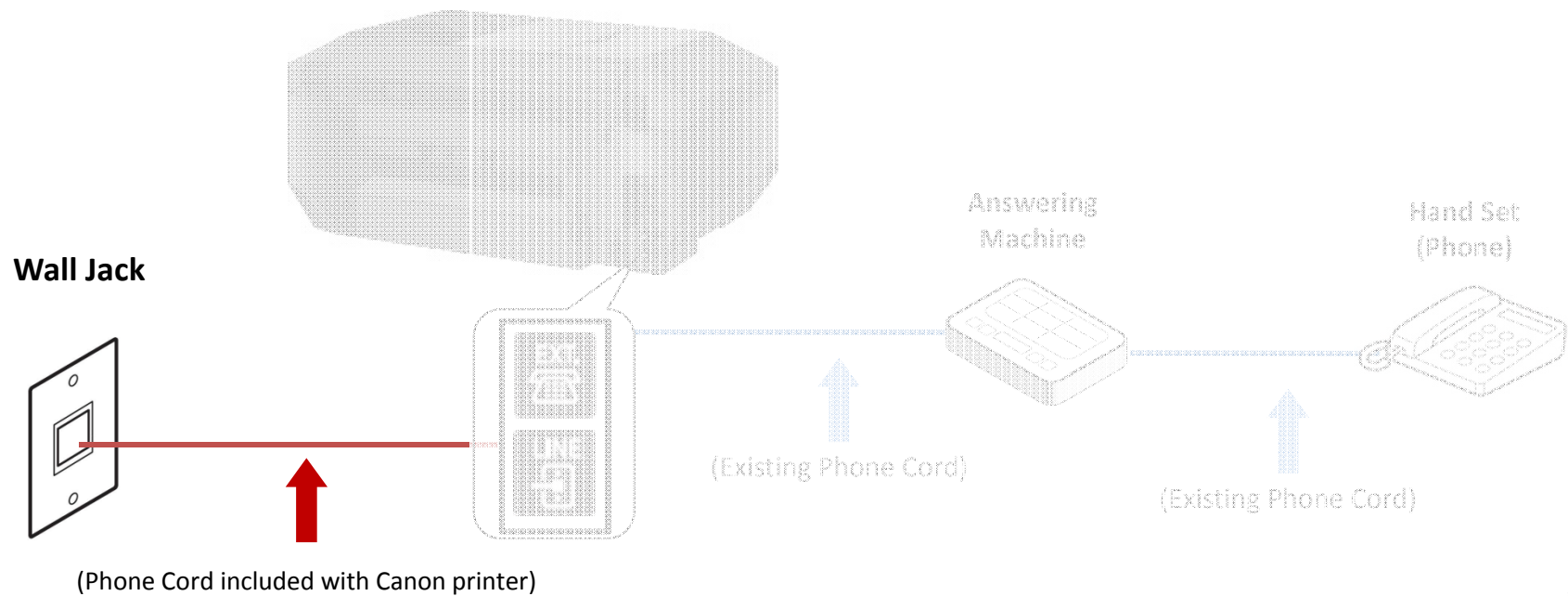

# Fax to Phone Line Connection

- Plug the provided phone cord into the “LINE” jack located on the rear of the multifunction.

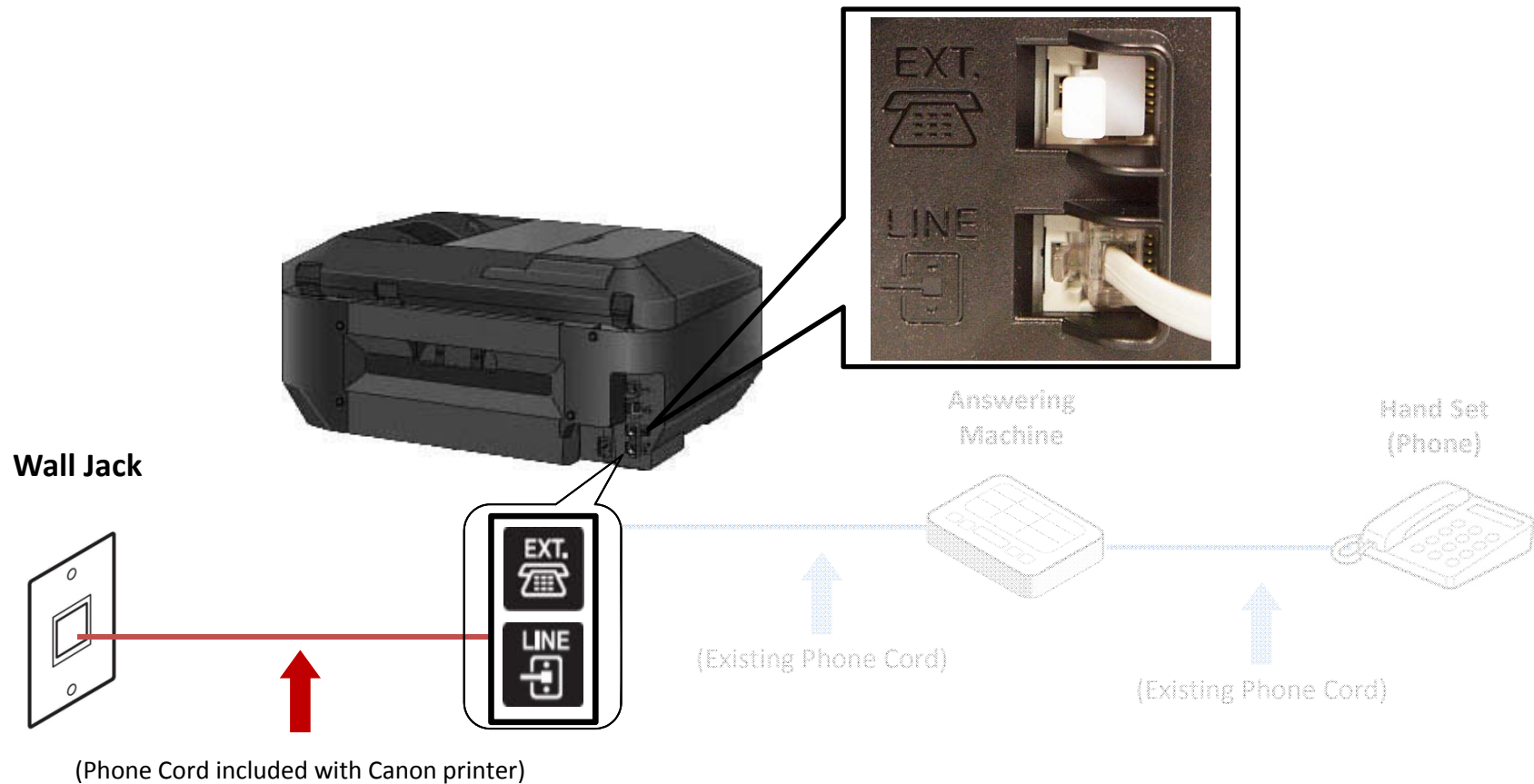

# Fax to Phone Line Connection

- Remove the white plug from the upper jack labeled "EXT."

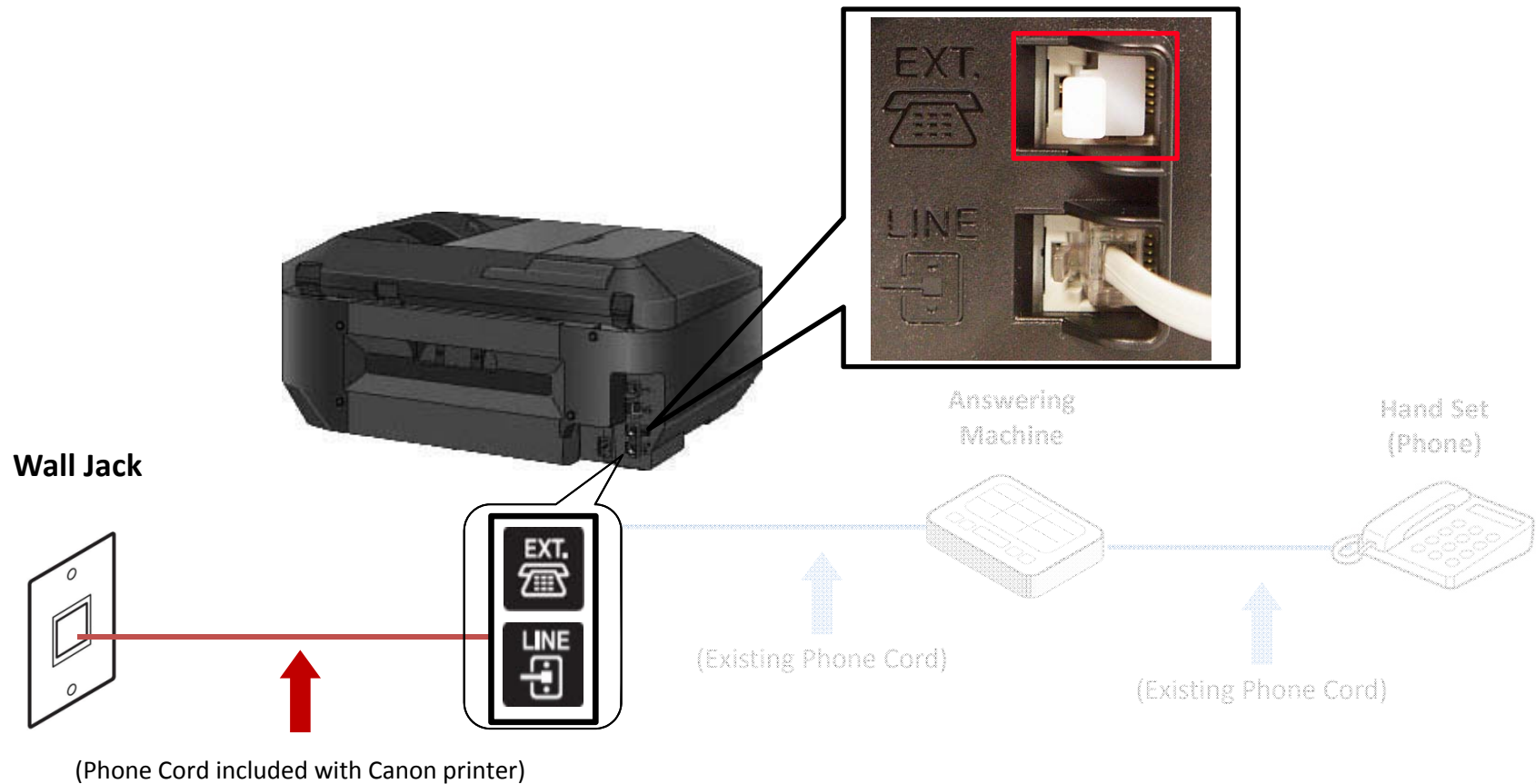



# Fax to Phone Line Connection

- Plug the second phone cord into the “EXT.” jack located on the rear of the multifunction

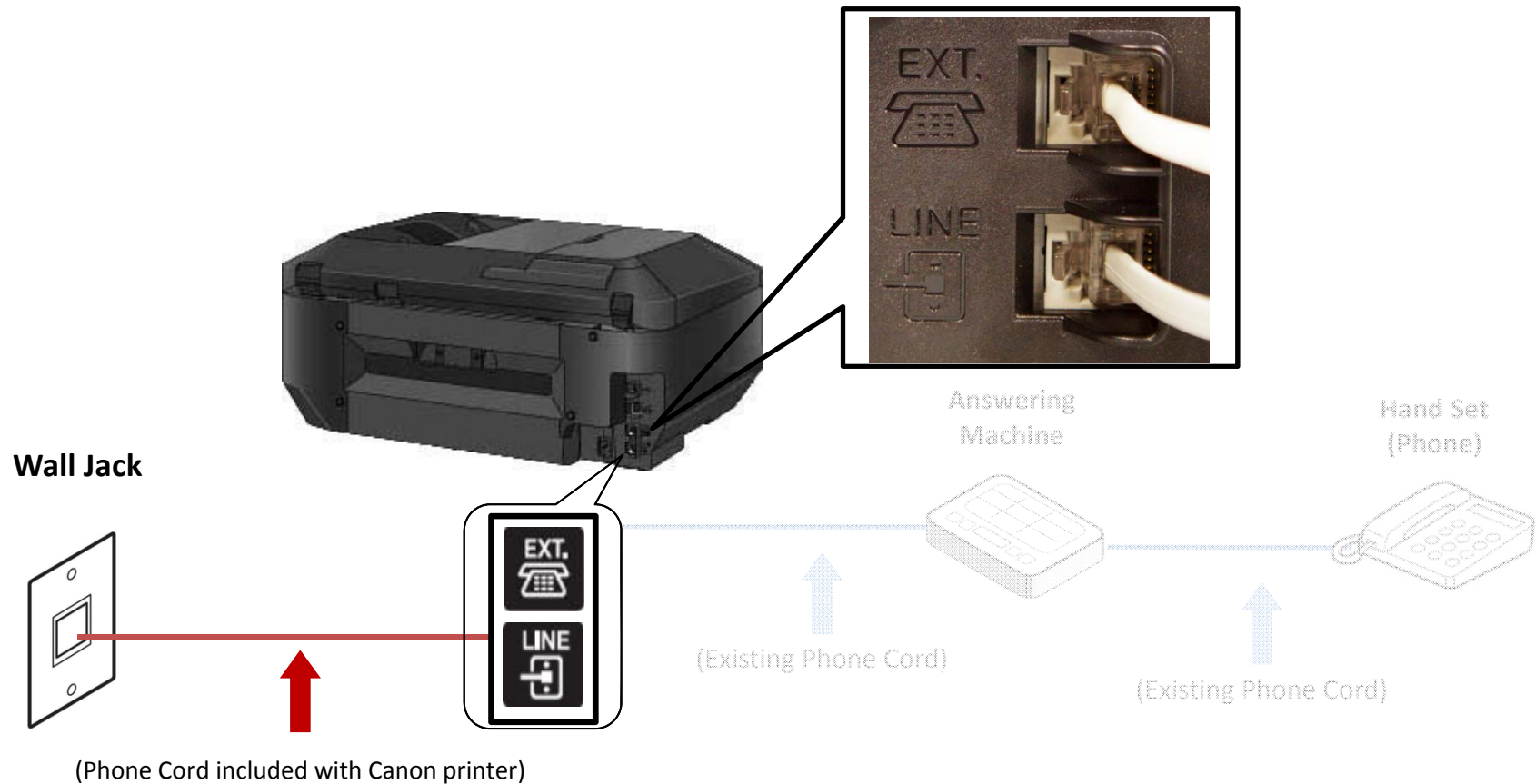

# Fax to Phone Line Connection

- Plug the second phone cord into the answering machine.

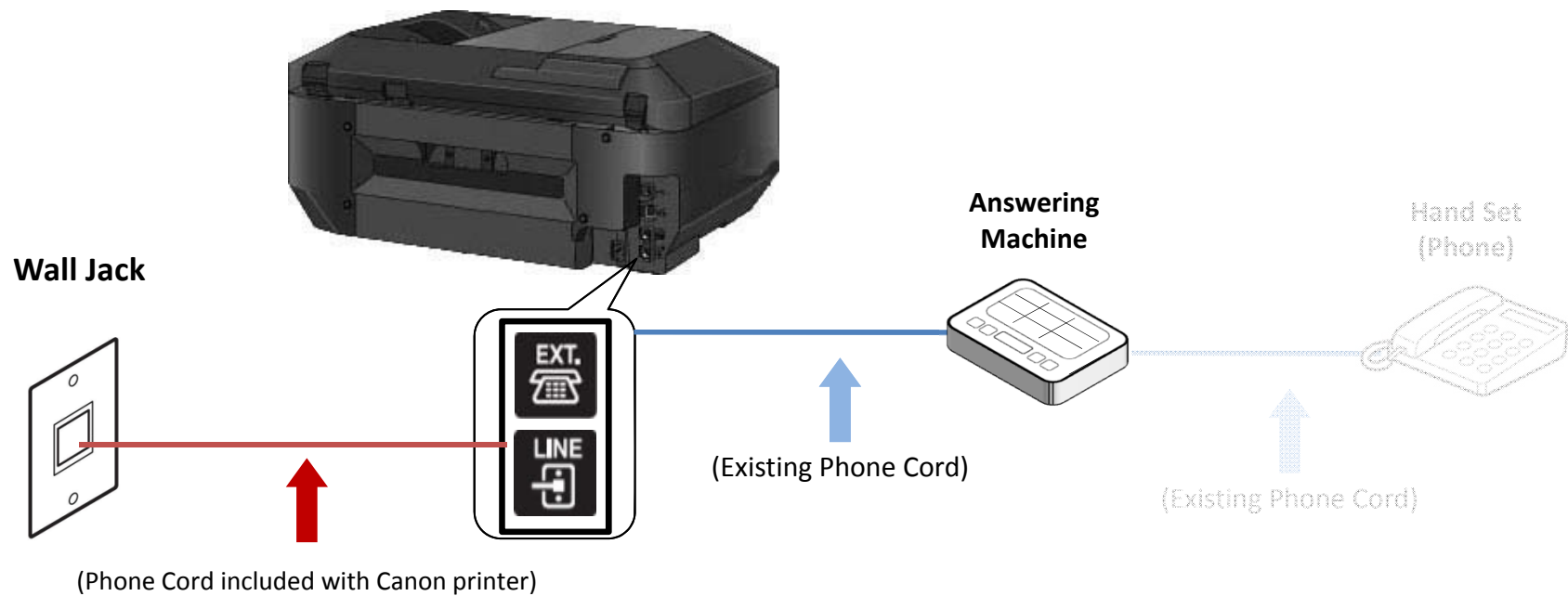

# Fax to Phone Line Connection

- Plug the third phone cord into the answering machine.

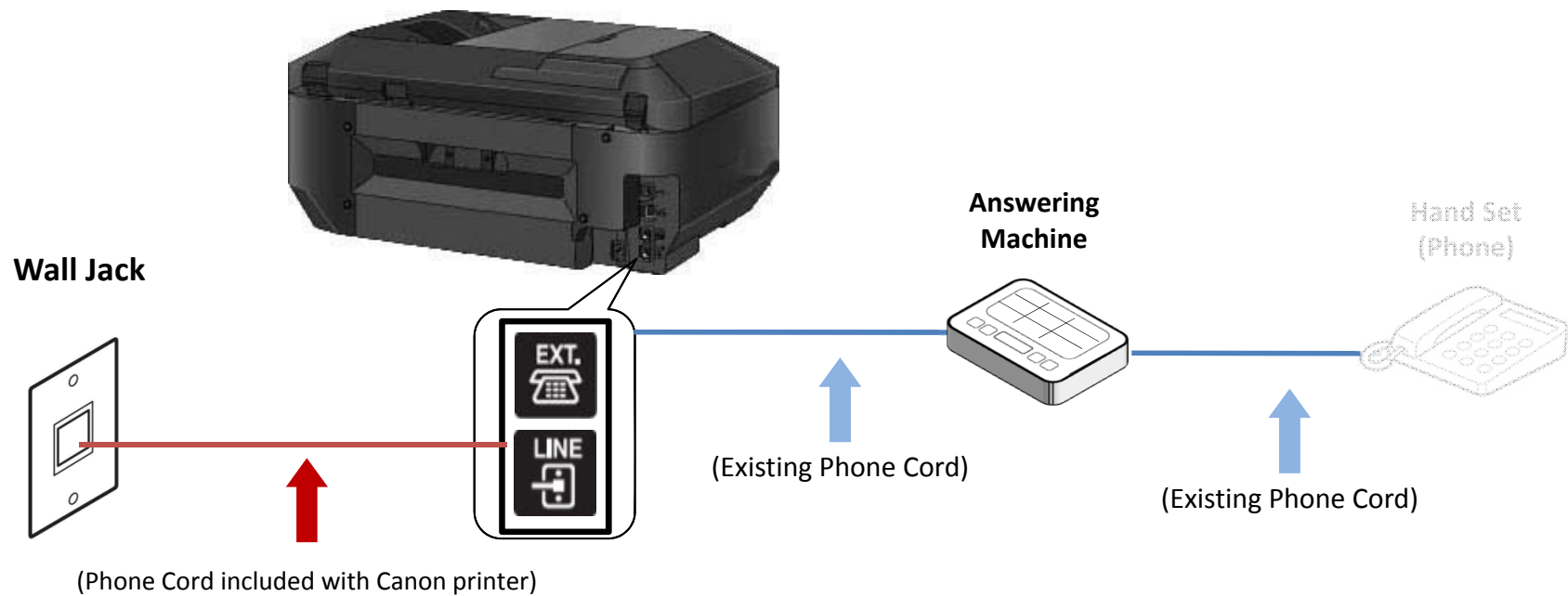

# Fax to Phone Line Connection

- Plug the third phone cord into the phone.

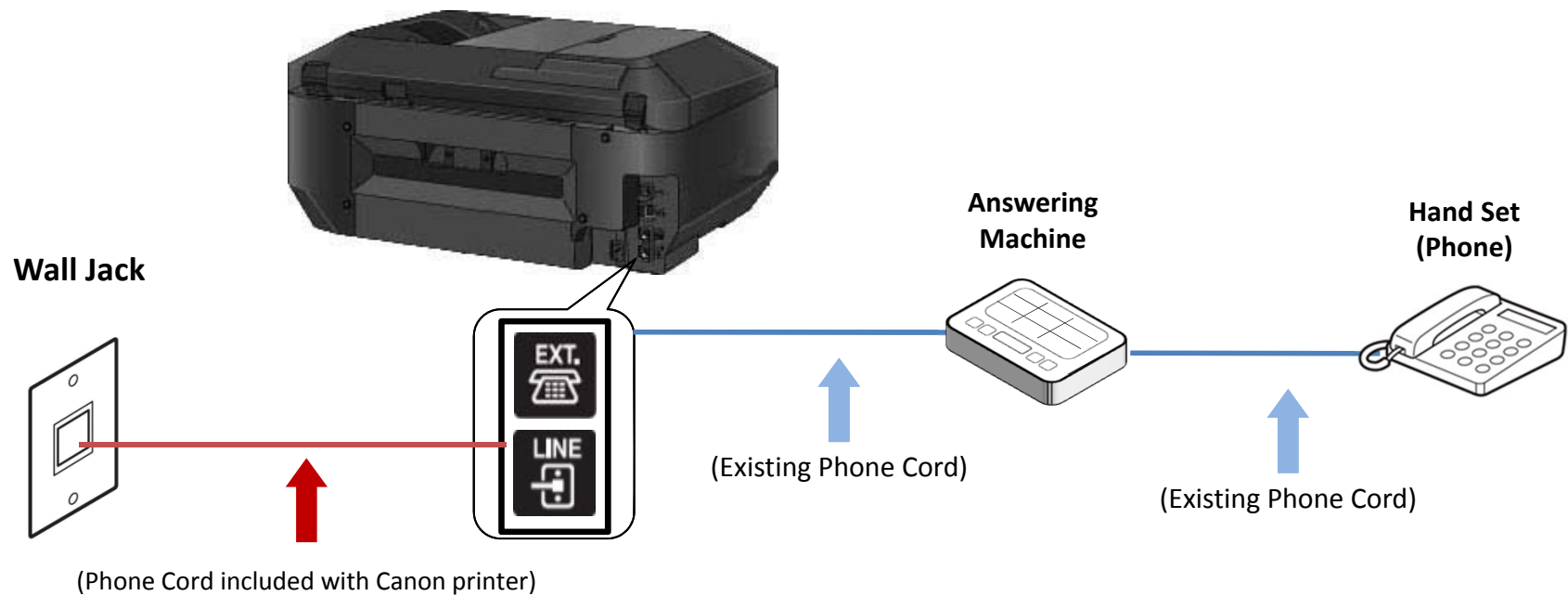

# Fax to Phone Line Connection

**Before**

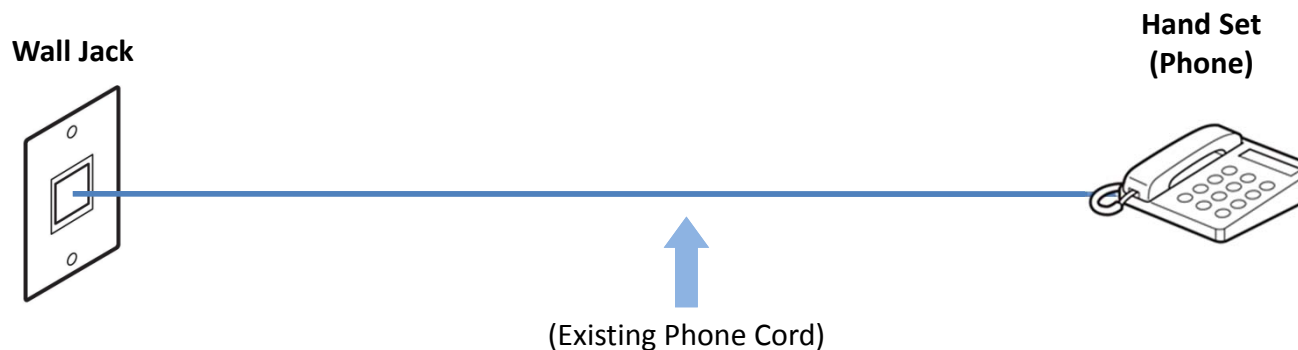

**After**

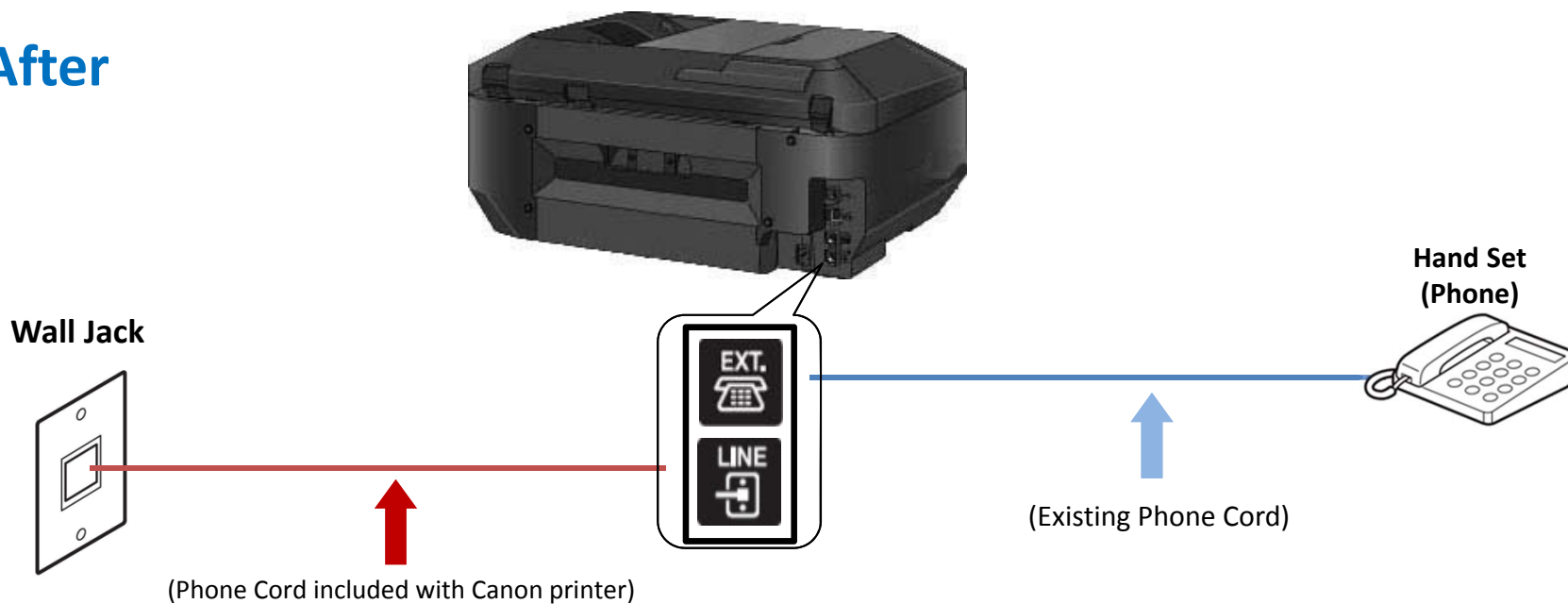

 **Previous**

**Next** 

# Fax to Phone Line Connection

- Plug the provided phone cord into the wall jack

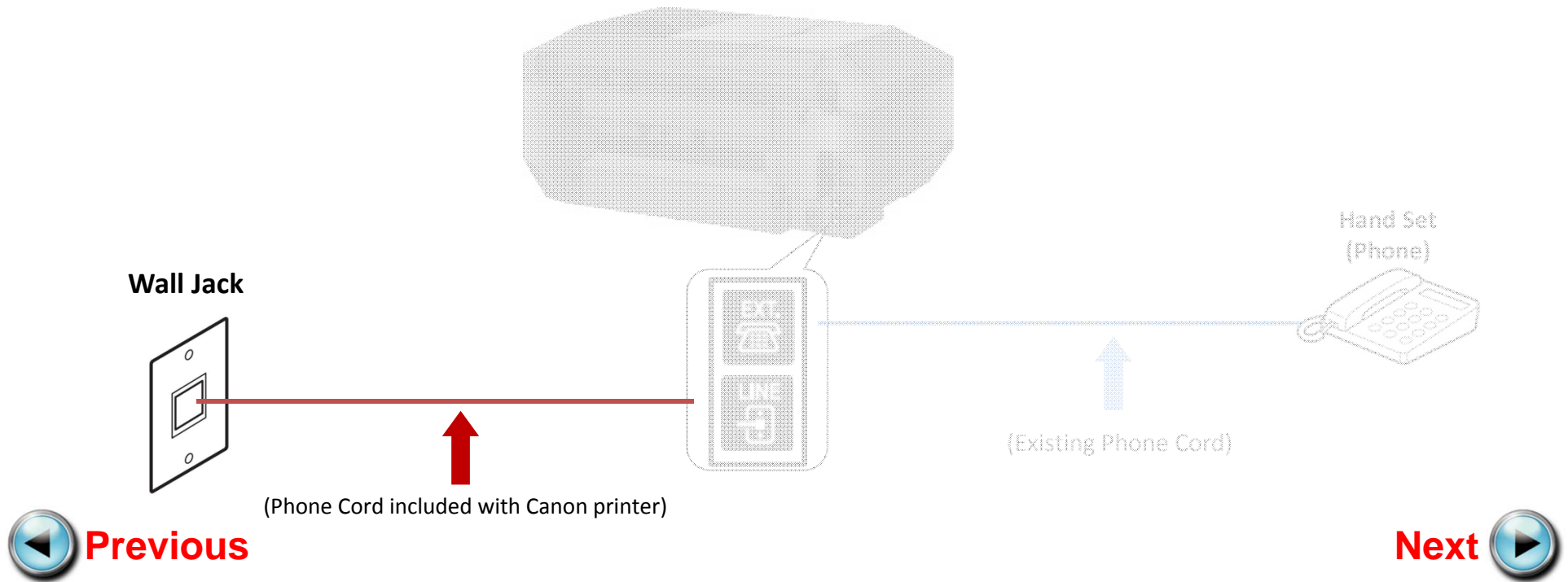

# Fax to Phone Line Connection

- Plug the provided phone cord into the “LINE” jack located on the rear of the multifunction

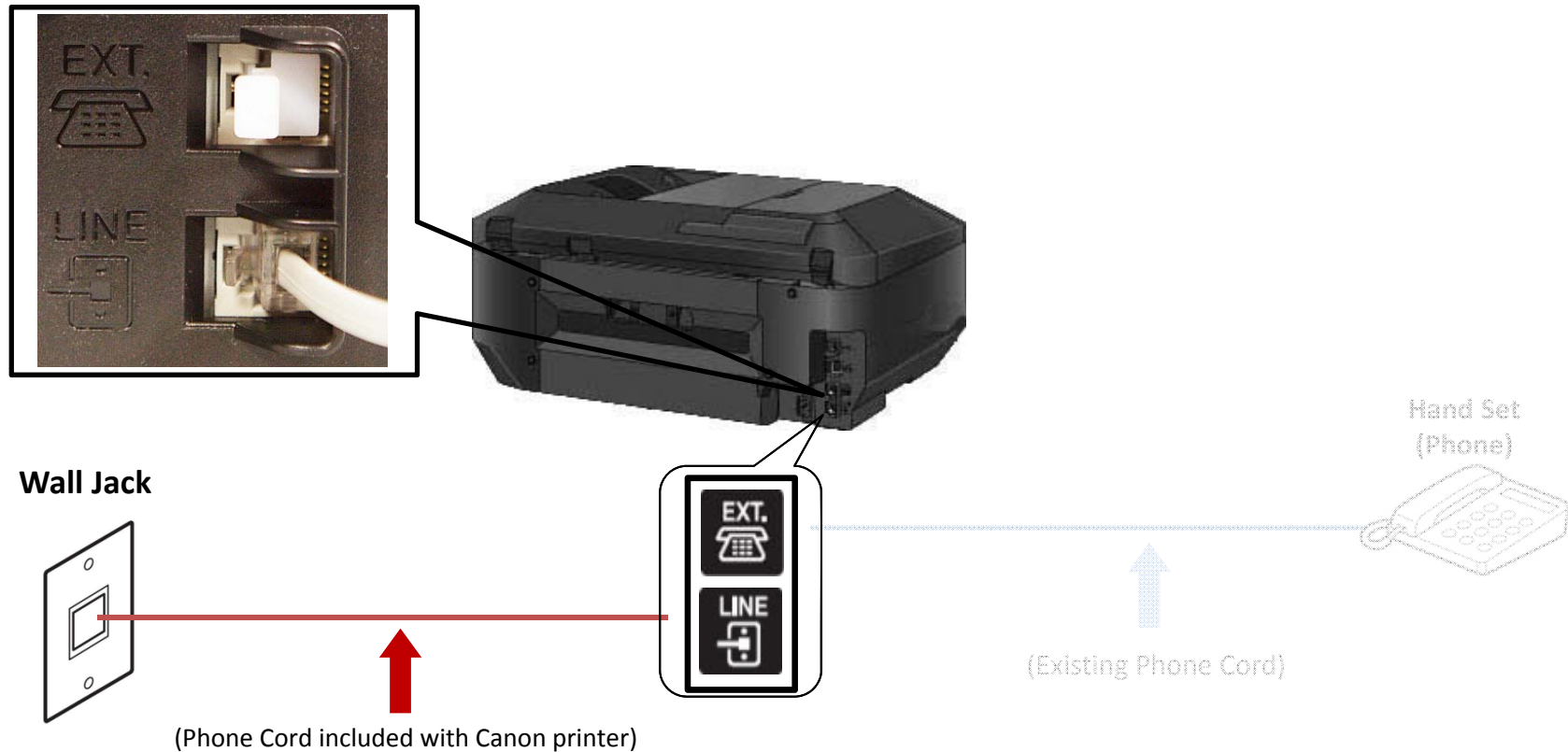

# Fax to Phone Line Connection

- Remove the white plug from the upper jack labeled "EXT."

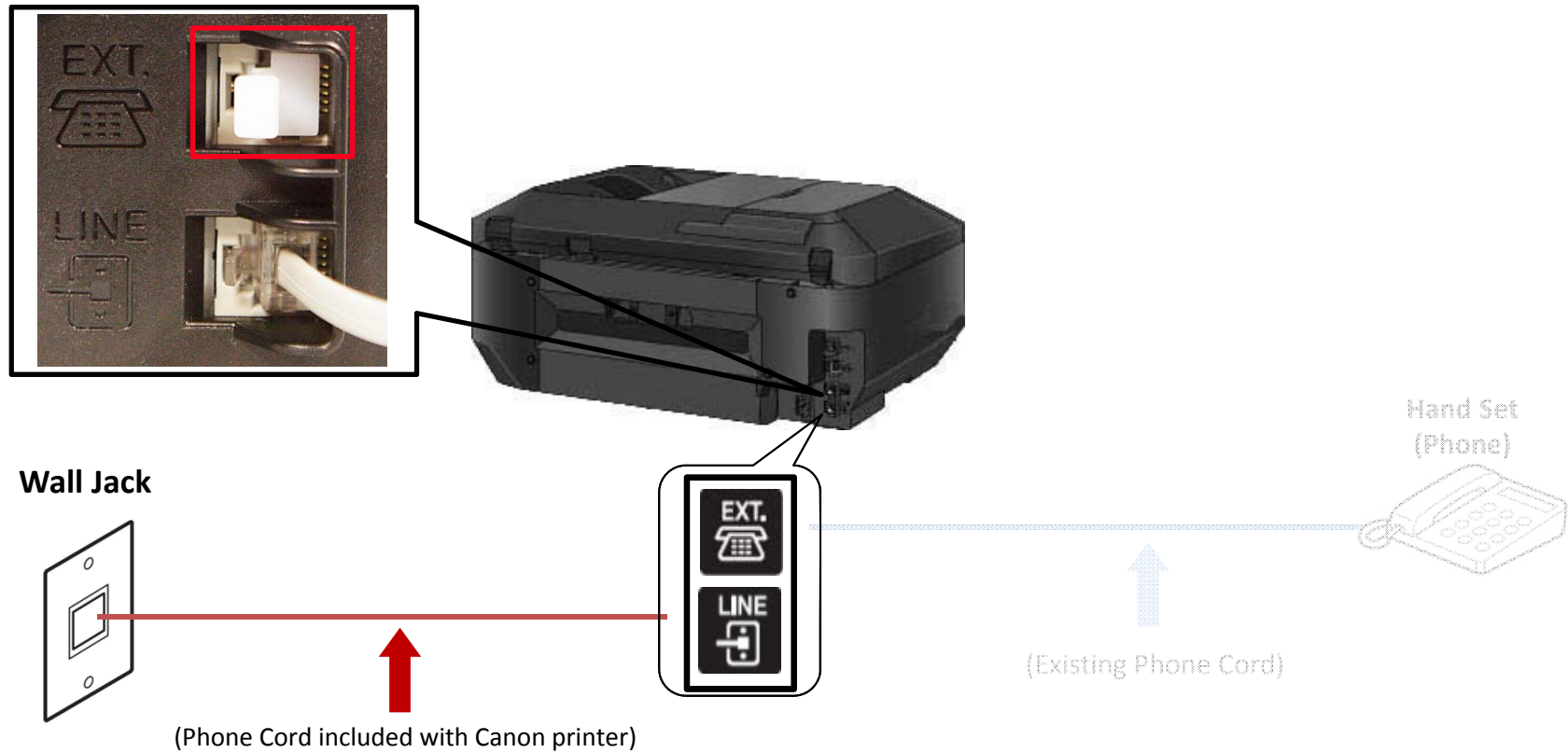



# Fax to Phone Line Connection

- Plug the second phone cord into the “EXT.” jack located on the rear of the multifunction

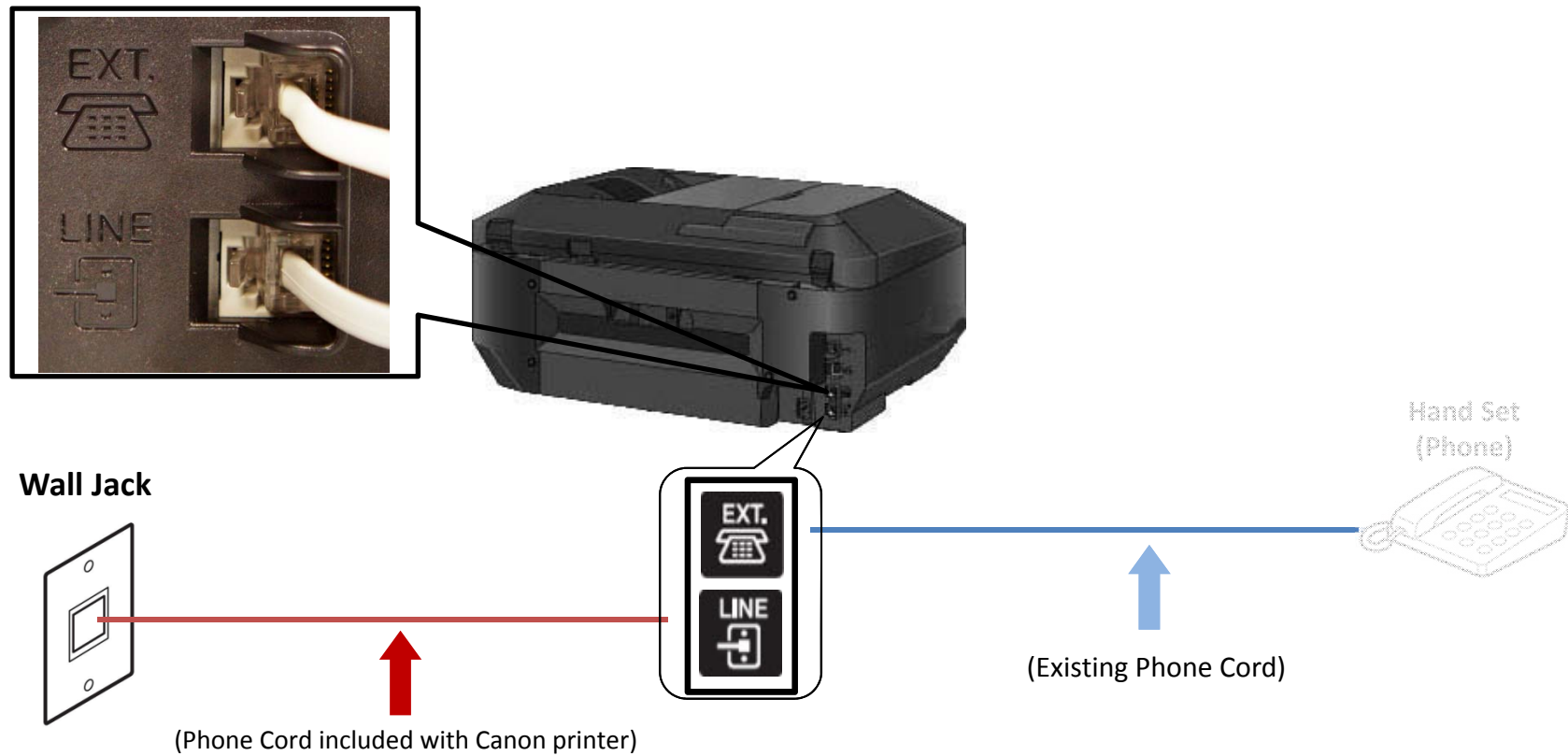

# Fax to Phone Line Connection

- Plug the second phone cord into the phone

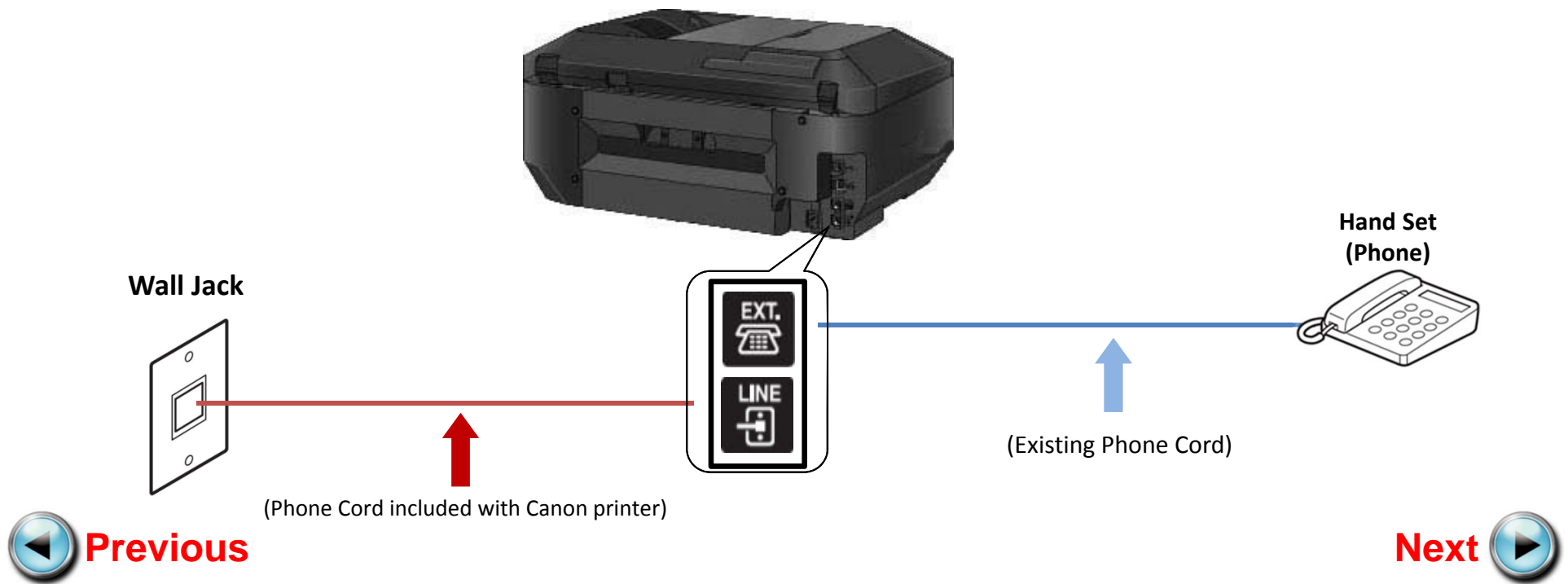



# Setting Up The Receive Mode



## Step 1

Turn on the MX922 by pressing the **ON** button if the machine is not powered on already.

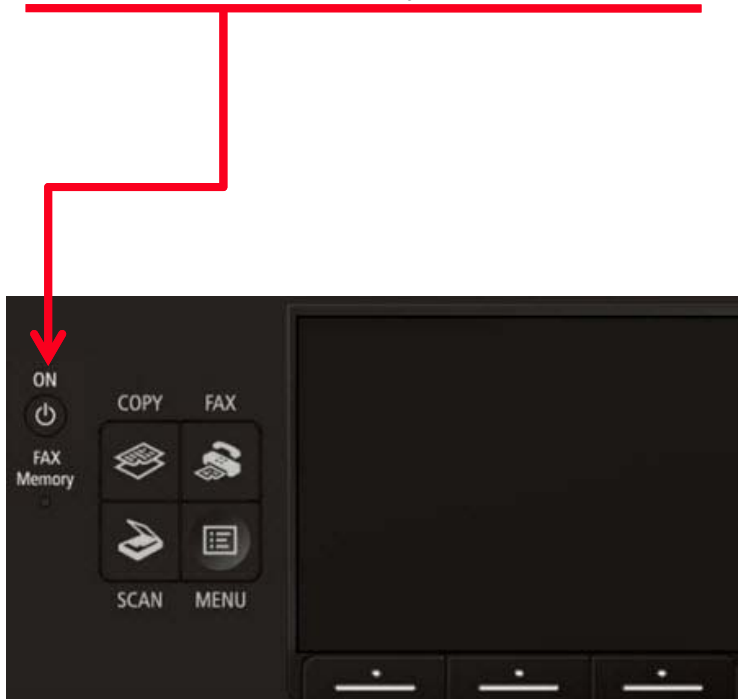

## Step 2

Press the **FAX** button.

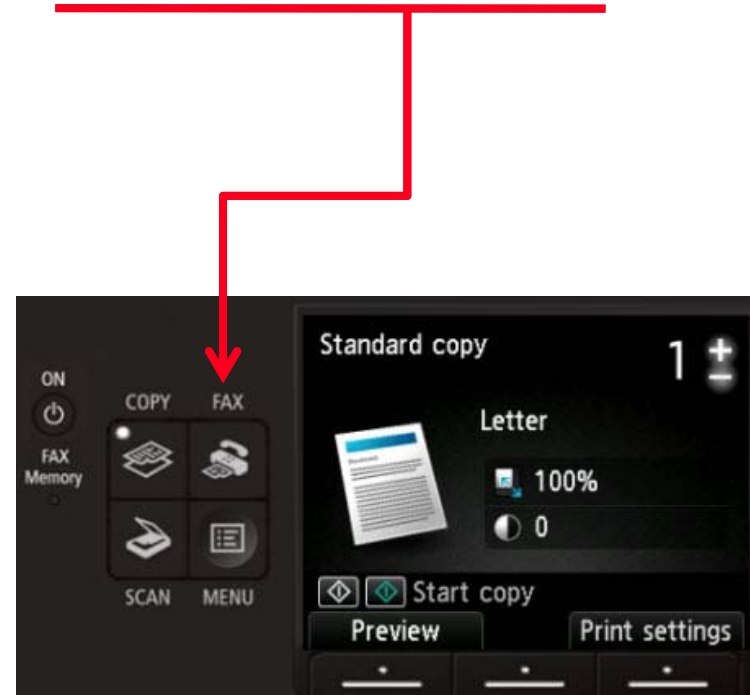

## Step 3

The fax standby screen will appear.

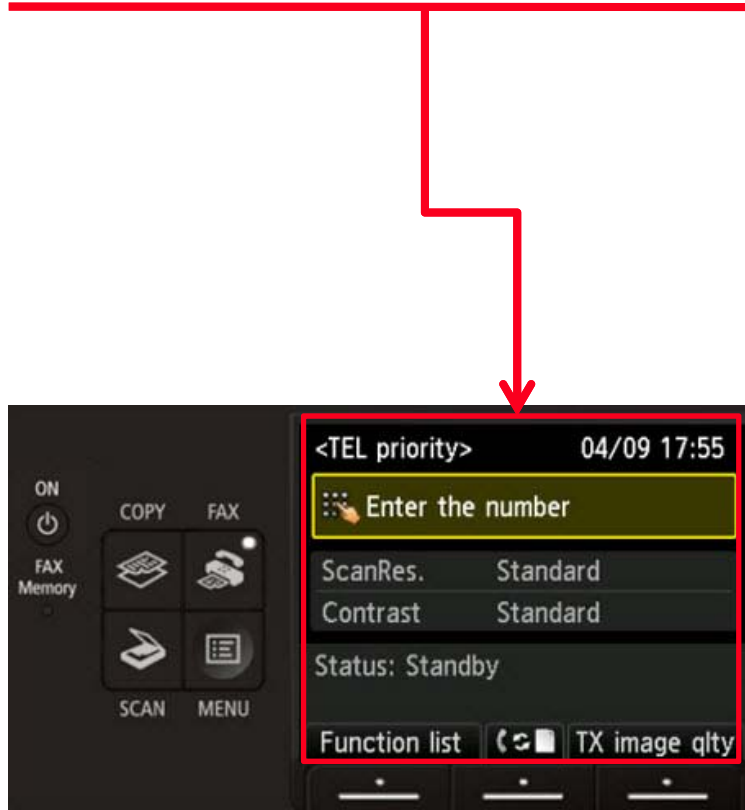

## Step 4

Press the center **FUNCTION** button.



## Step 5

The **Receive mode settings** screen will appear.

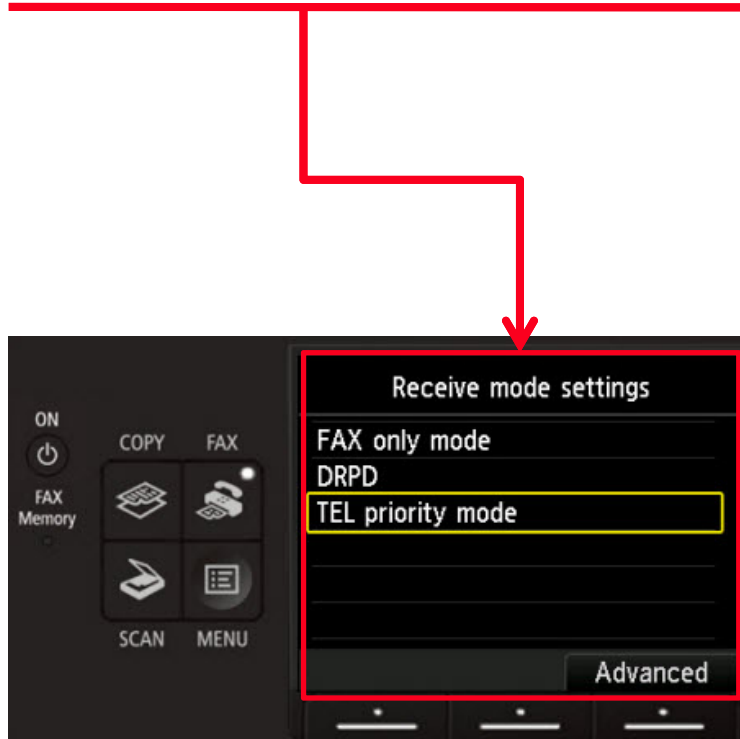

## Step 6

Use the **UP** or **Down** button to highlight “TEL priority mode”.

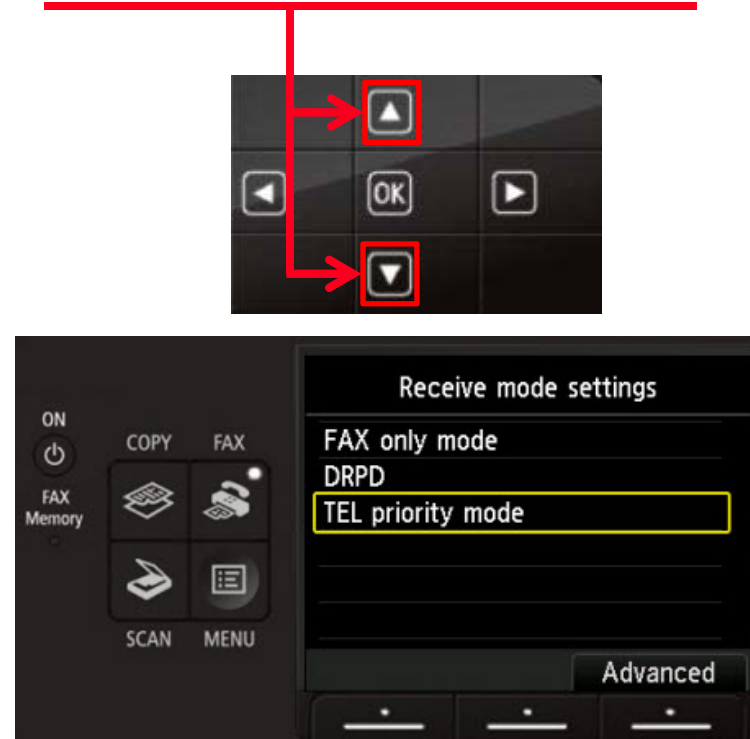

## Step 7

Press the right **FUNCTION** button under the **Advanced** label.

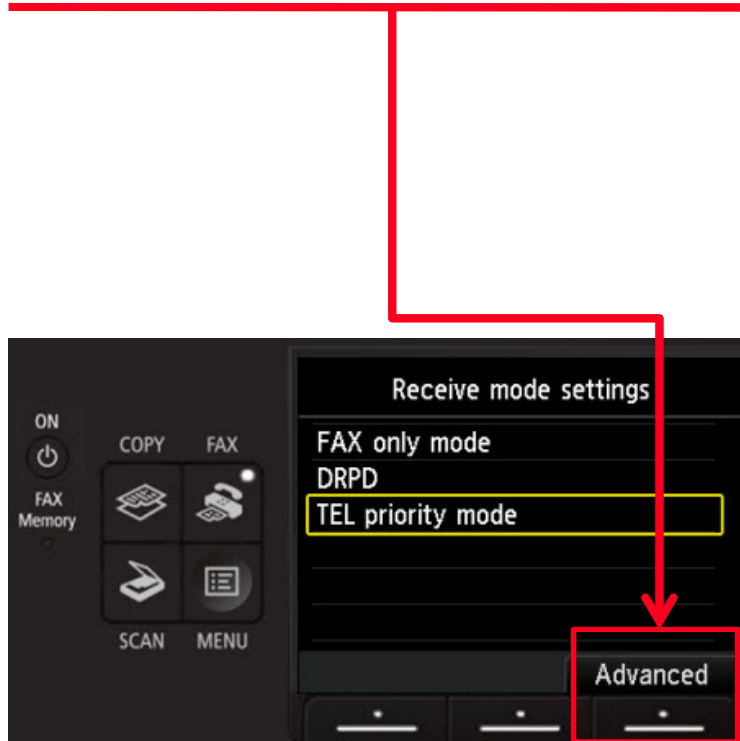

## Step 8

The **Advanced** screen will appear.

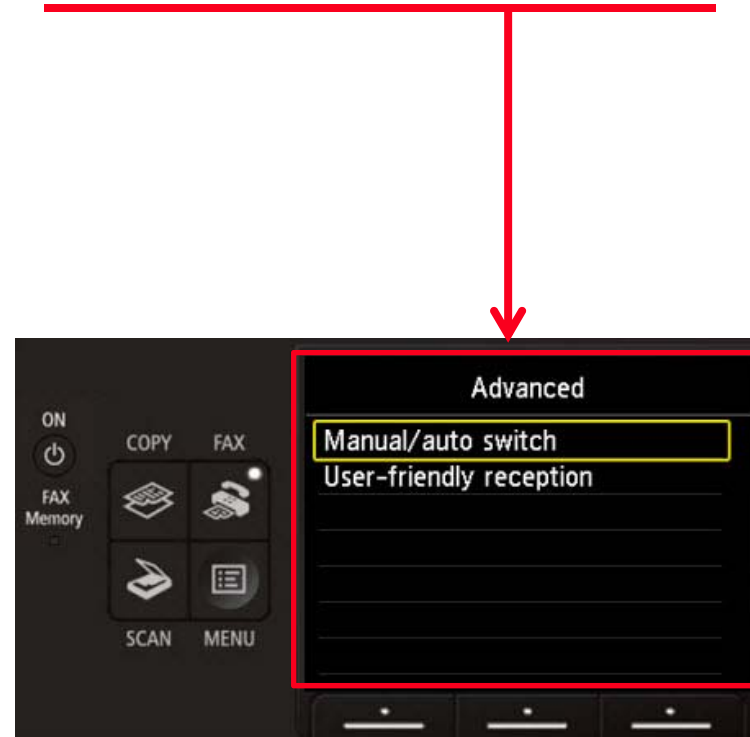

## Step 9

Use the **UP** or **DOWN** button to select “User-friendly reception”.



## Step 10

Press the **OK** button.





## Step 11

The **User-friendly reception** screen will appear.

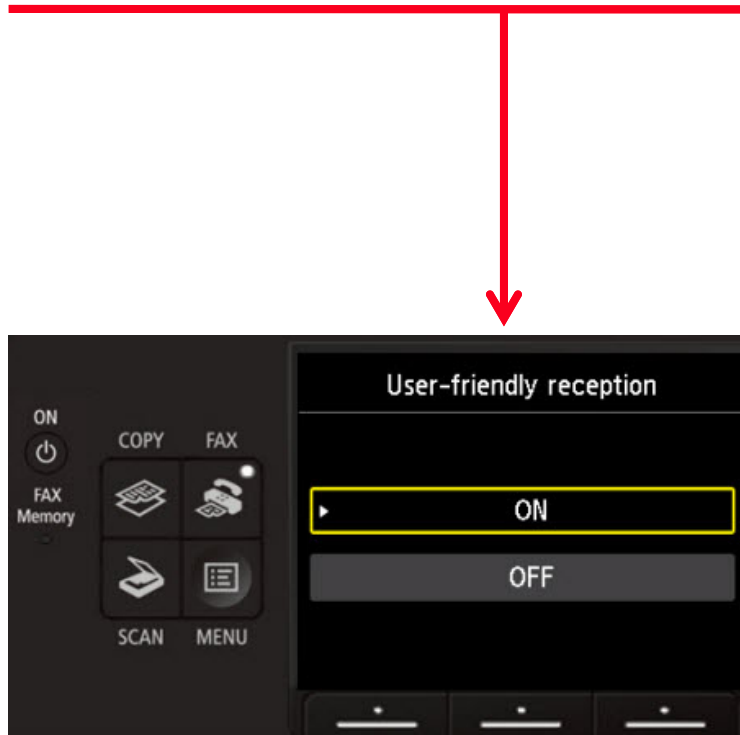

## Step 12

Use the **UP** or **DOWN** button to select "ON".



## Step 13

Press the **OK** button.



## Step 14

The screen will quickly flash “User-friendly reception ON”.

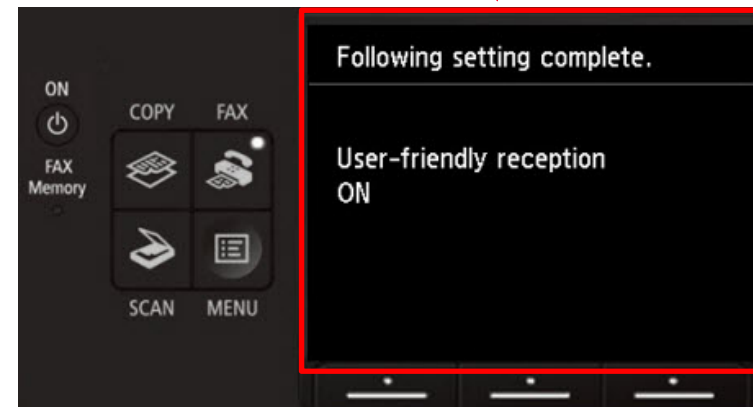

## Step 15

The screen will return to the **Advanced** window.



## Step 16

Press the **Back** button to return to **Receive mode settings** window.

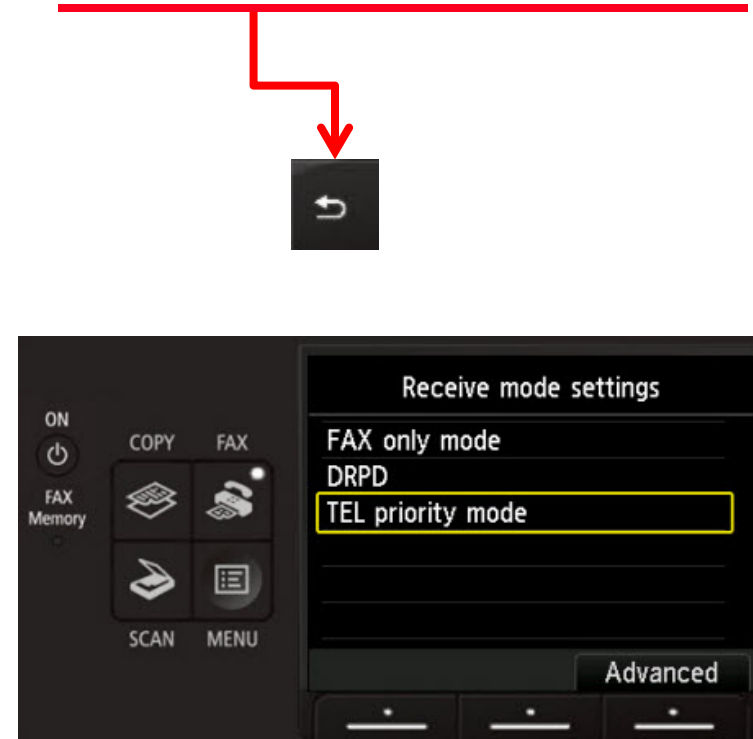

## Step 17

Confirm “TEL priority mode” is highlighted and then press the **OK** button.

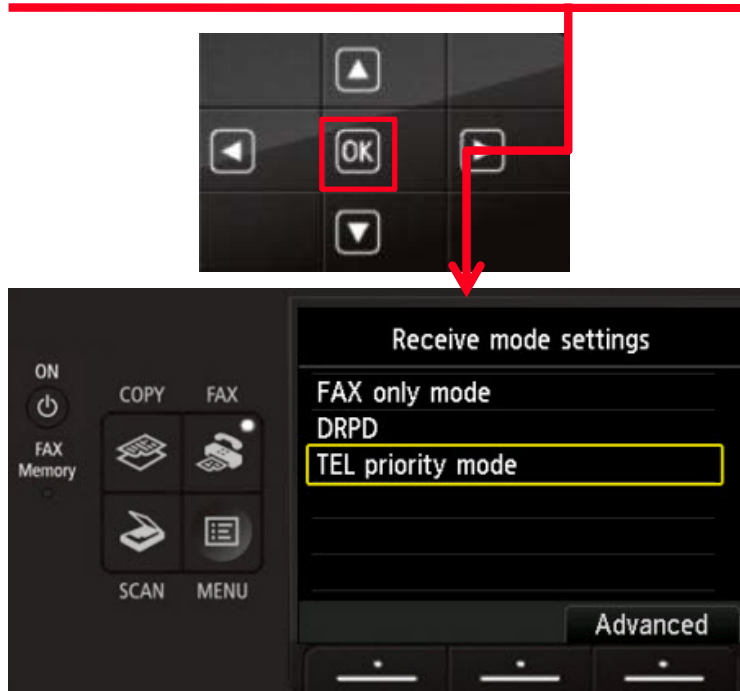

## Step 18

You will return to the “Fax standby screen” and ‘TEL priority’ will appear on the screen.

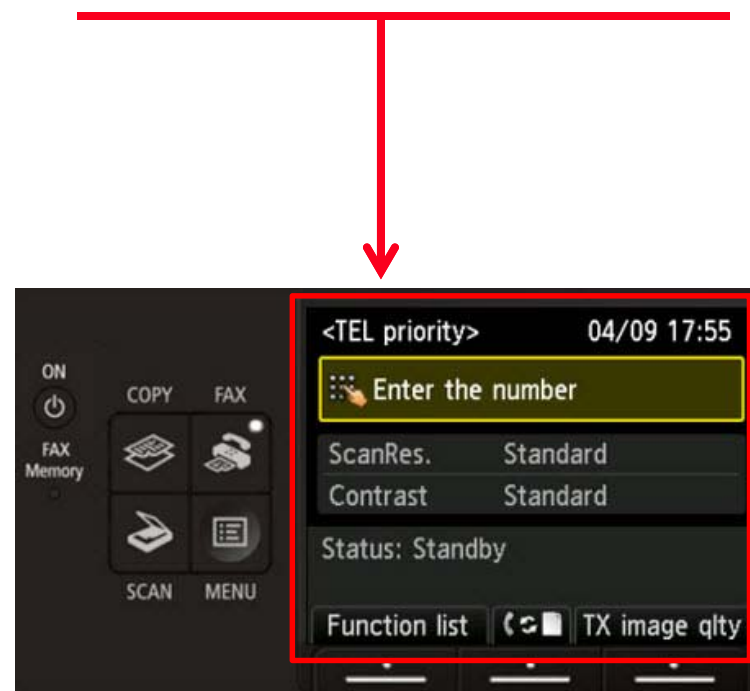

# Receiving A Fax

To receive a fax:

- Pick up the handset on the phone connected to the MX922.
- Listen for fax tones.
- When the tones stop hang up the handset.
- The MX922 will receive the fax document.

To receive a fax while you are away:

- The answering machine will answer the call.
- If fax tones are heard by the MX922 it will take over the call and receive the fax document.

**IMPORTANT:** In order to receive a fax, you must either pick up the handset on a phone that is connected to the MX922 or let your answering machine answer the call.

