

Setting Up Your MX360 or MX410 In Default Mode (Tel Priority Mode) With An Answering Machine

Connecting The Phone Lines

Connecting Your Phone/Answering Machine

Is your answering machine built into your phone?

YES

[Click Here or Go To Page 12](#)

NO

Click the Next Button

Fax to Phone Line Connection

Before

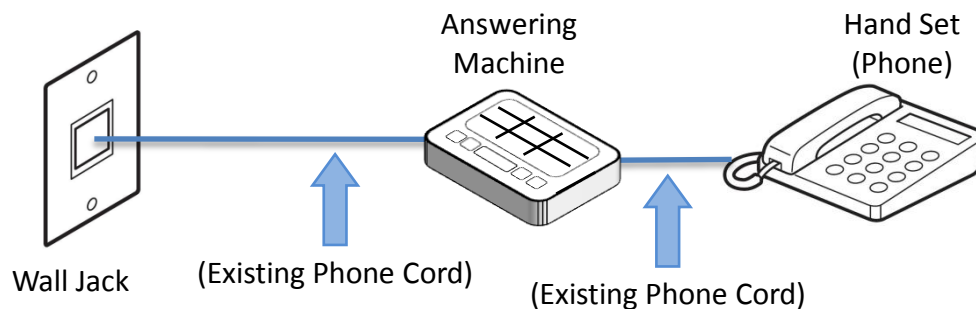

After

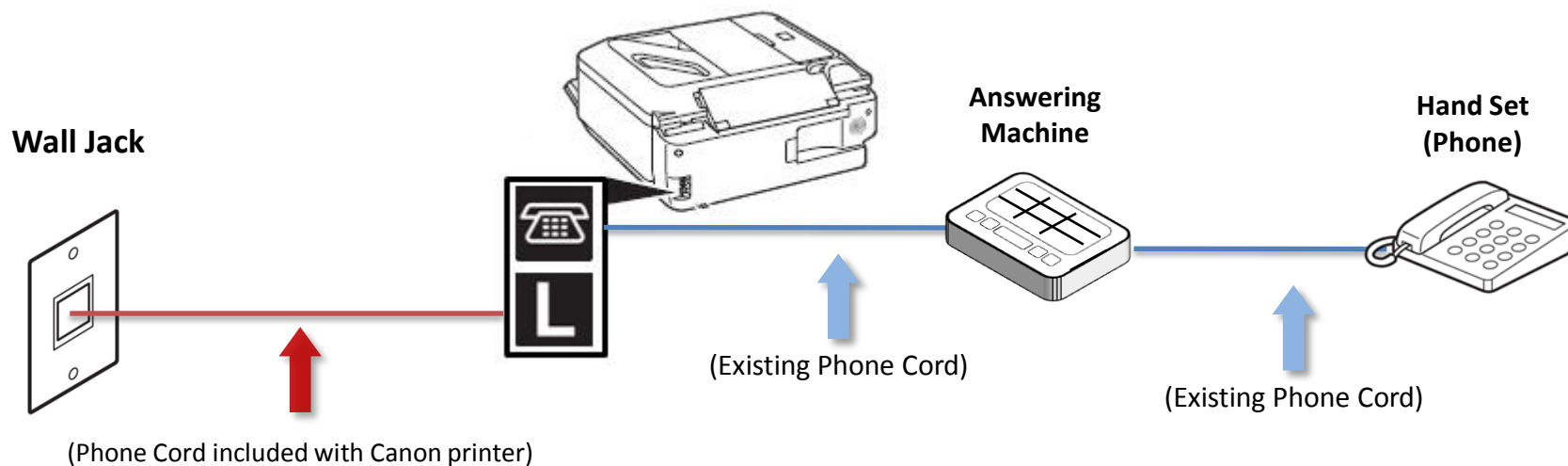

Previous

Next



Fax to Phone Line Connection

- Plug the provided phone cord into the wall jack

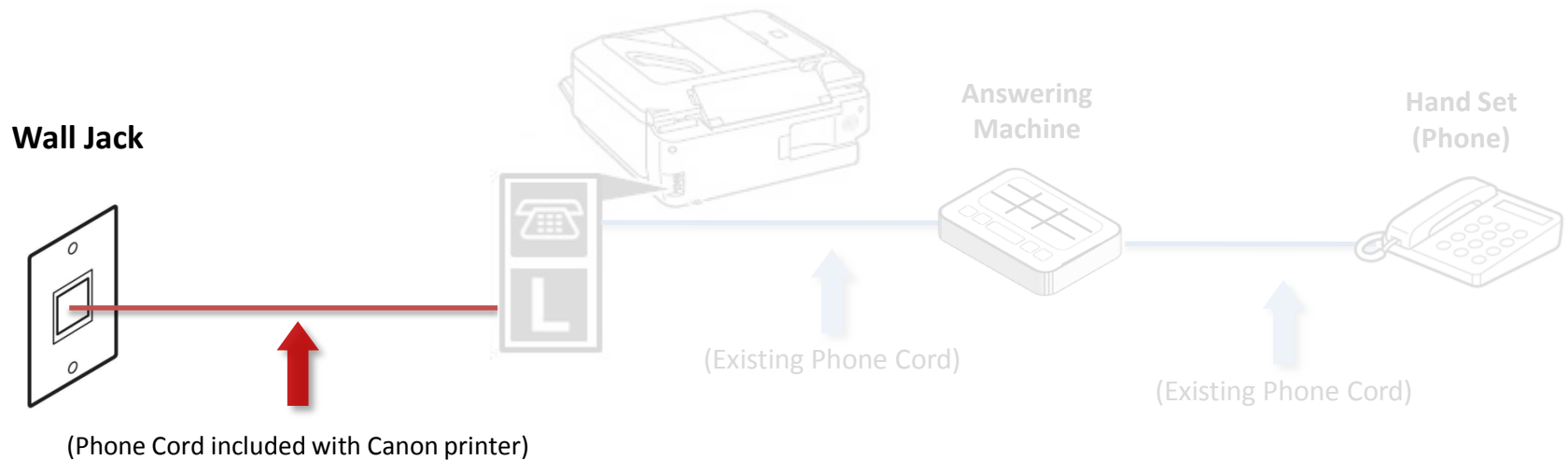

Fax to Phone Line Connection

- Plug the provided phone cord into the “L” jack located on the rear of the multifunction

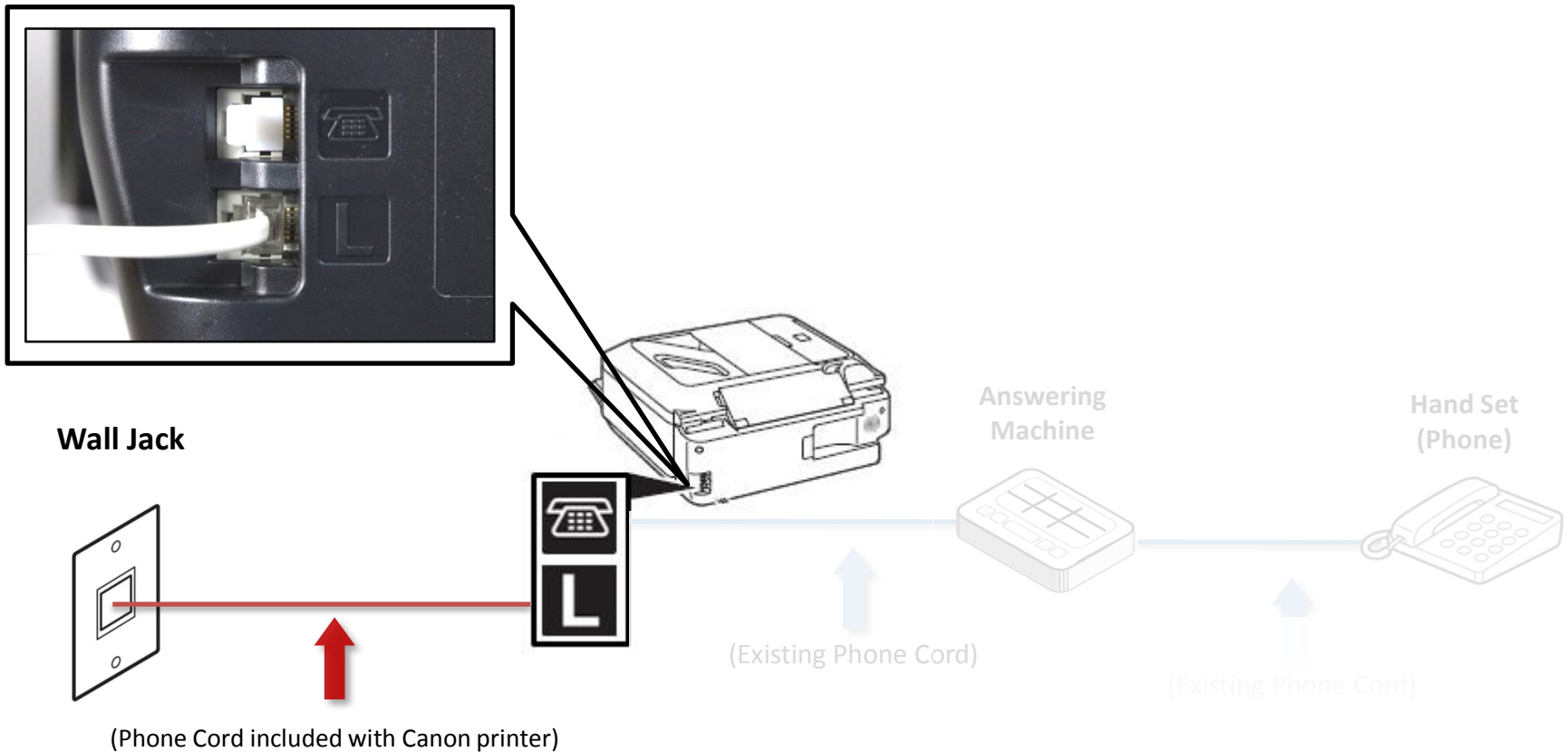

Fax to Phone Line Connection

- Remove the white plug (D) from the upper jack

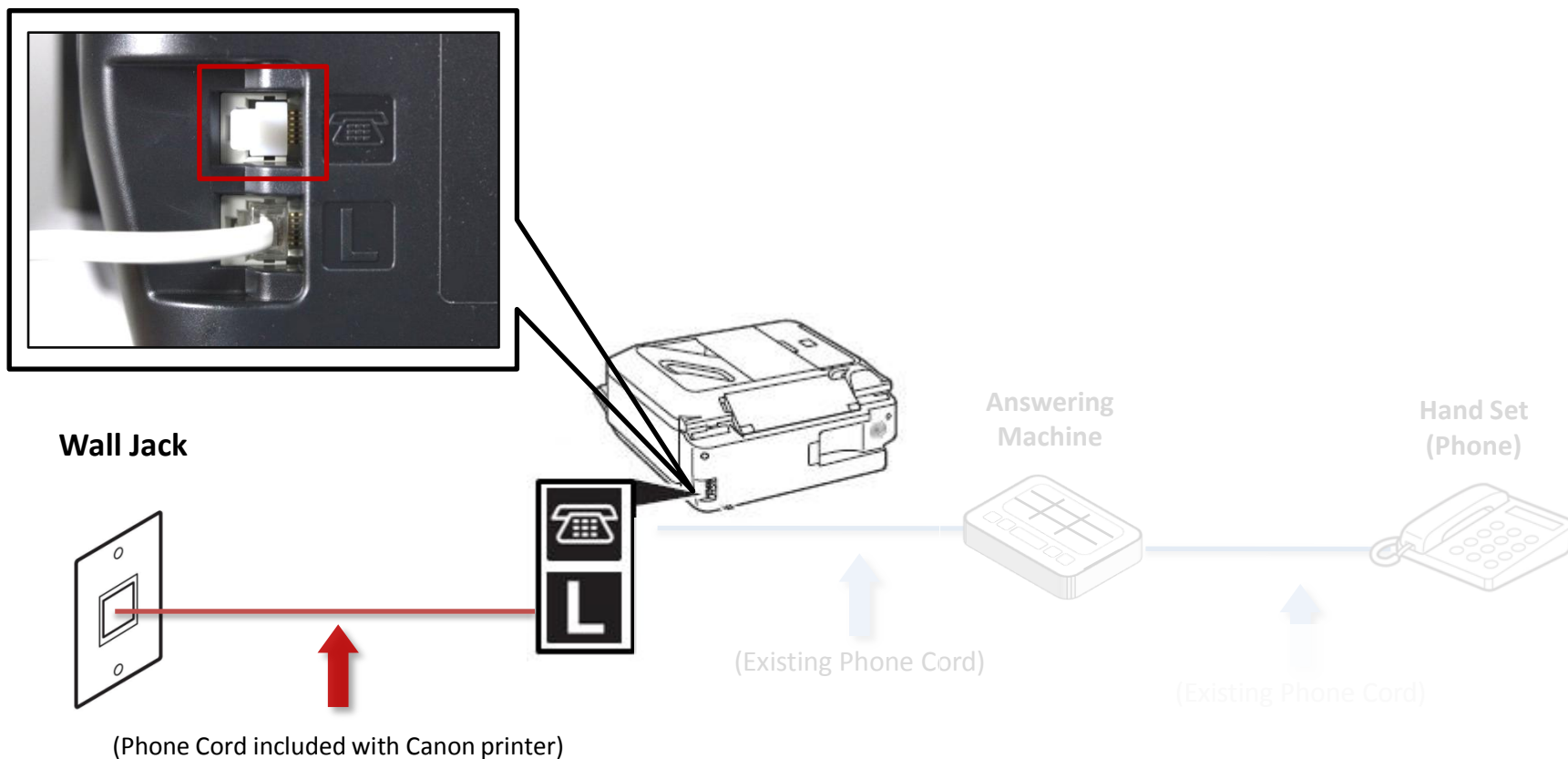

Fax to Phone Line Connection

- Plug the second phone cord into “telephone” jack located on the rear of the multifunction

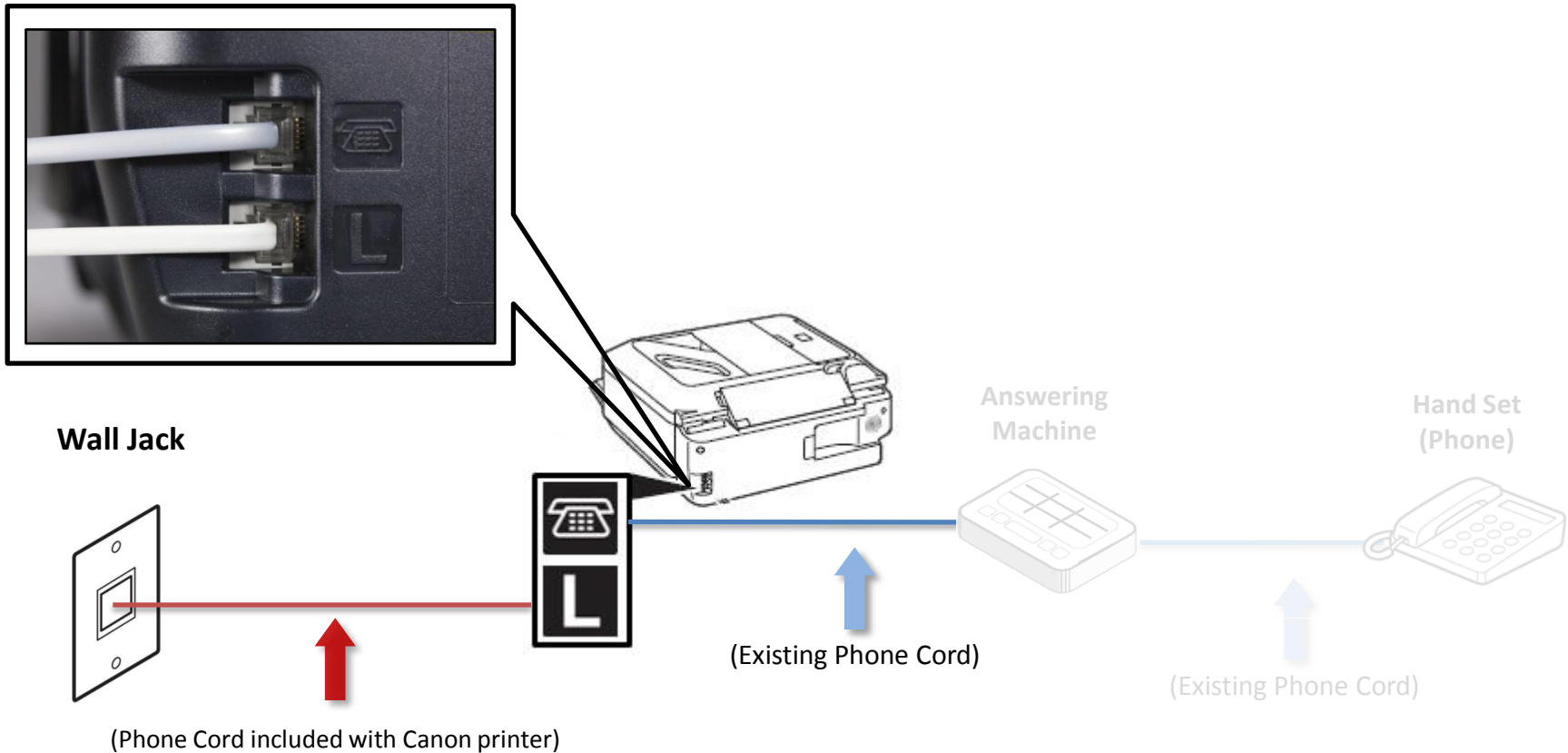

Fax to Phone Line Connection

- Plug the second phone cord into the answering machine

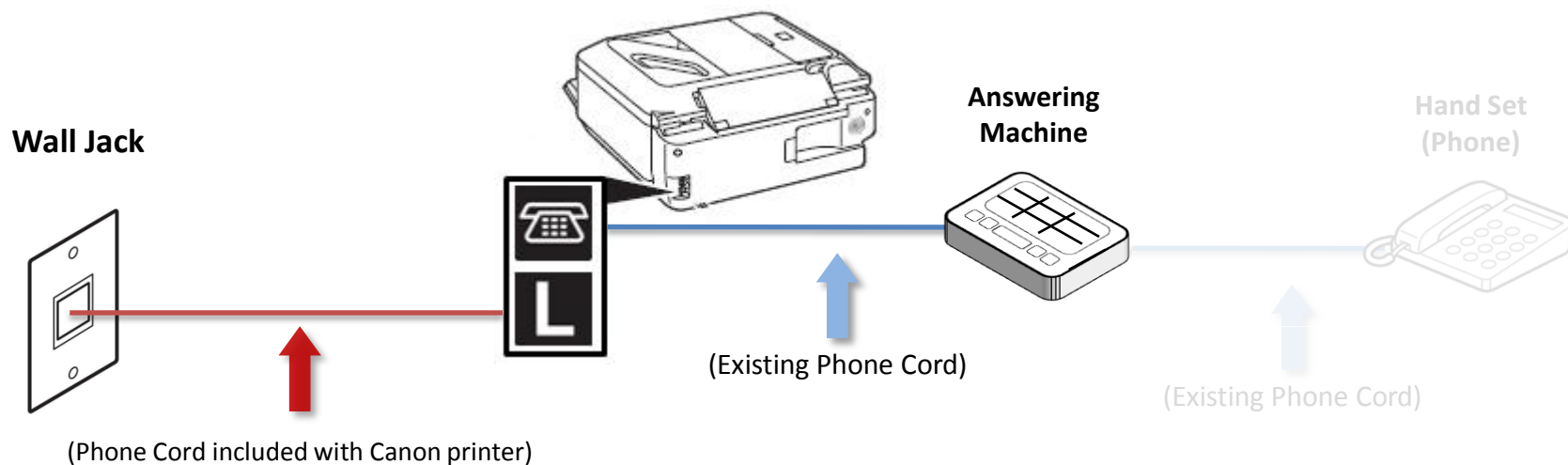

Previous

Next



Fax to Phone Line Connection

- Plug the third phone cord into the answering machine

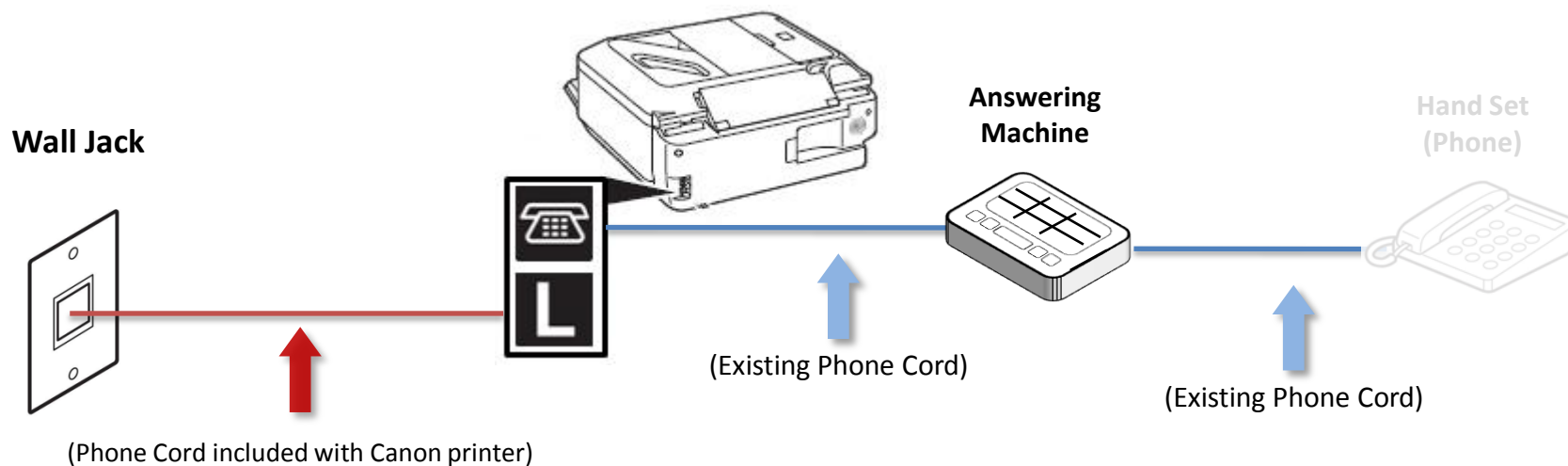

Fax to Phone Line Connection

- Plug the third phone cord into the phone

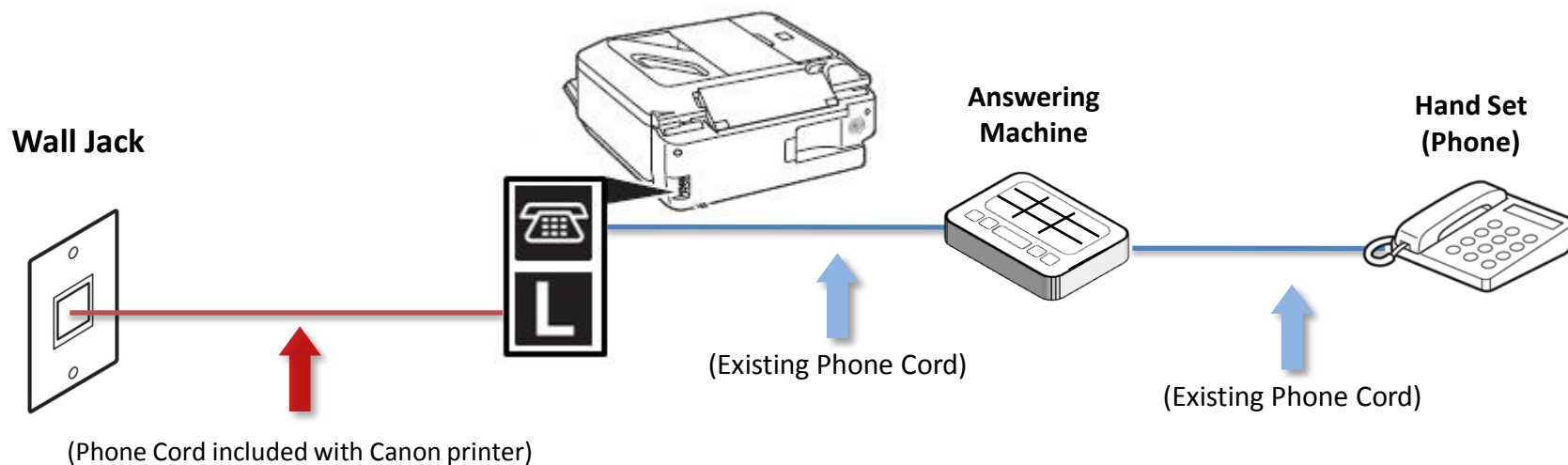

Fax to Phone Line Connection

Before

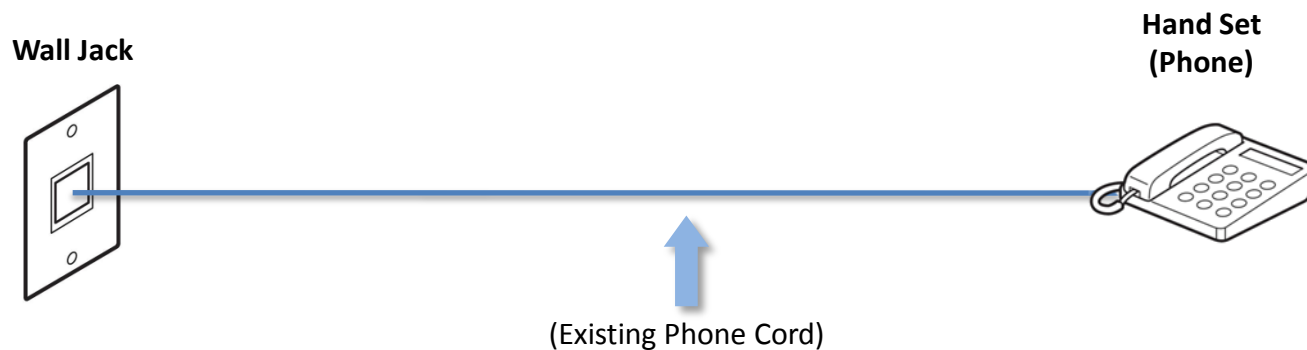

After

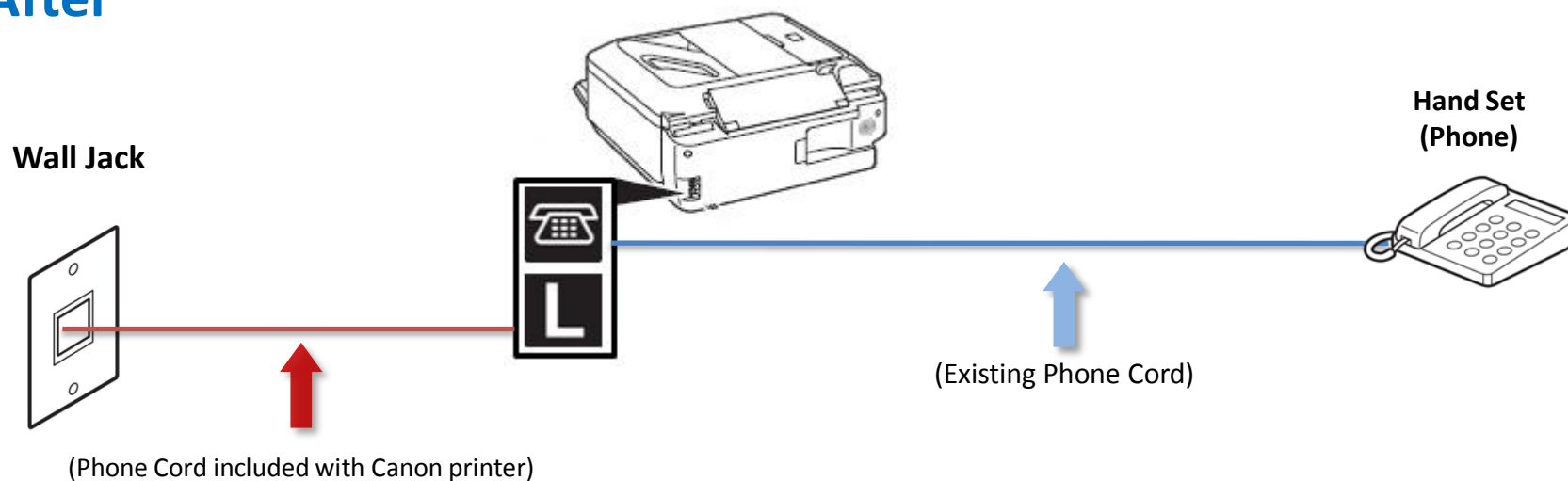

Previous

Next



Fax to Phone Line Connection

- Plug the provided phone cord into the wall jack

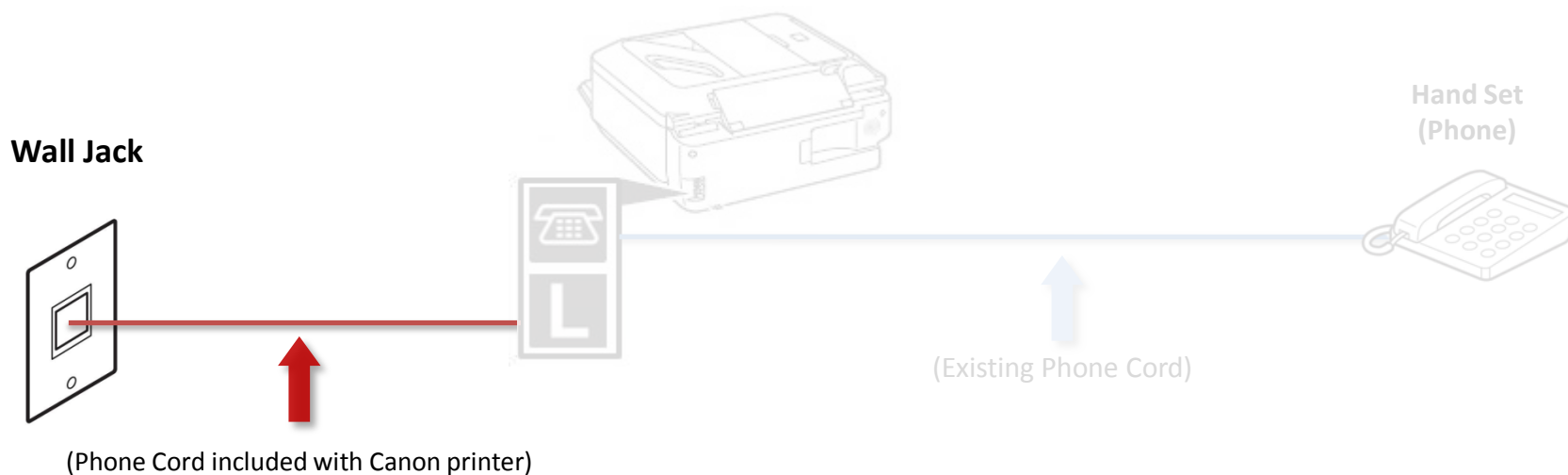

Fax to Phone Line Connection

- Plug the provided phone cord into the “L” jack located on the rear of the multifunction

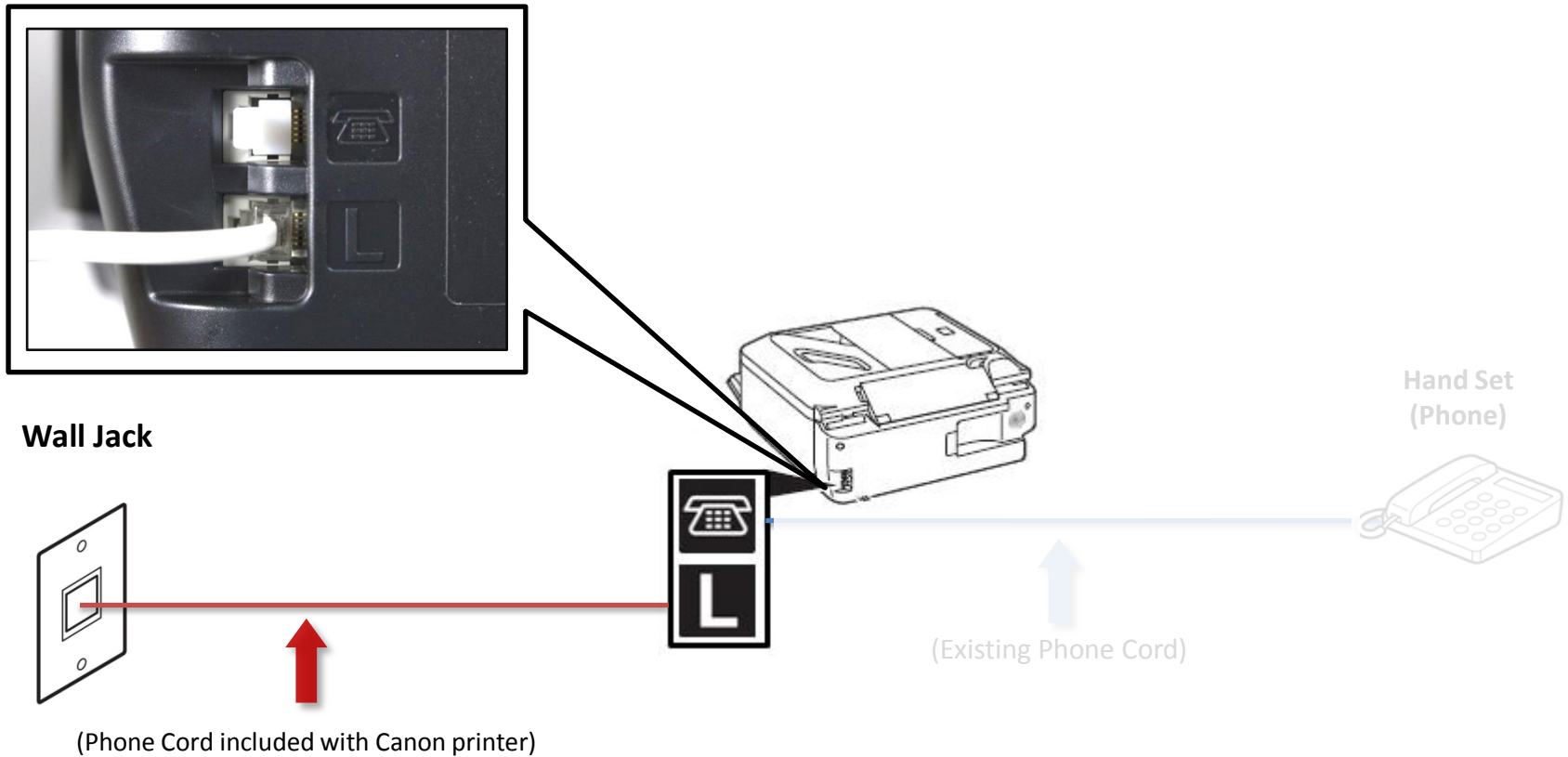

Fax to Phone Line Connection

- Remove the white plug (D) from the upper jack.

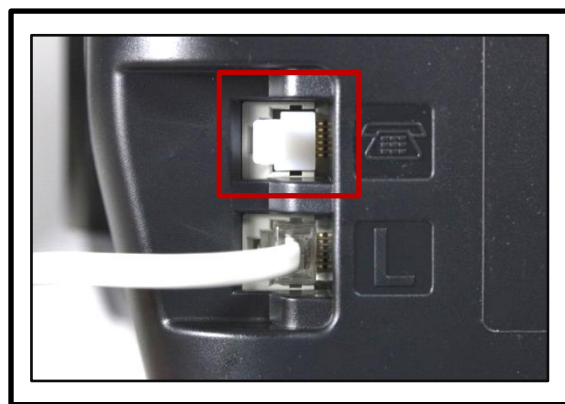

Wall Jack



(Phone Cord included with Canon printer)

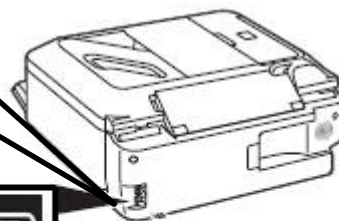

(Existing Phone Cord)

Hand Set
(Phone)



Previous

Next



Fax to Phone Line Connection

- Plug the second phone cord into the “telephone” jack located on the rear of the multifunction

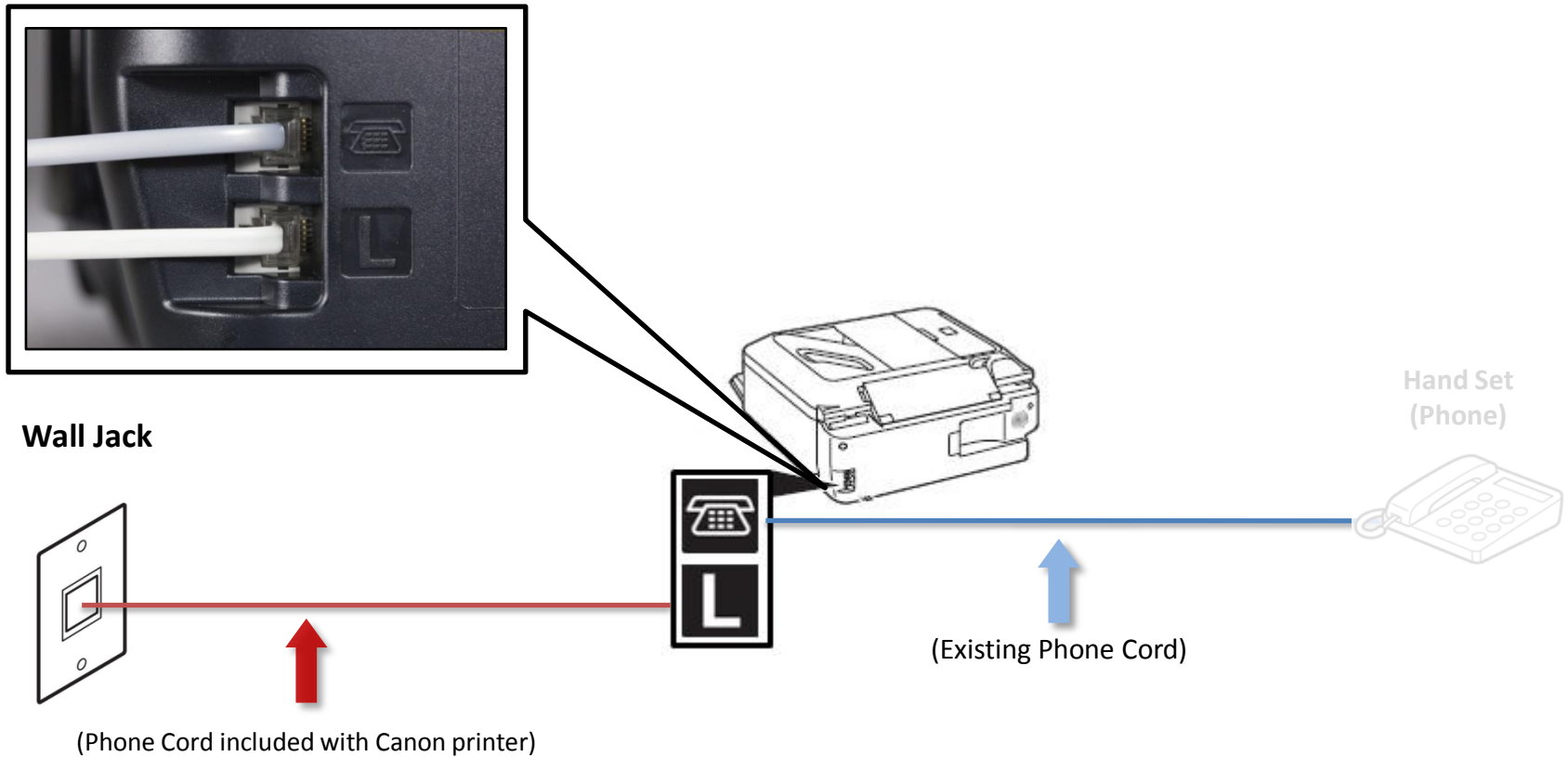

Fax to Phone Line Connection

- Plug the second phone cord into the phone

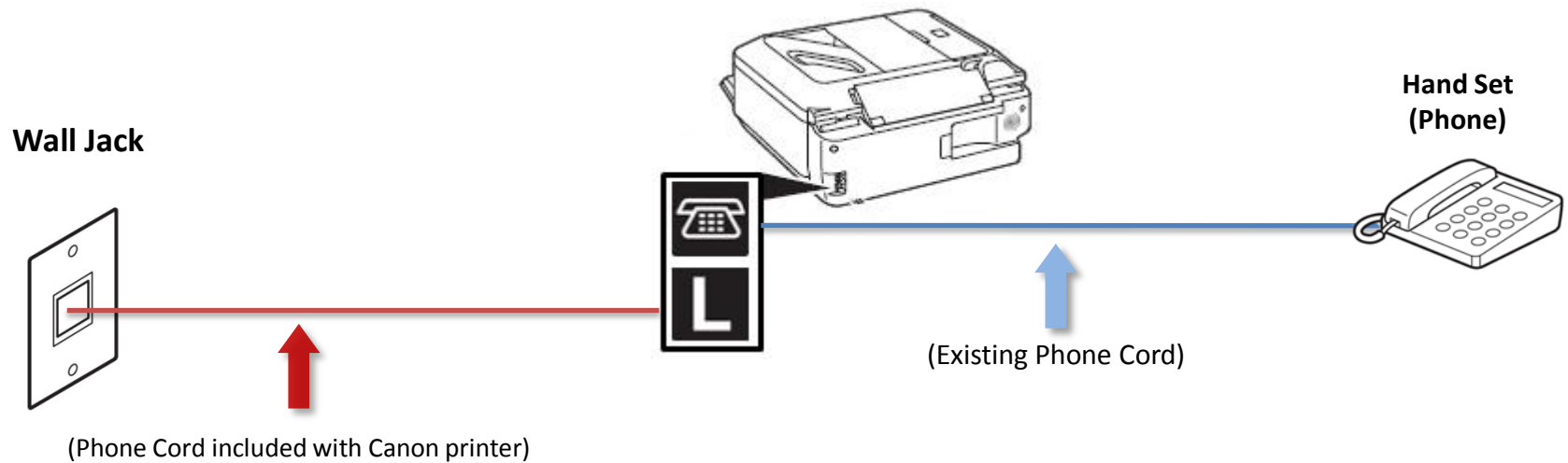



Setting Up The Receive Mode



Return To “Connecting Your Phone/Answering Machine”

Next



Step 1

Turn on the MX360 or MX410 by pressing the **ON** button.



MX360



MX410

Step 2

Press the **FAX** button.

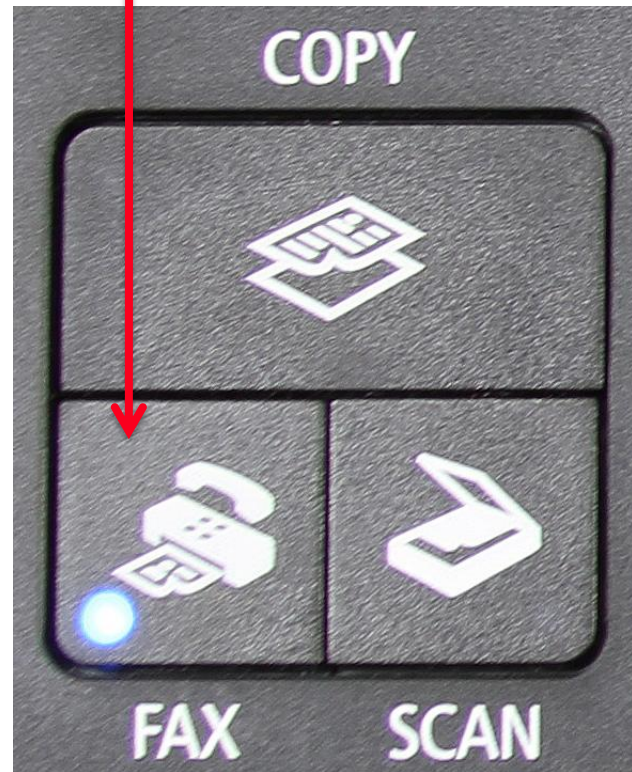

Step 3

Press the **Menu** button

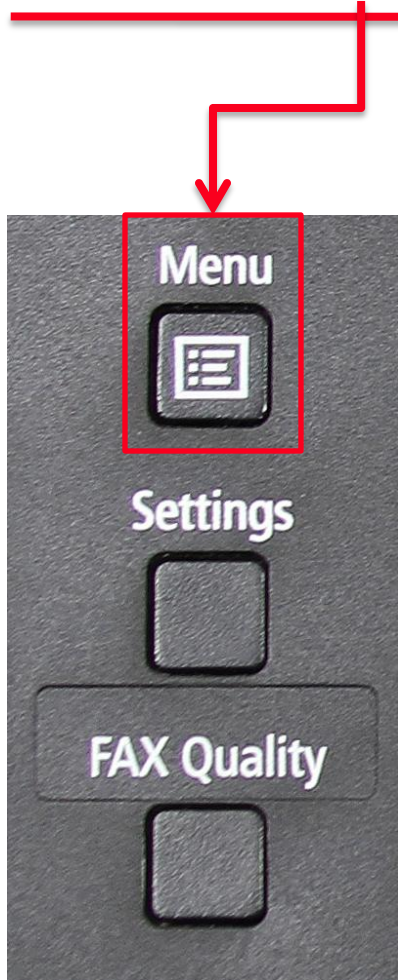

Step 4

Use the **Left** or **Right** Arrow button to select "Receive mode set".

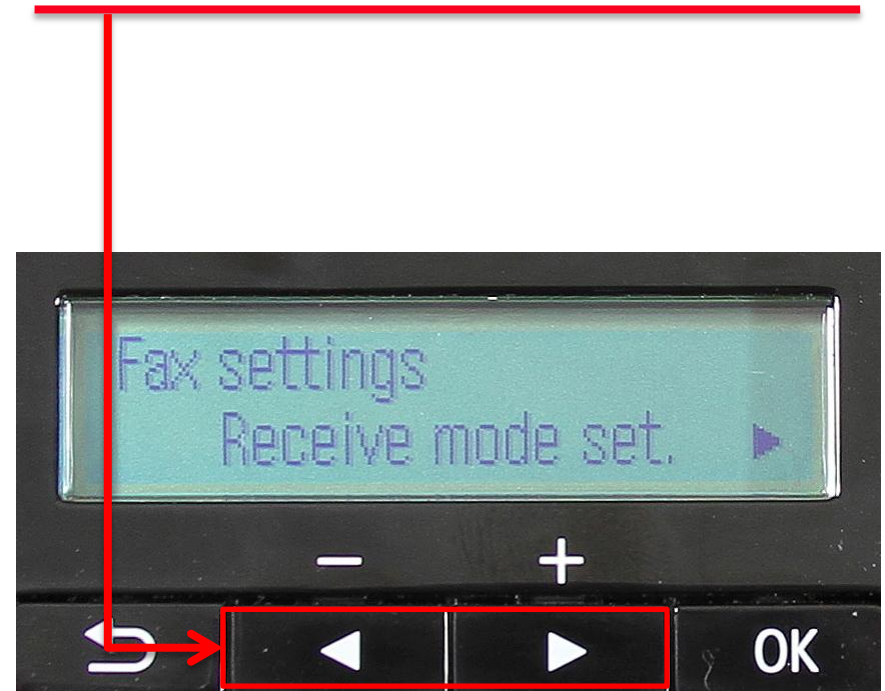

Step 5

Press the **OK** button



Step 6

The "Receive mode set" screen will appear



Step 7

Use the **Left** or **Right** arrow button to select "TEL priority mode"



Step 8

Ensure that "TEL priority mode" is displayed



Step 9

Press the **OK** button



Step 10

The "Make advanced settings?" screen will appear

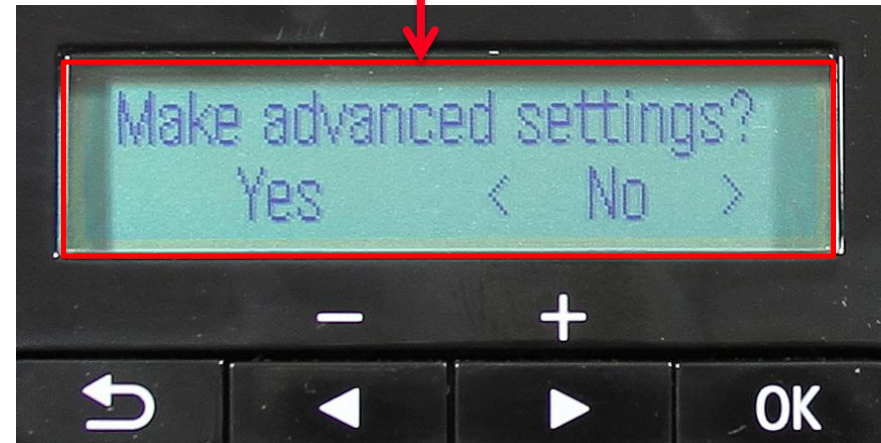

Step 11

Use the **Left** or **Right** arrow button to select "Yes"

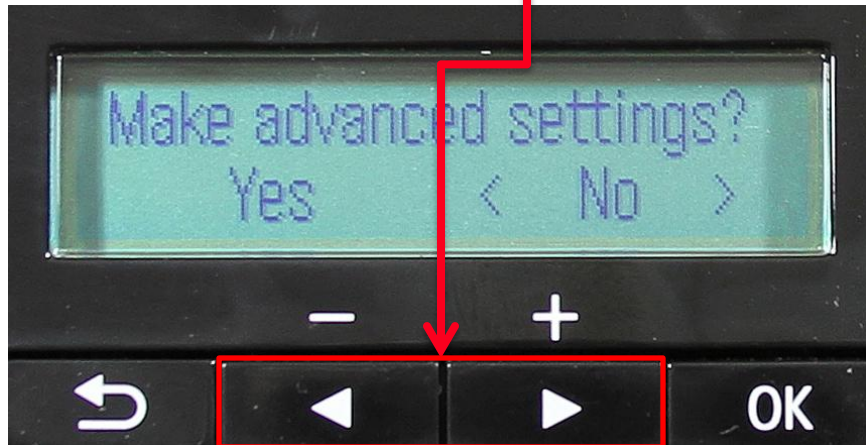

Step 12

Ensure "Yes" is selected

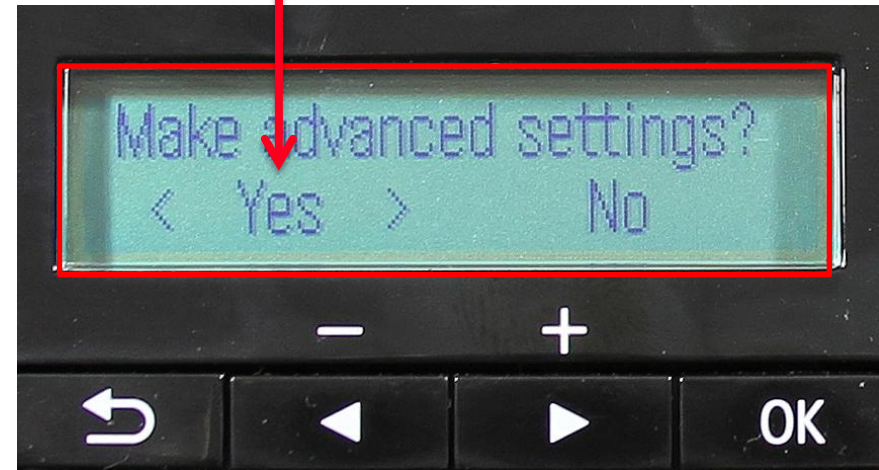

Step 13

Press the **OK** button

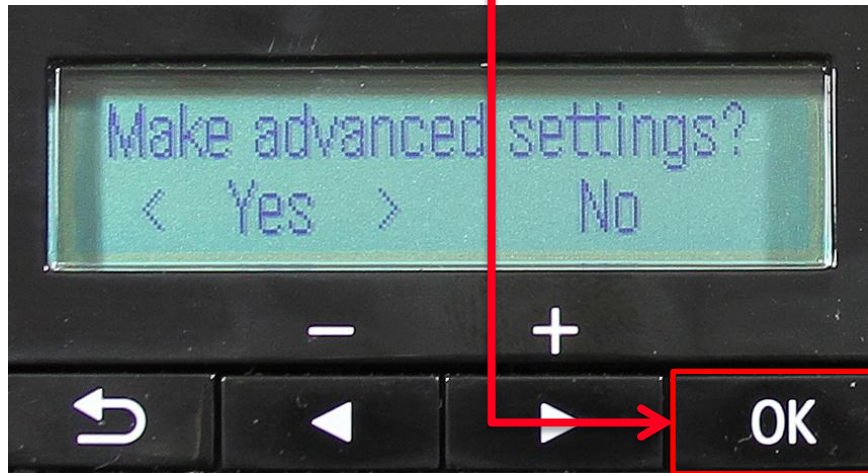

Step 14

The "TEL priority mode screen will appear

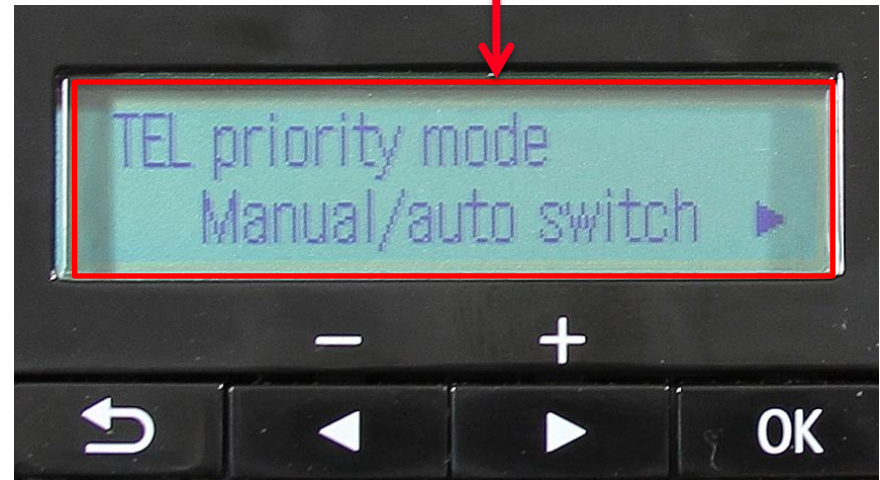

Step 15

Use the **Left** or **Right** arrow button to select "User-friendly RX"

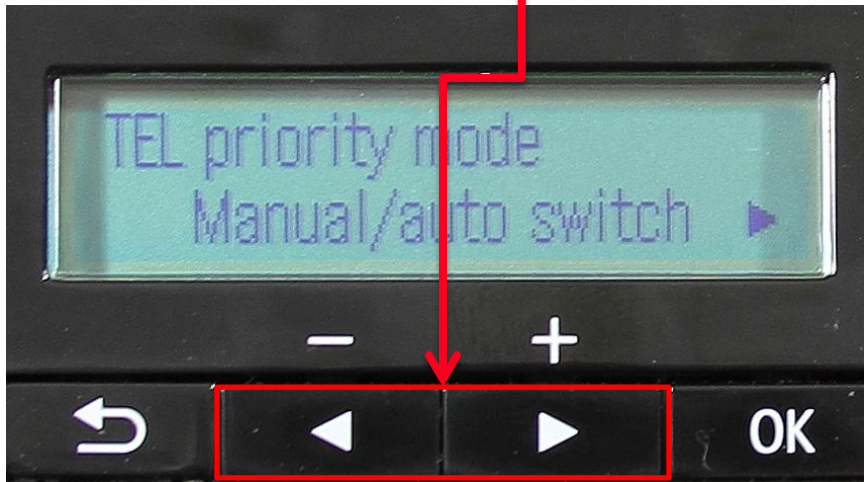

Step 16

Confirm "User-friendly RX" is selected

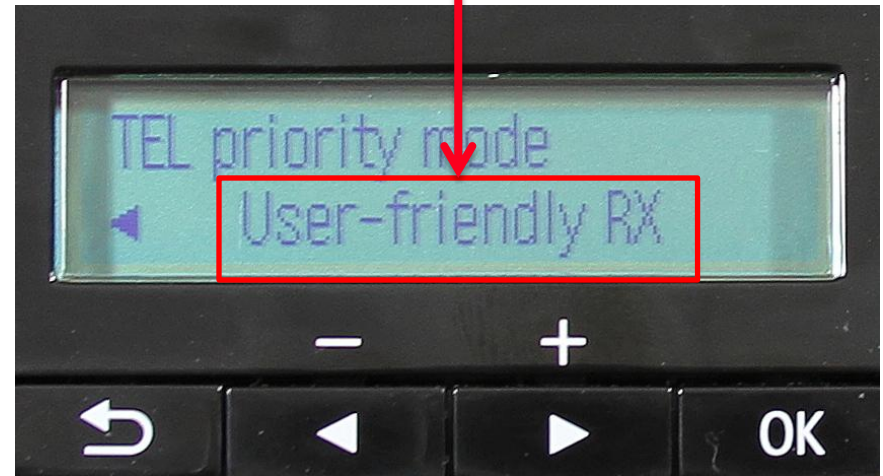

Step 17

Press the **OK** button

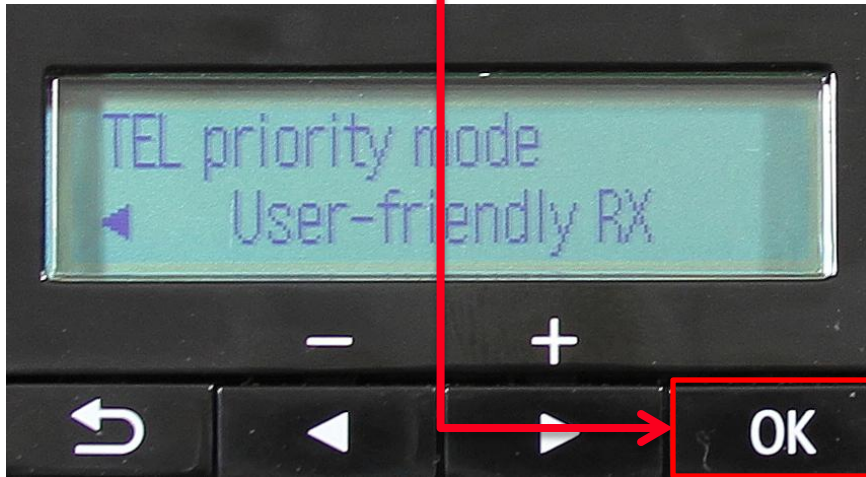

Step 18

The "User-friendly RX" screen will appear



Step 19

Use the **Left** or **Right** arrow button to select "ON"

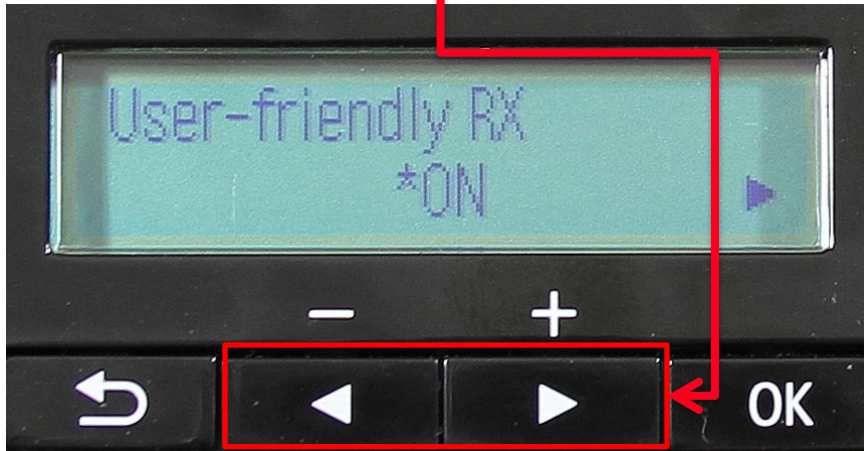

Step 20

Ensure "ON" is selected

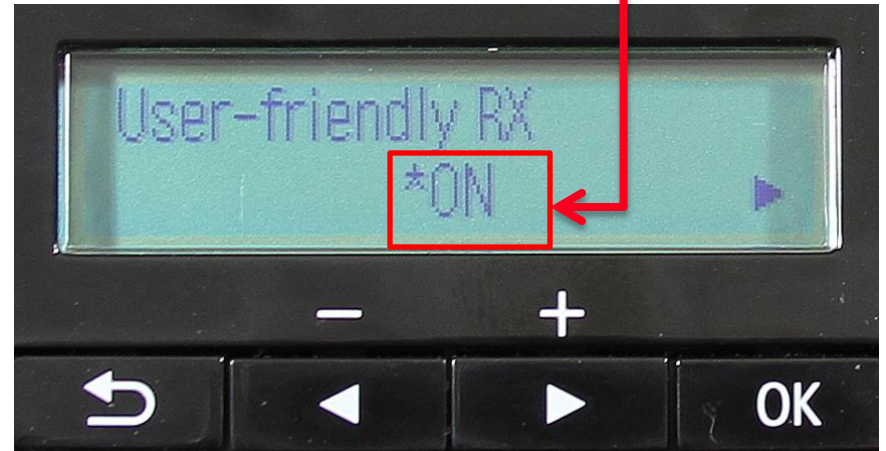

Step 21

Press the **OK** button

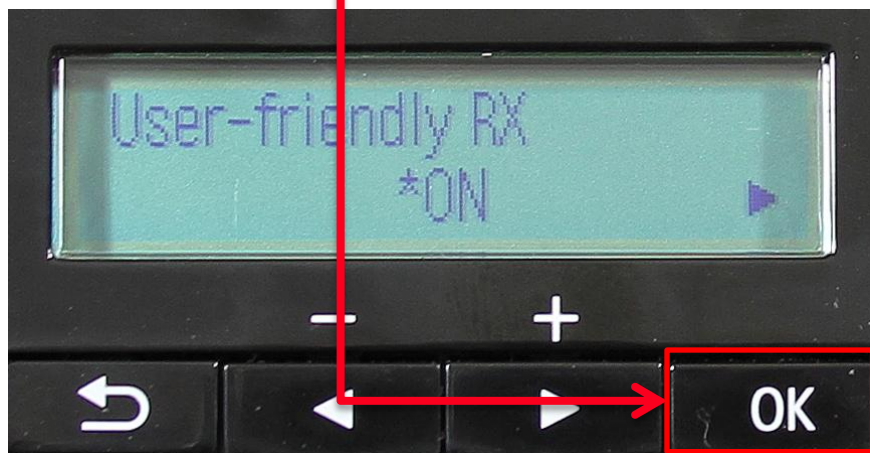

Step 22

The screen will return to the fax standby screen. Your MX360 or MX410 is now ready to receive a fax



Receiving A Fax

To receive a fax when you are home you will:

- Pick up the handset on the phone connected to the MX360 or MX410.
- Listen for fax tones.
- When the tones stop hang up the handset.
- The MX360 or MX410 will receive the fax document.

To receive a fax while you are away:

- The answering machine will answer the call.
- If fax tones are heard by the MX360 or MX410 it will take over the call and receive the fax document.

IMPORTANT: In order to receive a fax, you must either pick up the handset on a phone that is connected to the MX360 or MX410 or let your answering machine answer the call.

