



# Setting Up Your MX330 In Default Mode (Tel Priority Mode) With An Answering Machine DSL/Cable Modem Connection





# Connecting The Phone Lines



**Previous**

**Next**



# Connecting Your Phone/Answering Machine

Is your answering machine built into your phone?

**YES**

[Click Here or Go To Page 12](#)

**NO**

Click the Next Button

 **Previous**

**Next** 

# Fax to Phone Line Connection

**Before**

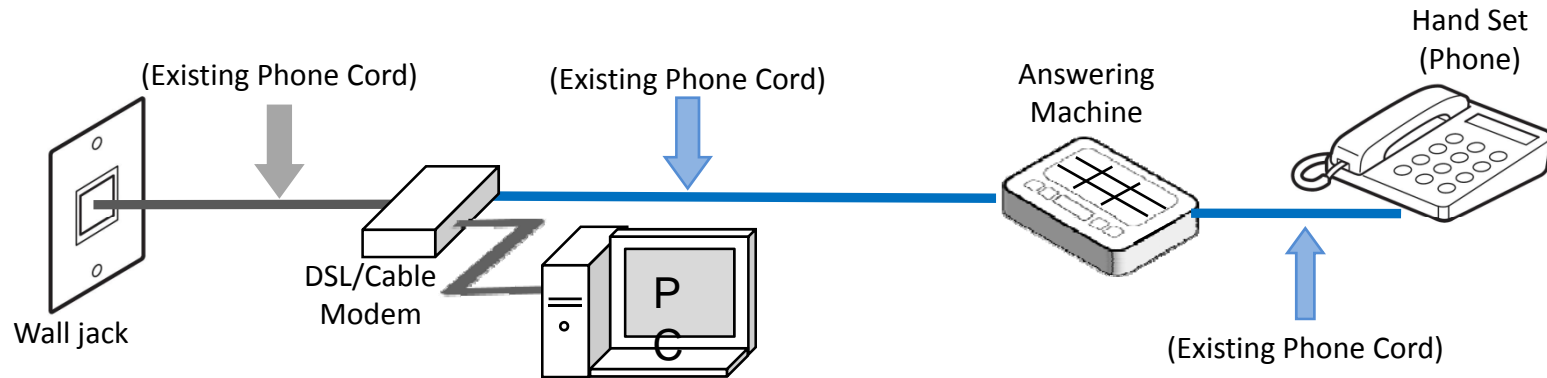

**After**

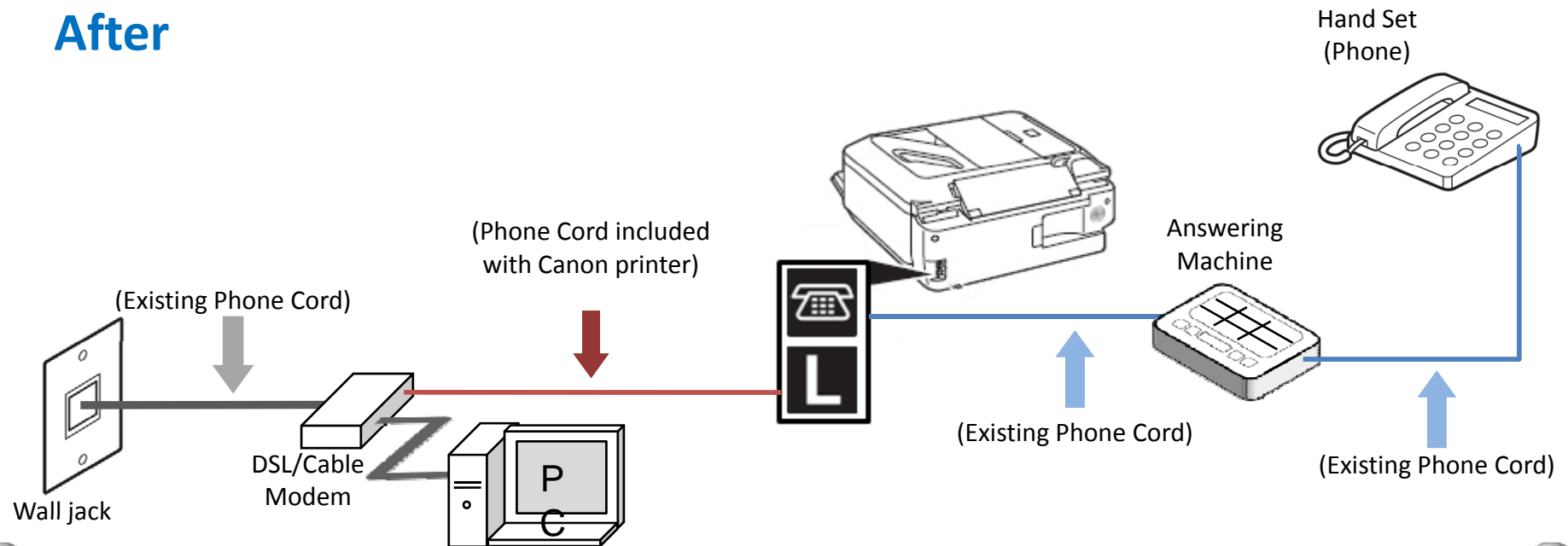

 **Previous**

**Next** 

# Fax to Phone Line Connection

- Plug the provided phone cord into the DSL/Cable Modem

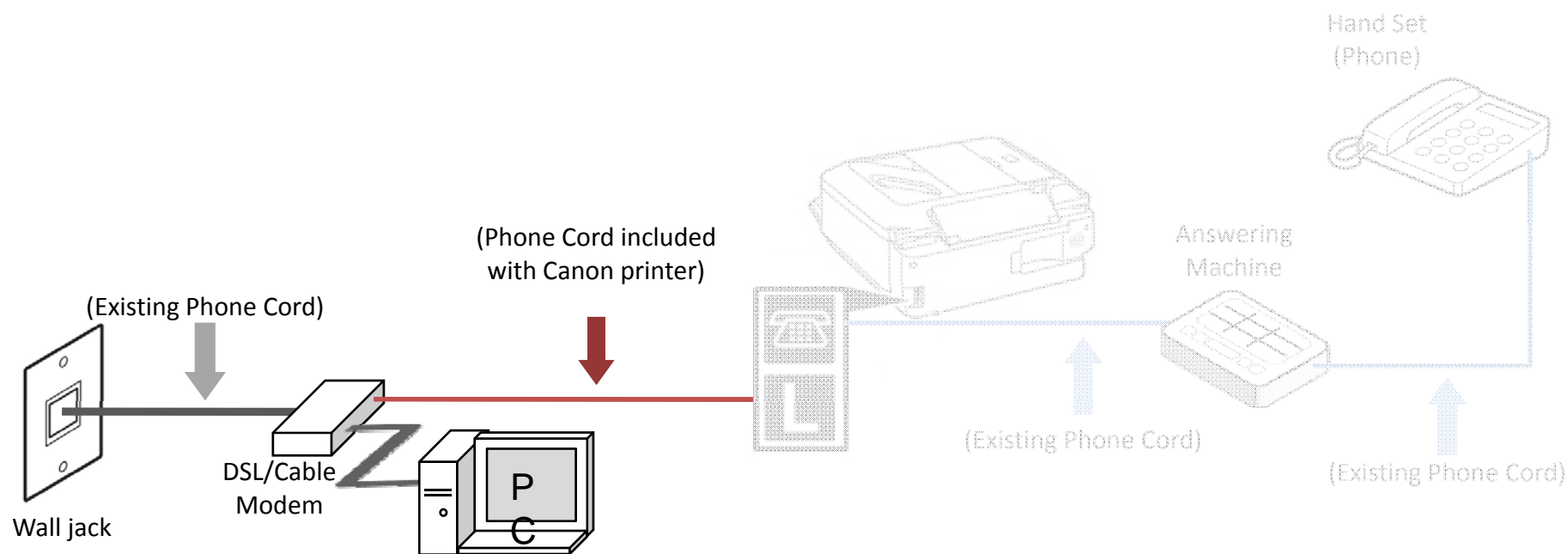

# Fax to Phone Line Connection

- Plug the provided phone cord into the “L” jack in the rear of the multifunction

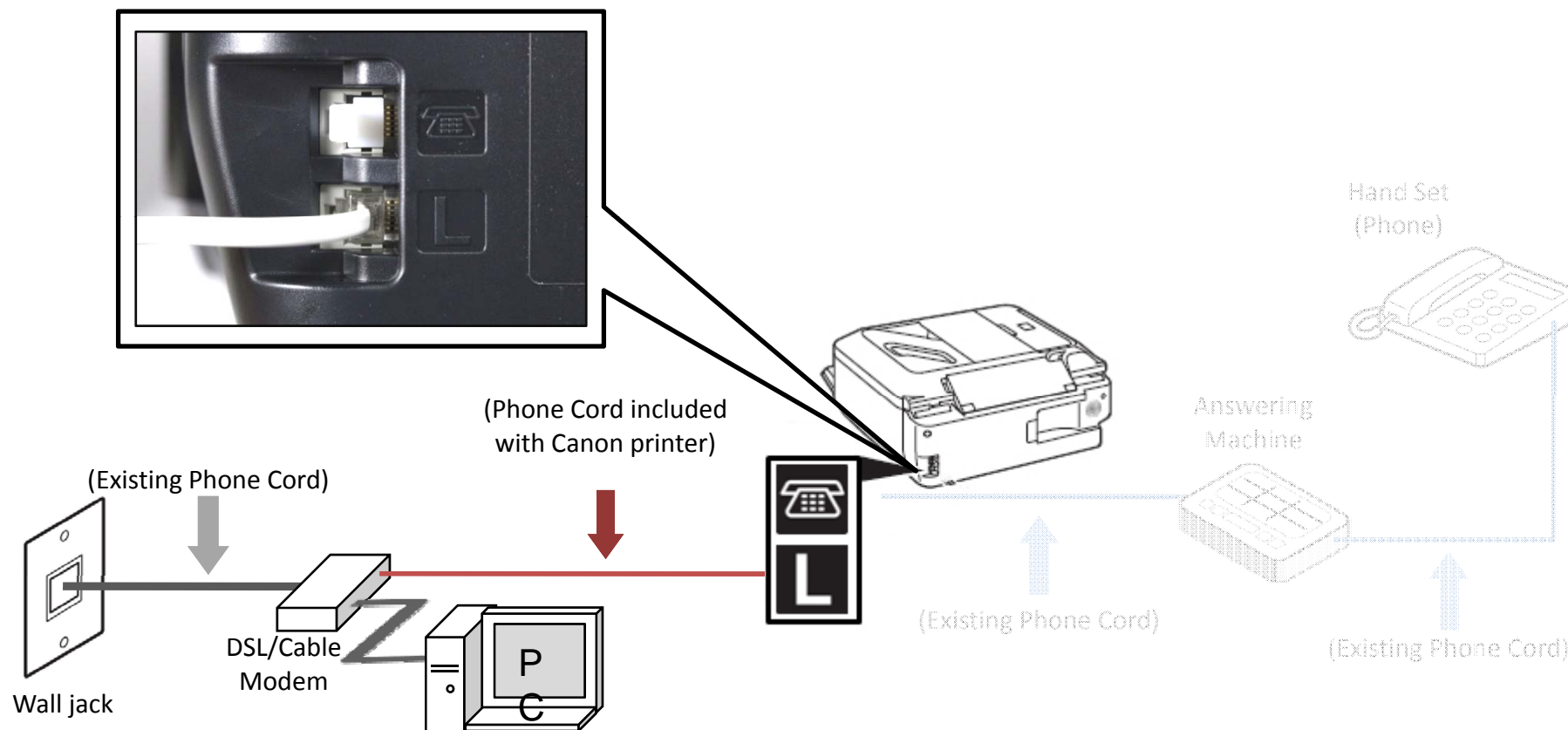

# Fax to Phone Line Connection

- Remove the white plug (D) from the upper jack

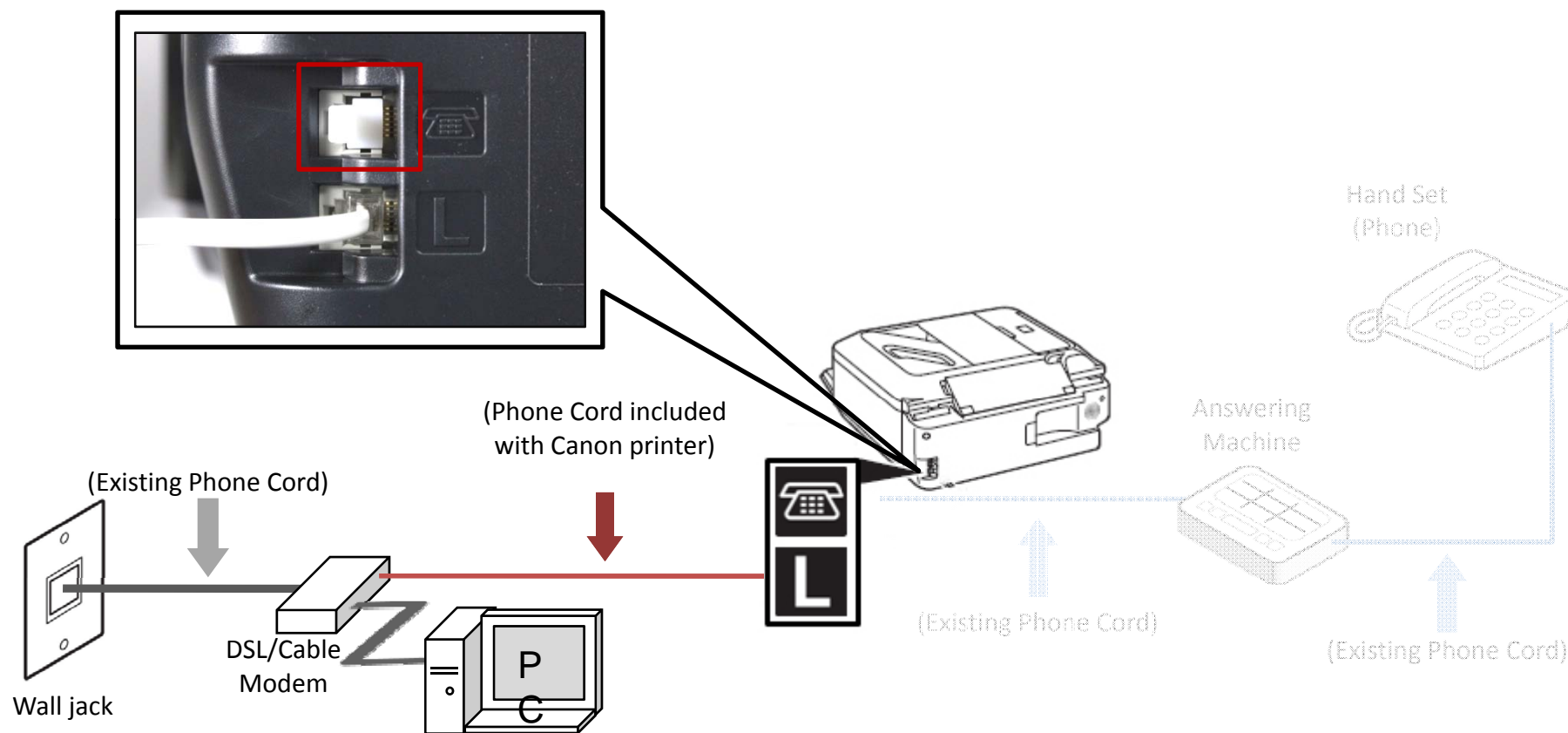

# Fax to Phone Line Connection

- Plug the second phone cord into the “telephone” jack located on the rear of the multifunction

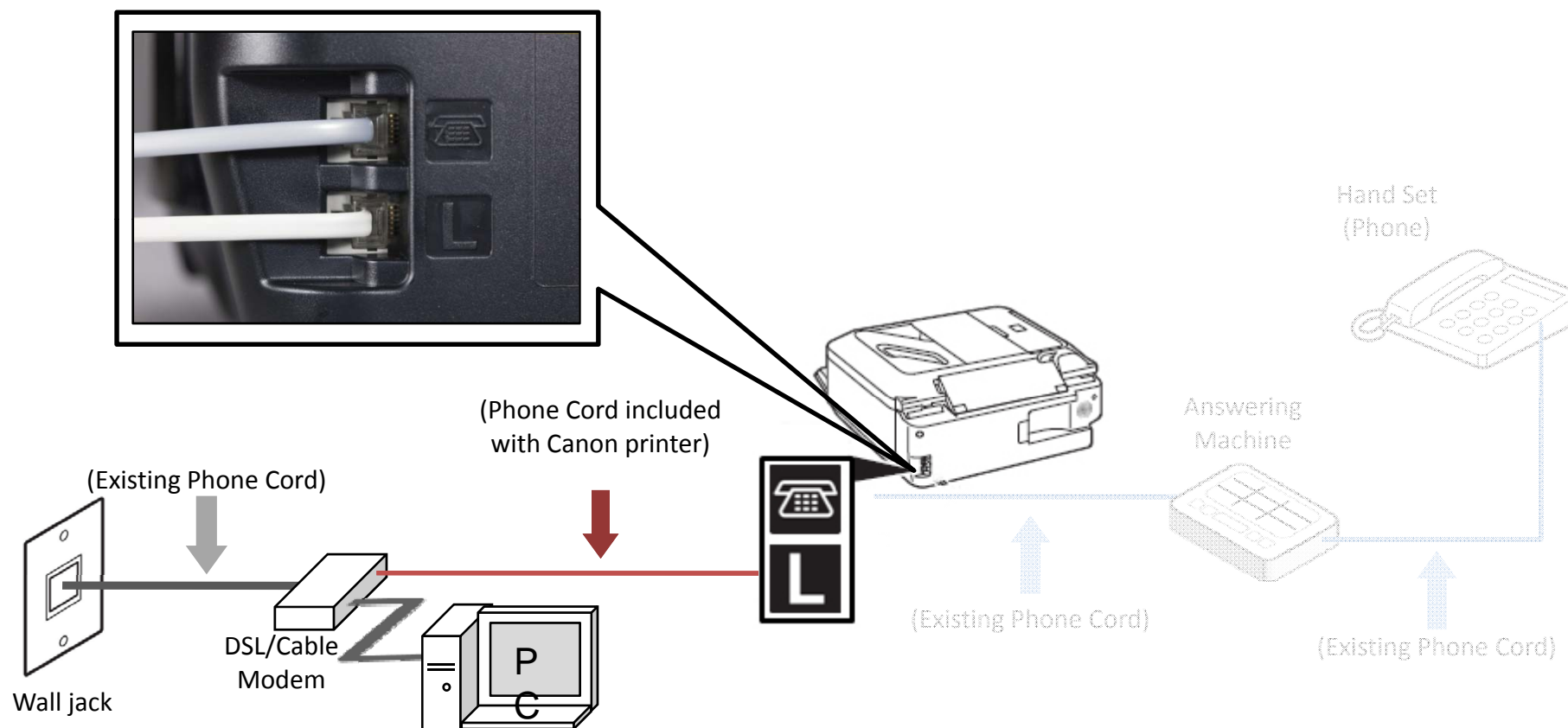



# Fax to Phone Line Connection

- Plug the second phone cord into the answering machine

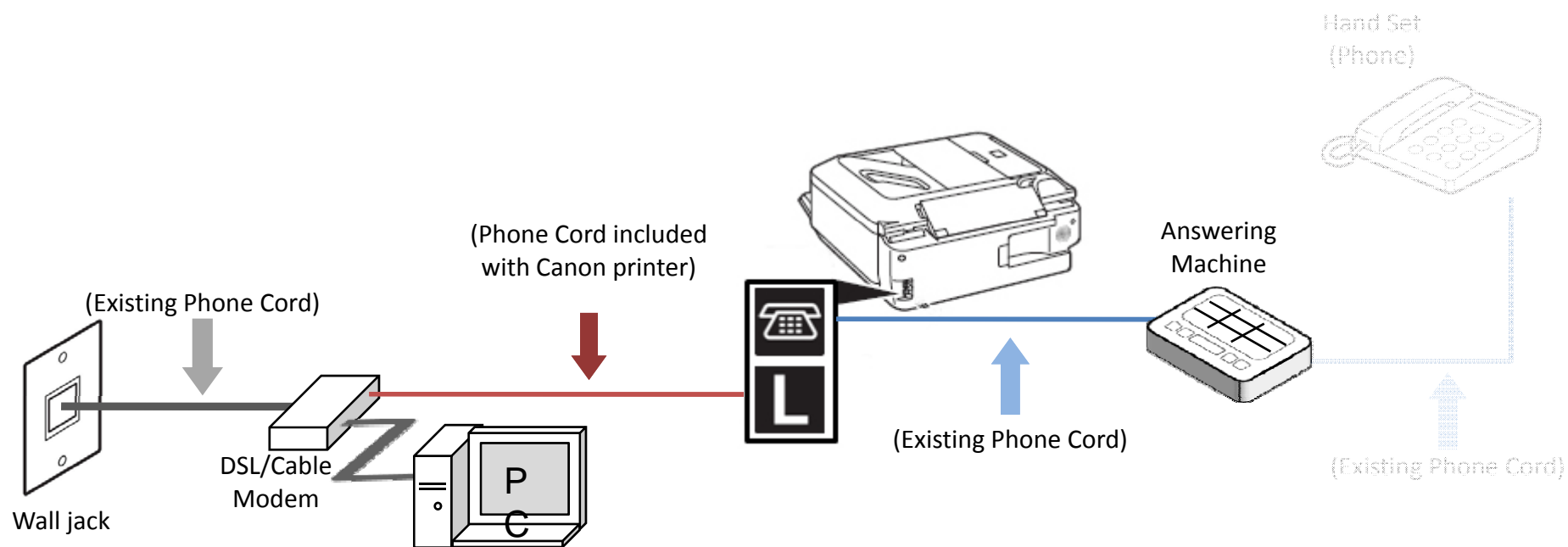

# Fax to Phone Line Connection

- Plug the third phone cord into the answering machine

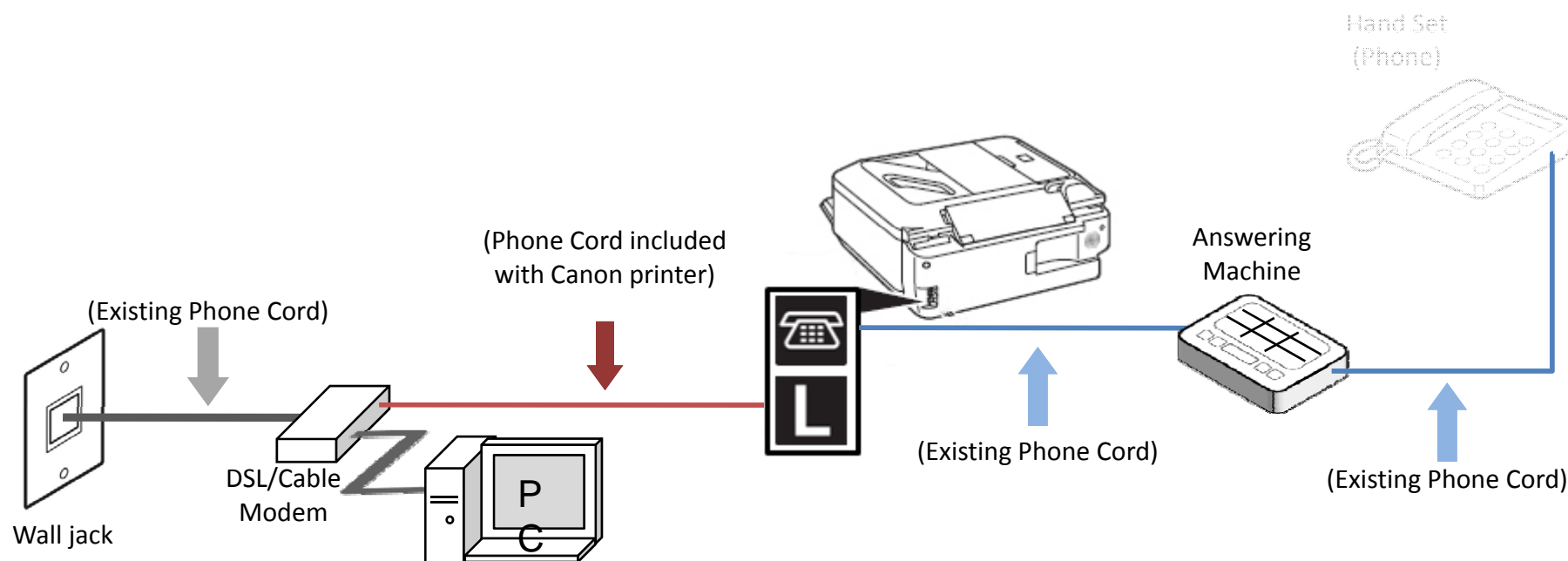

# Fax to Phone Line Connection

- Plug the third phone cord into the phone

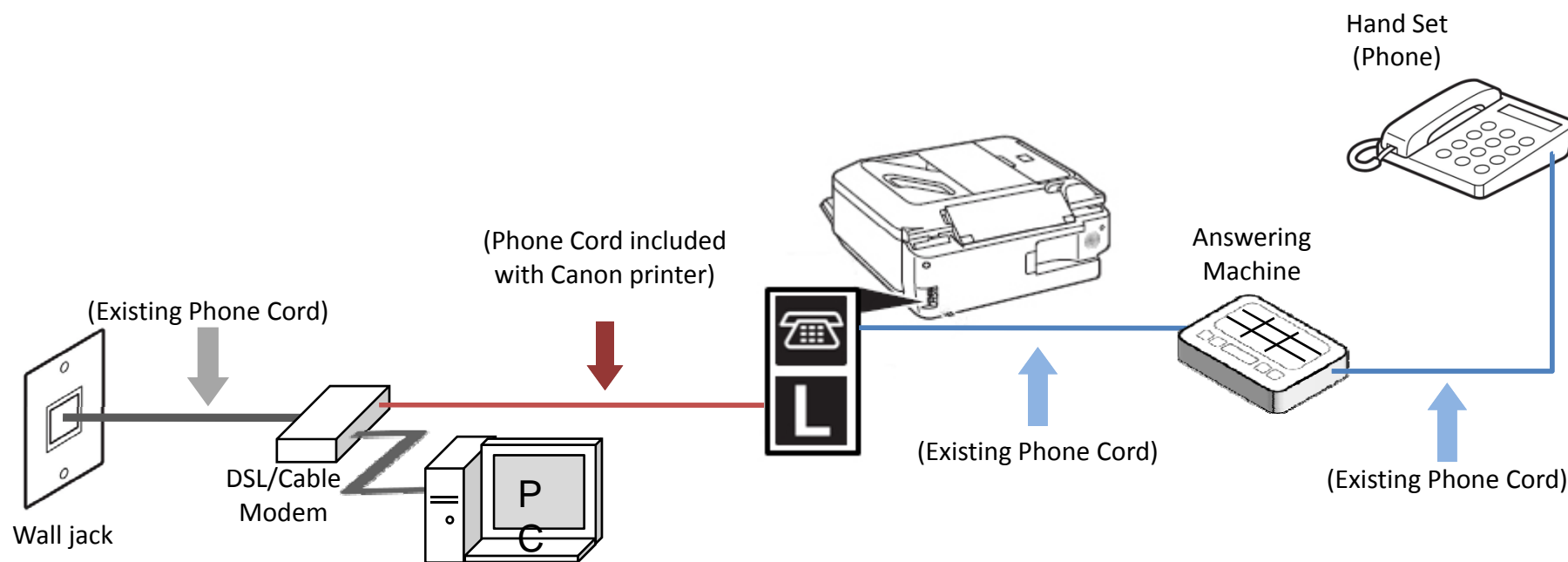

# Fax to Phone Line Connection

## Before

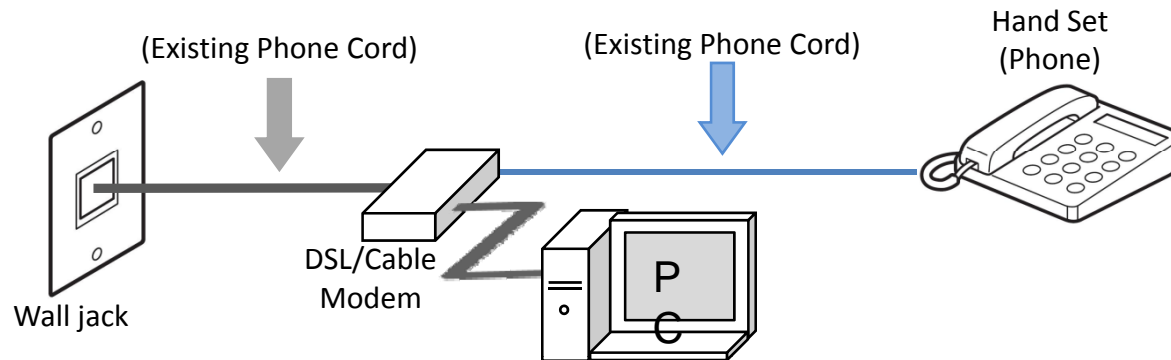

## After

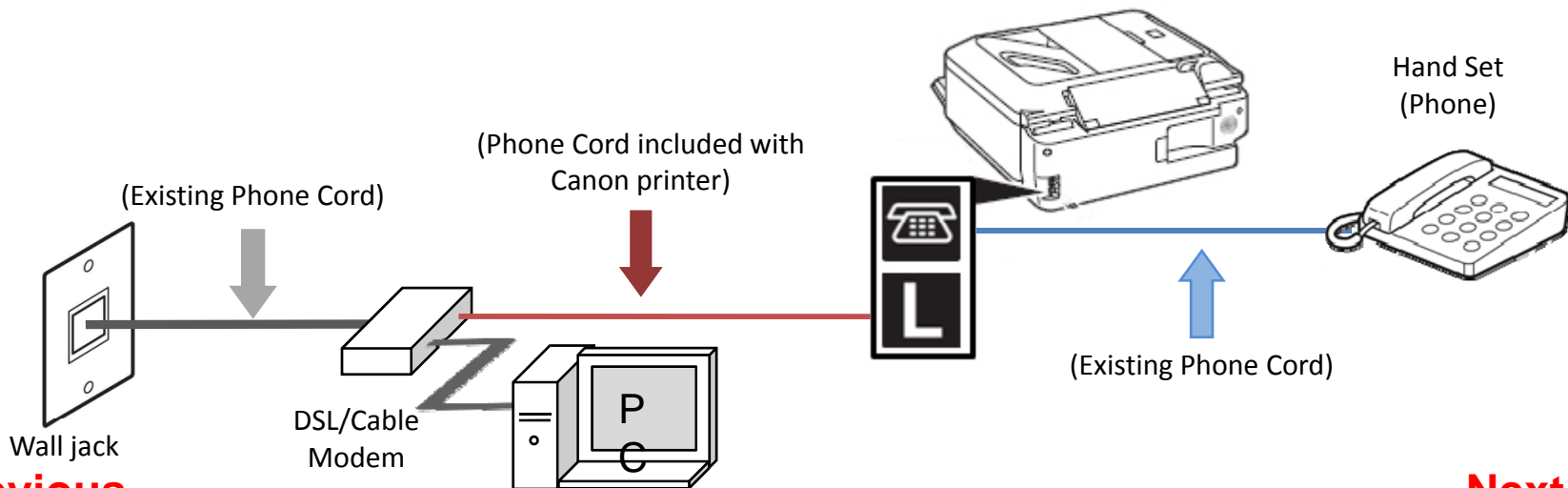

**Previous**

**Next**



# Fax to Phone Line Connection

- Plug the provided phone cord into the DSL/Cable Modem

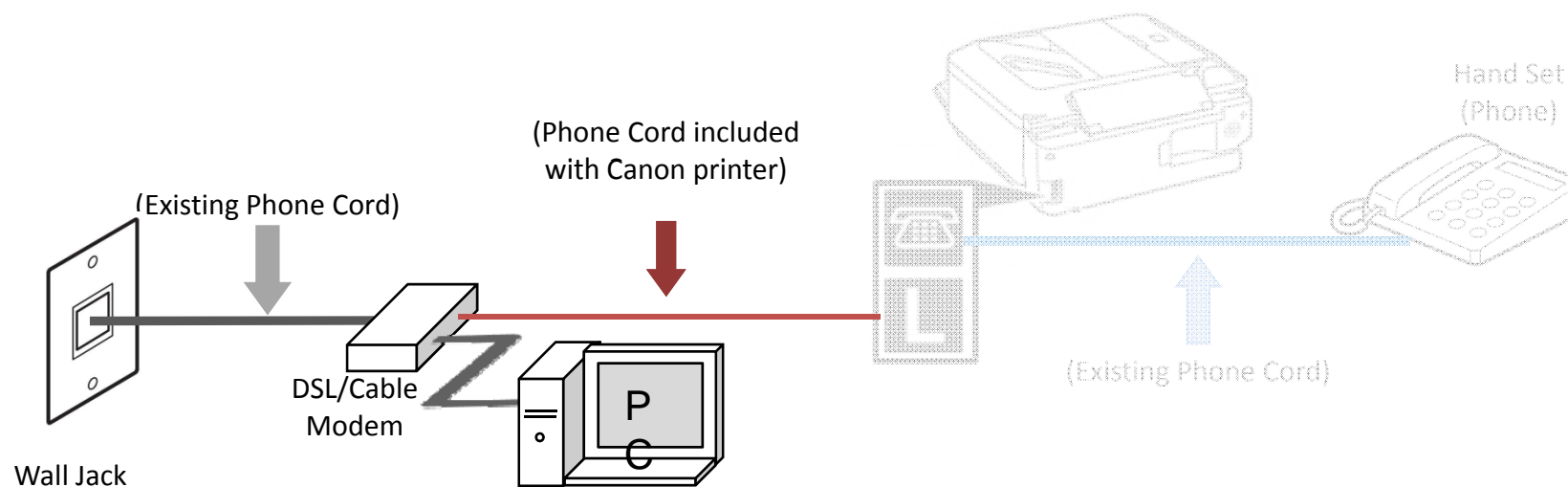

# Fax to Phone Line Connection

- Plug the provided phone cord into the “L” jack in the rear of the multifunction

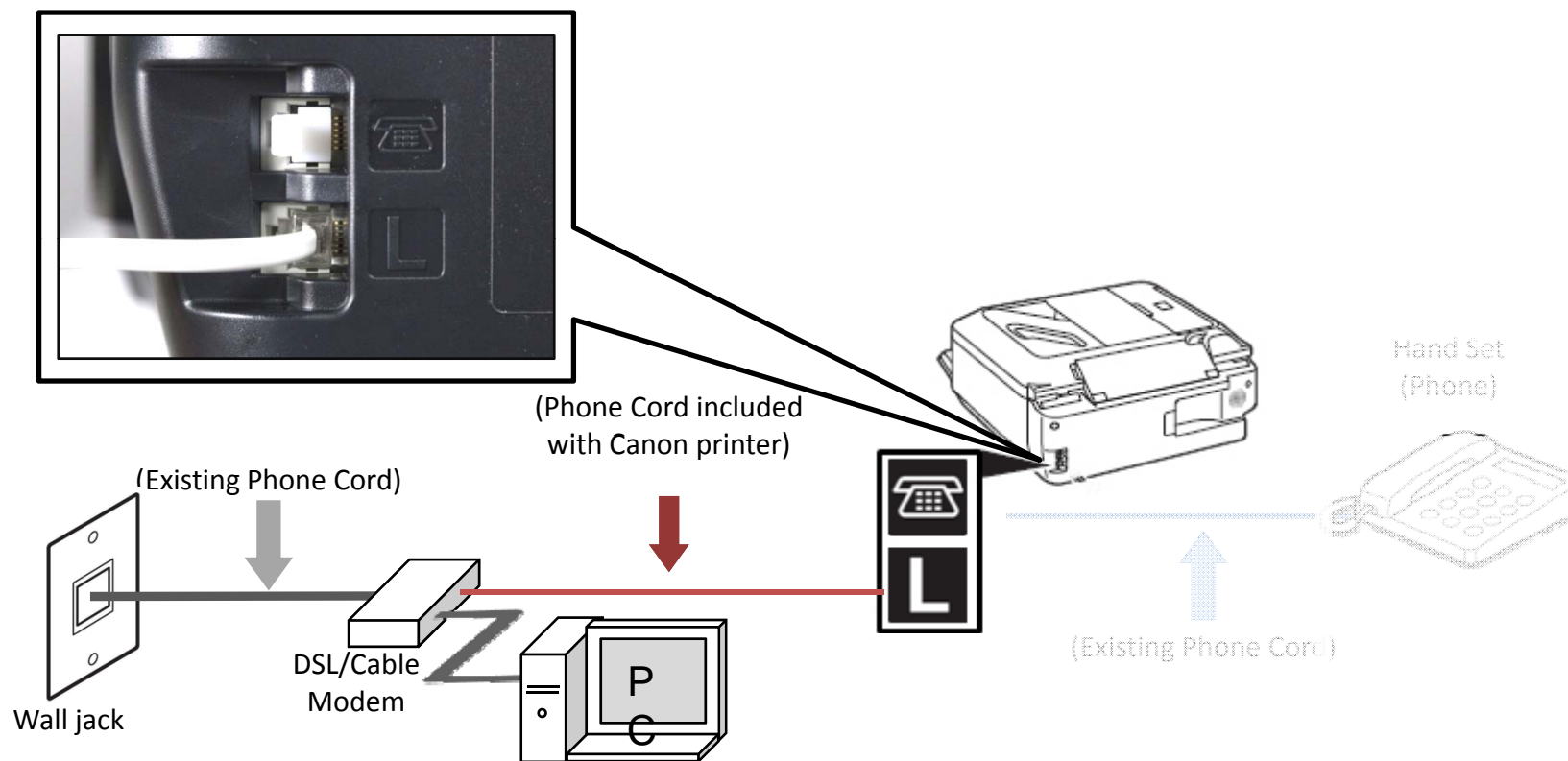

# Fax to Phone Line Connection

- Remove the white plug (D) from the upper jack

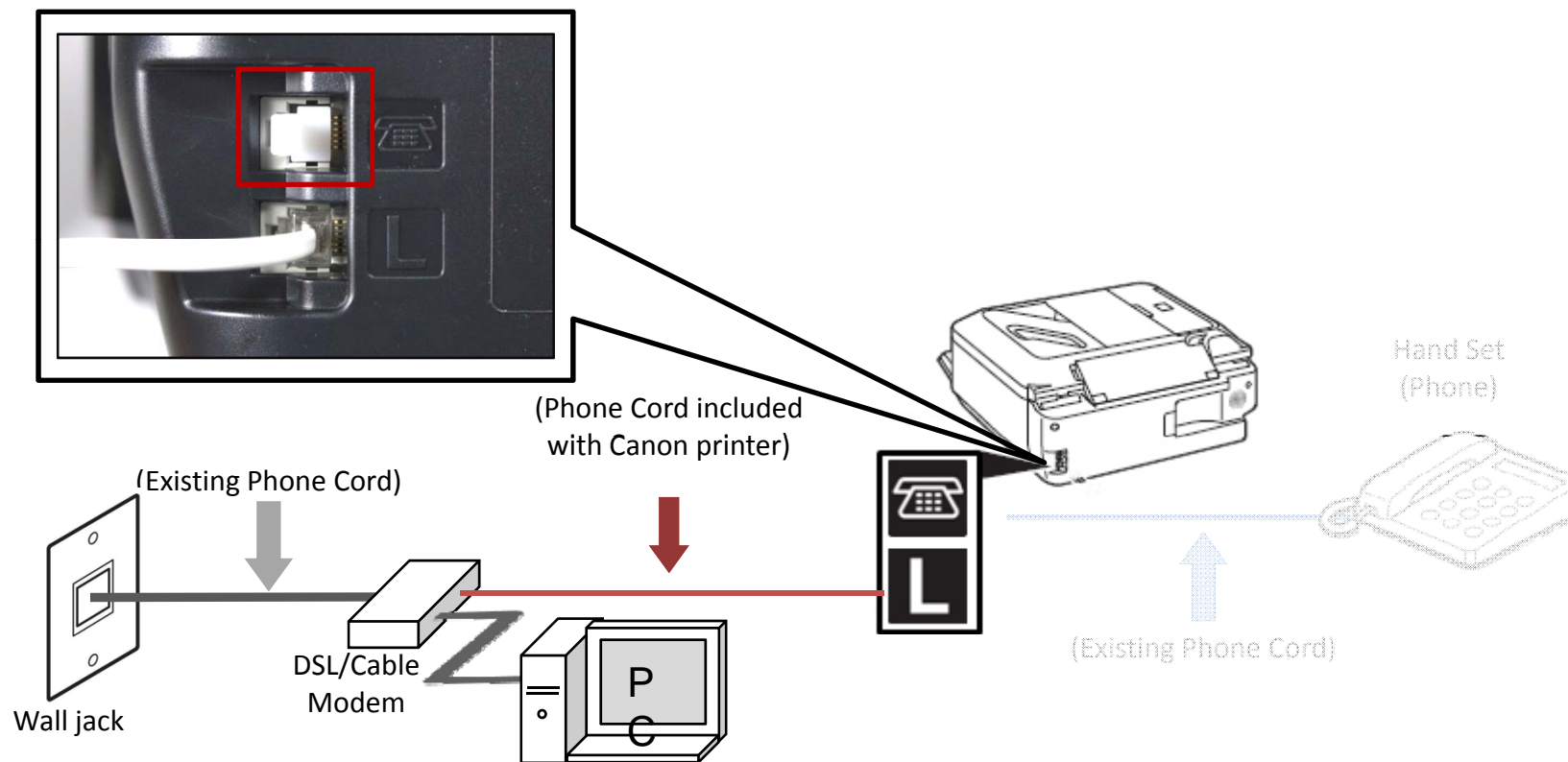

# Fax to Phone Line Connection

- Plug the second phone cord into the “telephone” jack located on the rear of the multifunction

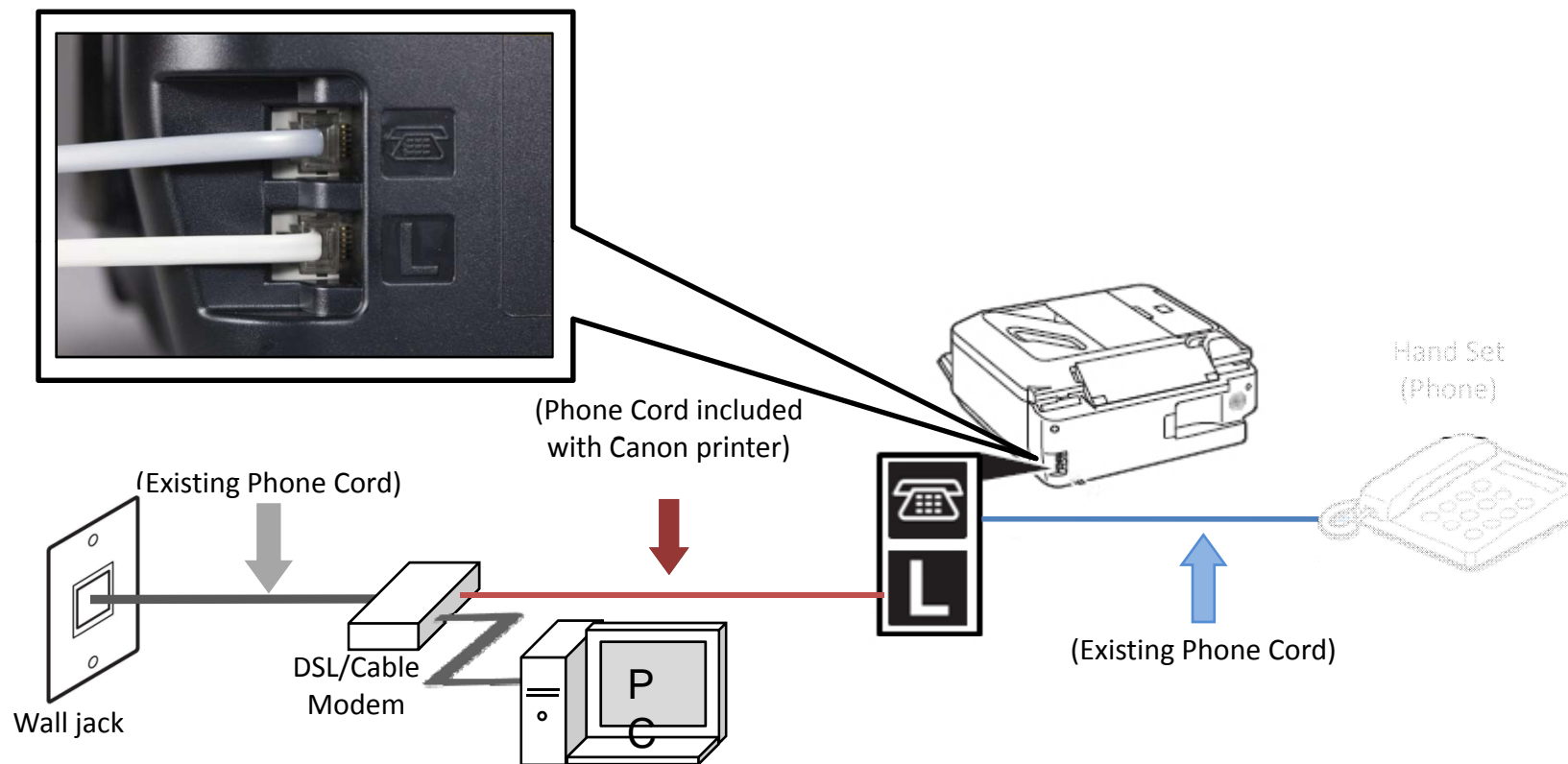



# Fax to Phone Line Connection

- Plug the existing phone cord into the phone

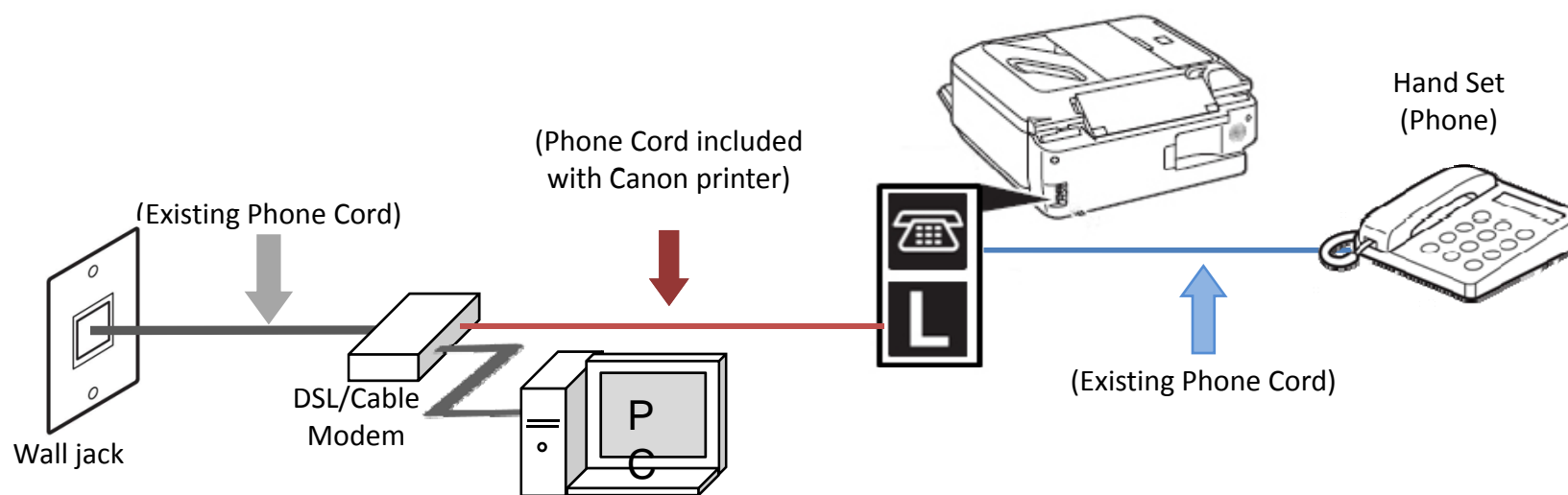



# Setting Up The Receive Mode



**Return To “Connecting Your Phone/Answering Machine”**

**Next**



## Step 1

Turn on the MX330 by pressing the **ON** button.



## Step 2

Press the **FAX** button.



## Step 3

The fax standby screen will appear.

---



## Step 4

Press **Menu** button.

---



## Step 5

The FAX menu will appear.



## Step 6

Press the **OK** button.



## Step 7

The “Receive mode settings” screen will appear.



## Step 8

Use the **UP** or **DOWN** button to select “TEL priority mode”.



## Step 9

Ensure “TEL priority mode” is selected



## Step 10

Press the **OK** button

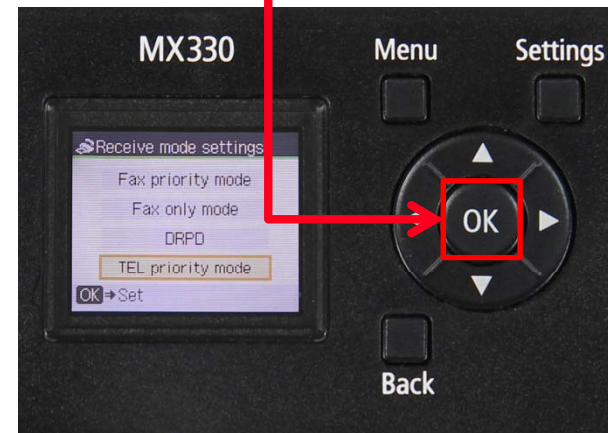



## Step 11

The FAX menu will appear.



## Step 12

Press the **FAX** button.





## Step 13

Your MX330 is now set to TEL priority mode. Notice that the mode is listed on the fax standby screen.



# Receiving A Fax

To receive a fax when you are home you will:

- Pick up the handset on the phone connected to the MX330.
- Listen for fax tones.
- When the tones stop hang up the handset.
- The MX330 will receive the fax document.

To receive a fax while you are away:

- The answering machine will answer the call.
- If fax tones are heard by the MX330 it will take over the call and receive the fax document.

**IMPORTANT:** In order to receive a fax, you must either pick up the handset on a phone that is connected to the MX330 or let your answering machine answer the call.

