



Setting Up Your MX320 In Default Mode (Tel Priority Mode) With An Answering Machine DSL/Cable Modem Connection





Connecting The Phone Lines



Previous

Next



Connecting Your Phone/Answering Machine

Is your answering machine built into your phone?

YES

[Click Here or Go To Page 12](#)

NO

Click the Next Button

 **Previous**

Next 

Fax to Phone Line Connection

Before

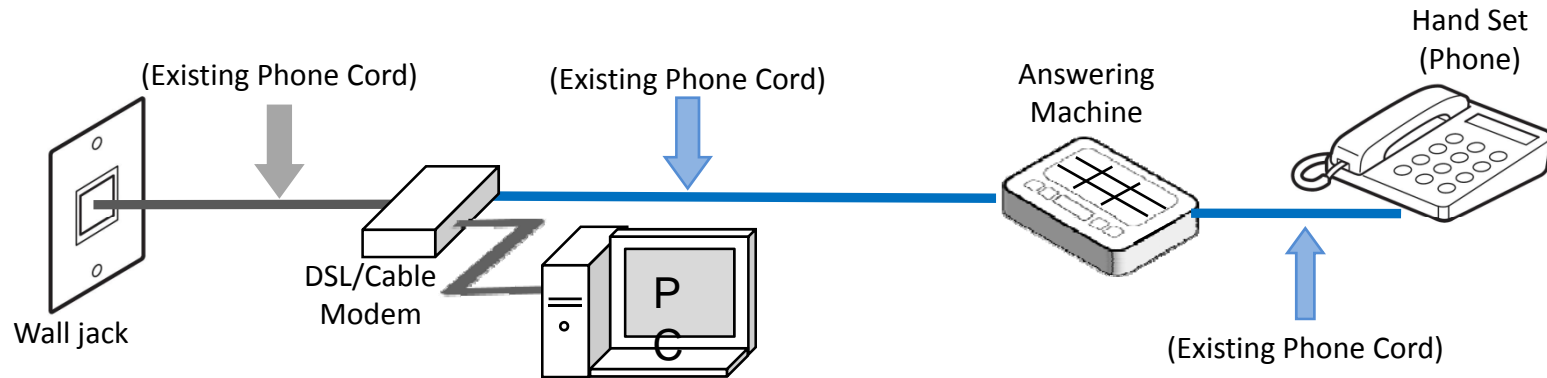

After

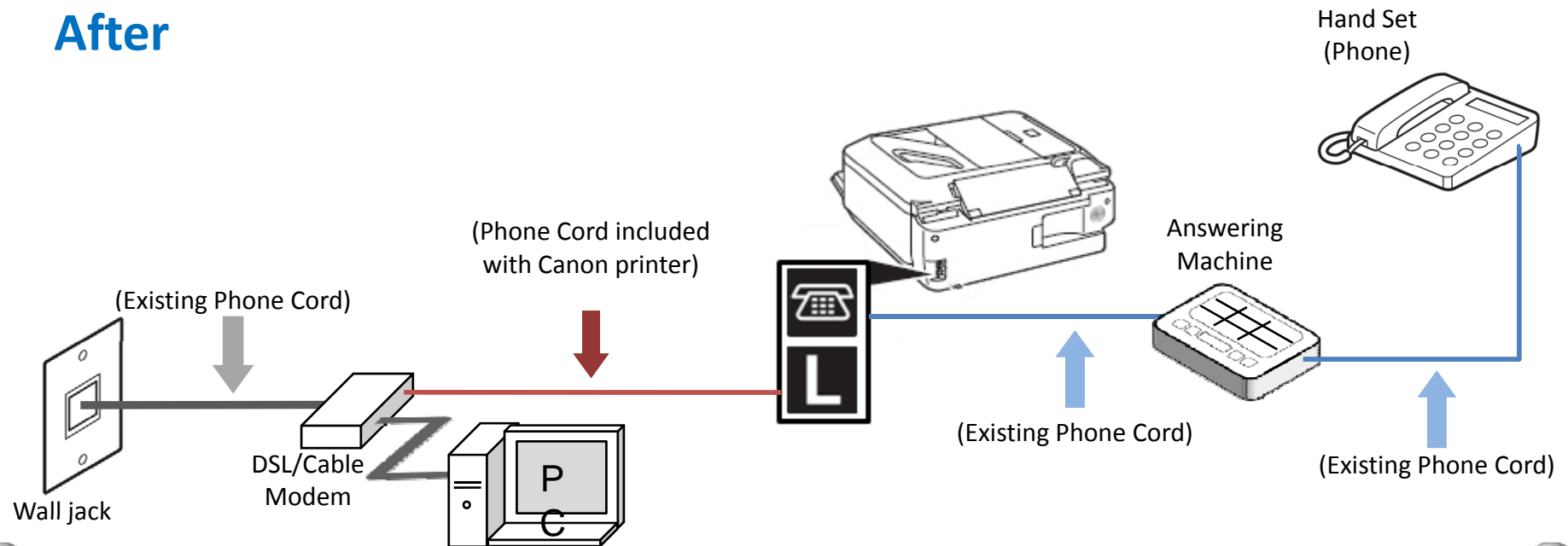

 **Previous**

Next 

Fax to Phone Line Connection

- Plug the provided phone cord into the DSL/Cable Modem

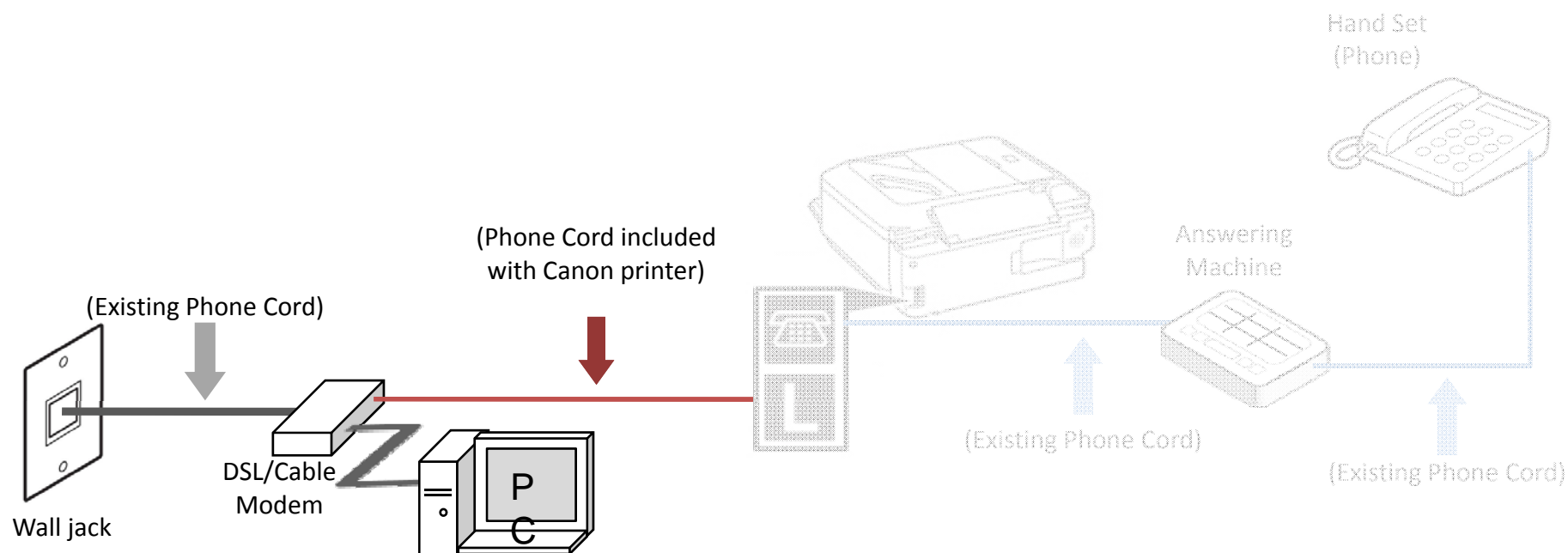

Fax to Phone Line Connection

- Plug the provided phone cord into the “L” jack in the rear of the multifunction

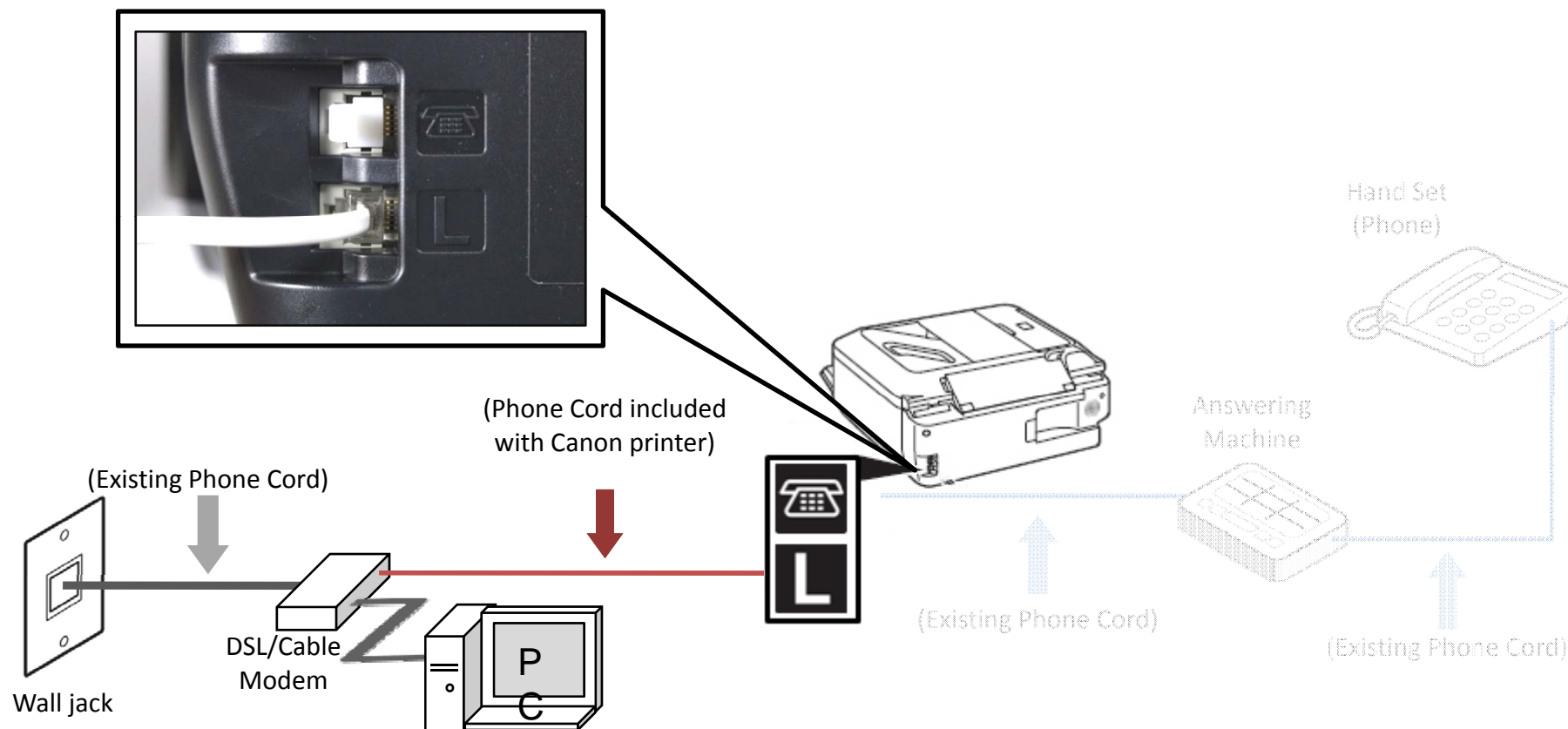

Fax to Phone Line Connection

- Remove the white plug (D) from the upper jack

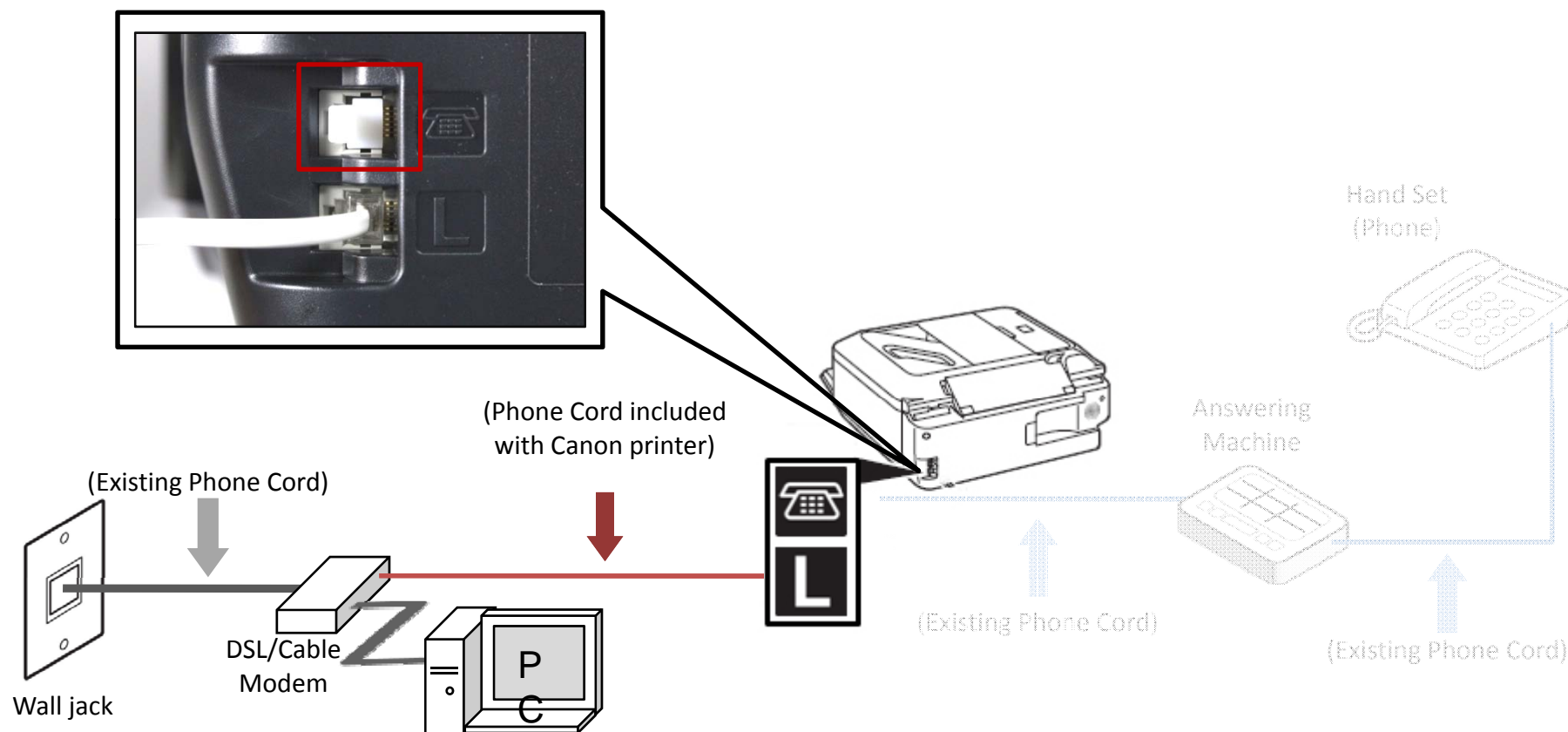

Fax to Phone Line Connection

- Plug the second phone cord into the “telephone” jack located on the rear of the multifunction

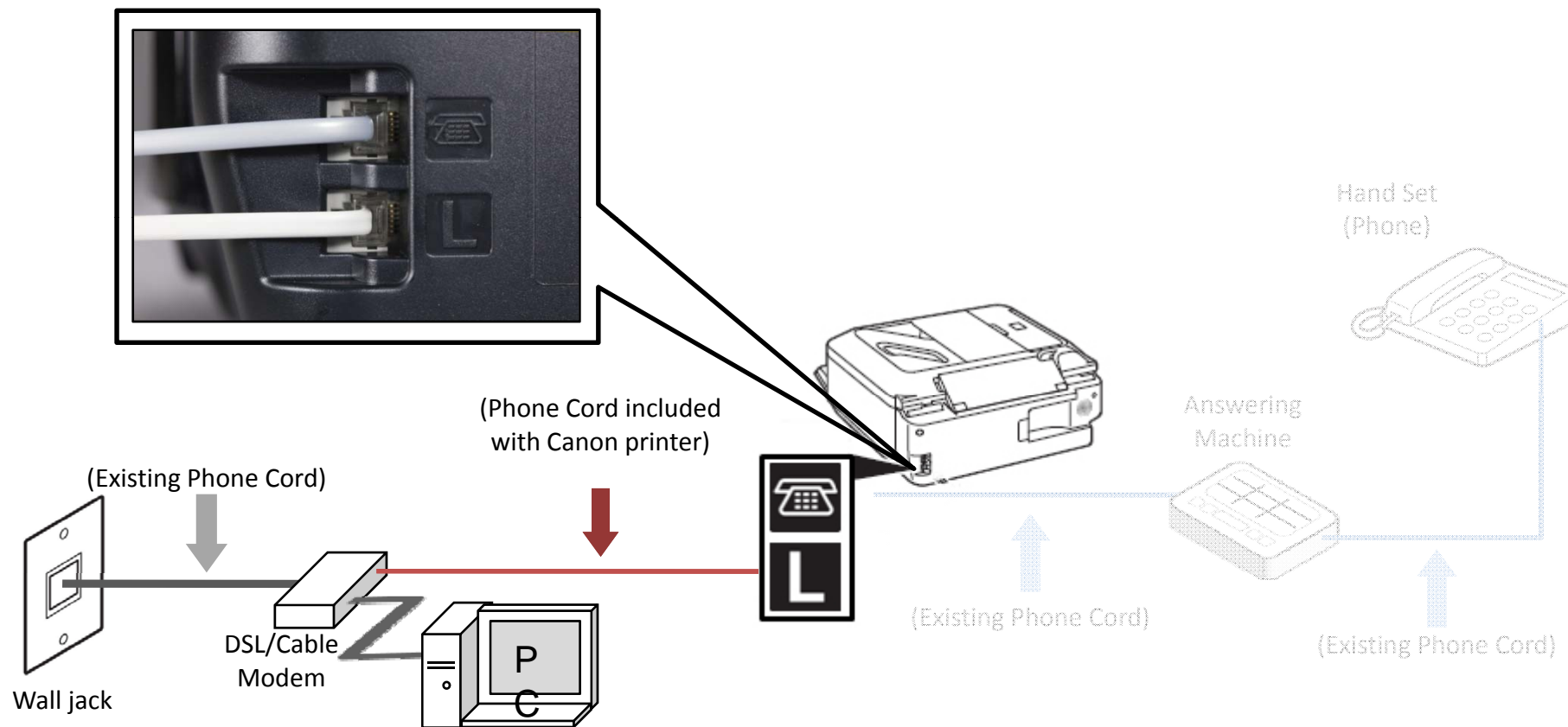

Fax to Phone Line Connection

- Plug the second phone cord into the answering machine

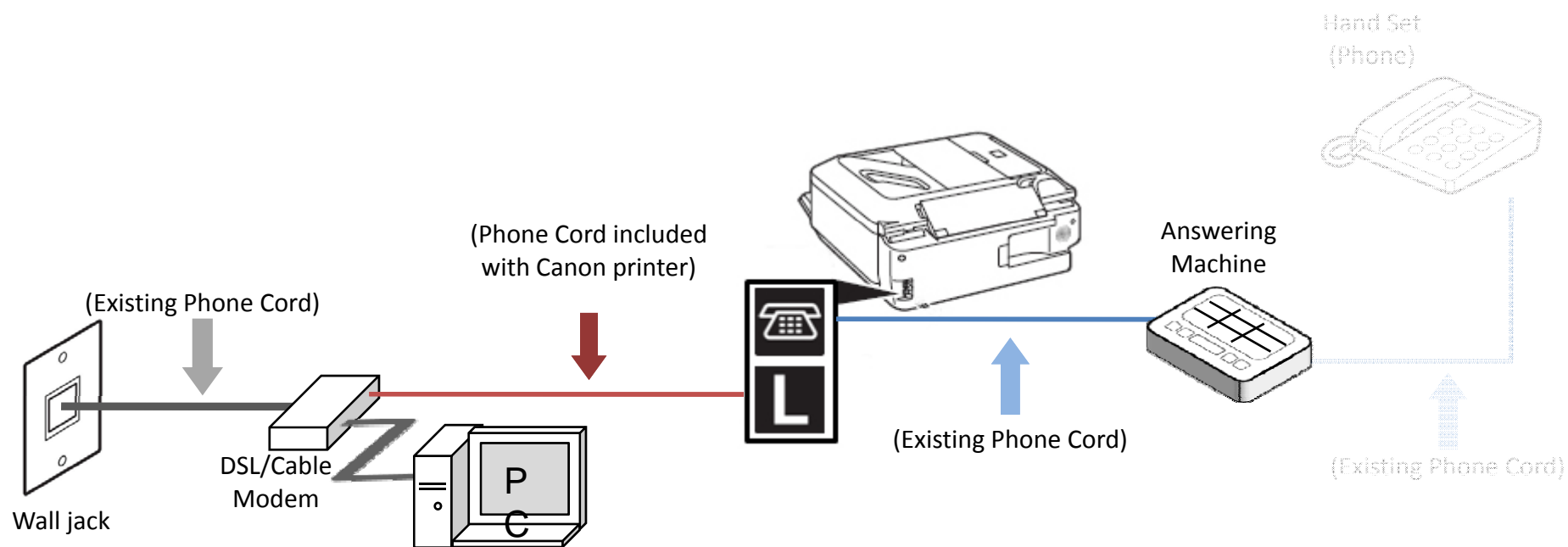

Fax to Phone Line Connection

- Plug the third phone cord into the answering machine

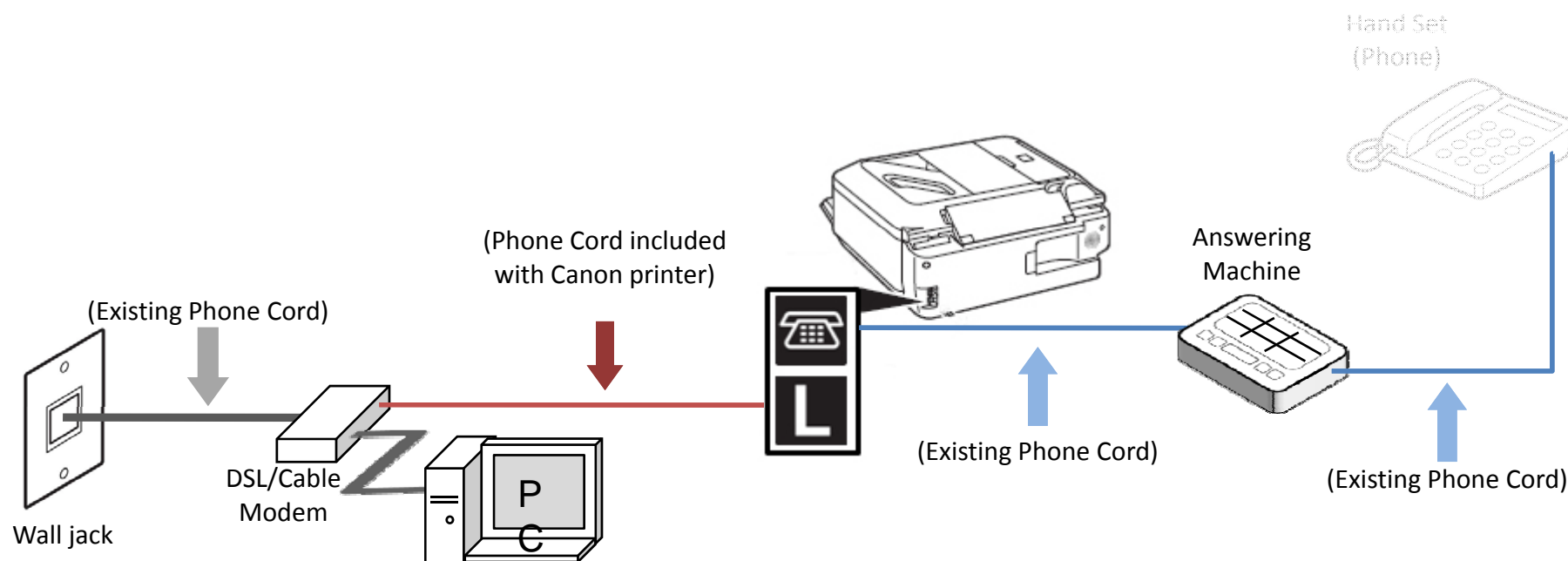

Fax to Phone Line Connection

- Plug the third phone cord into the phone

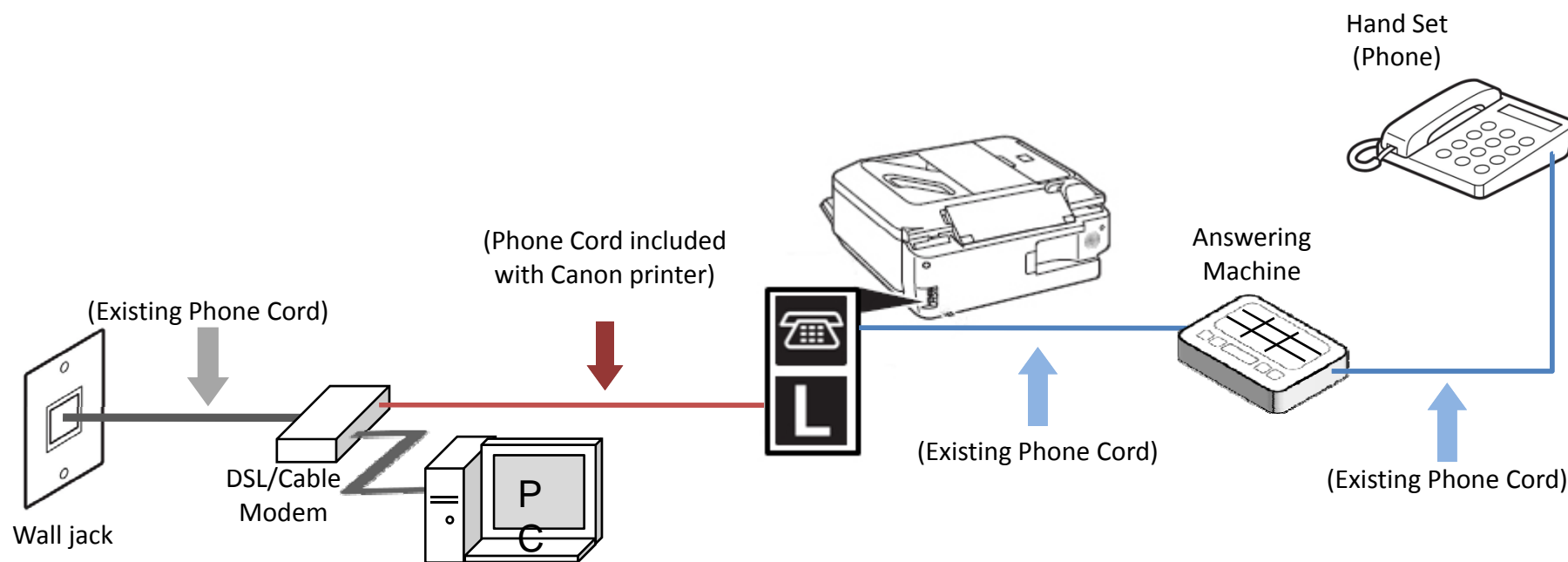

Fax to Phone Line Connection

Before

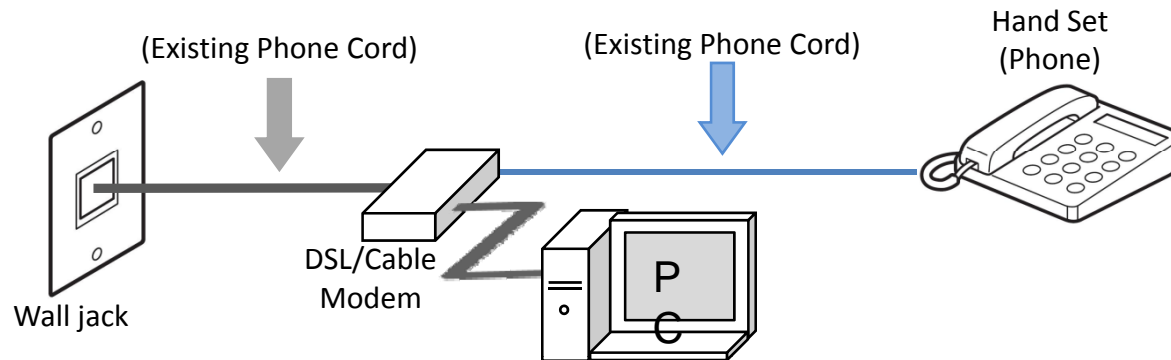

After

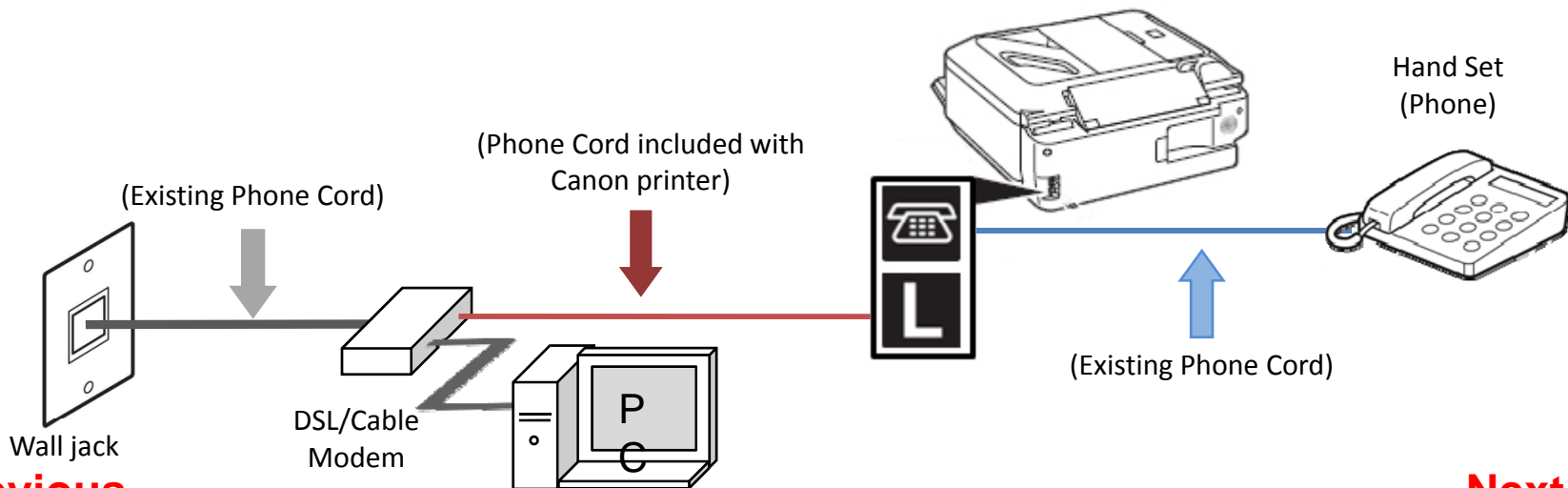

Previous

Next



Fax to Phone Line Connection

- Plug the provided phone cord into the DSL/Cable Modem

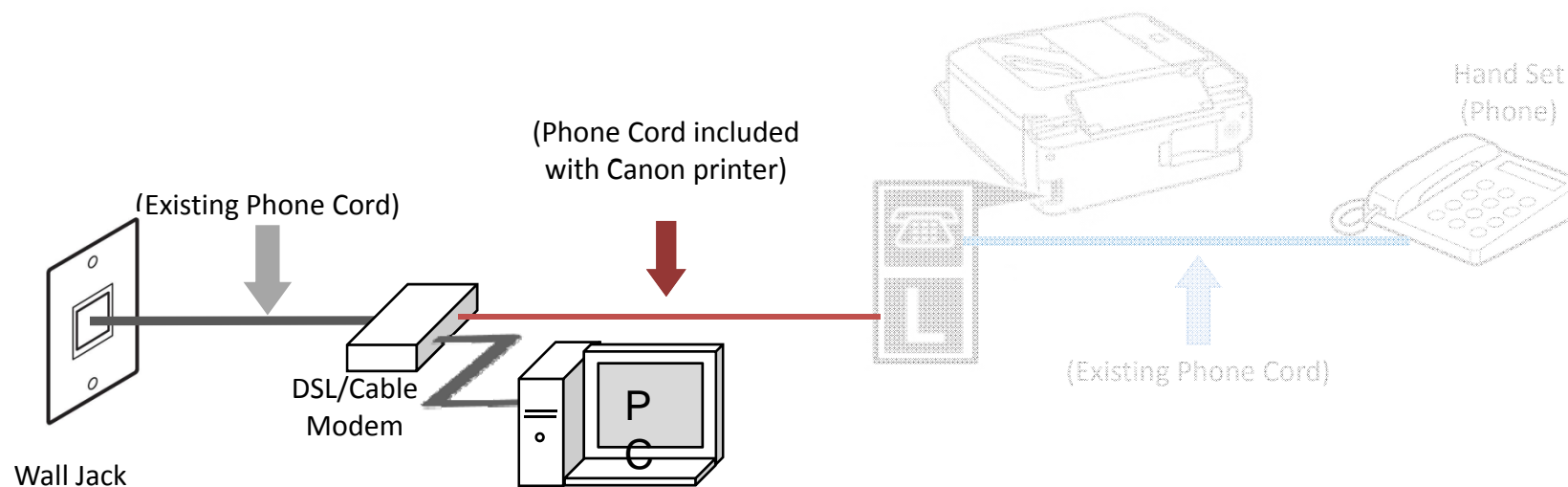

Fax to Phone Line Connection

- Plug the provided phone cord into the “L” jack in the rear of the multifunction

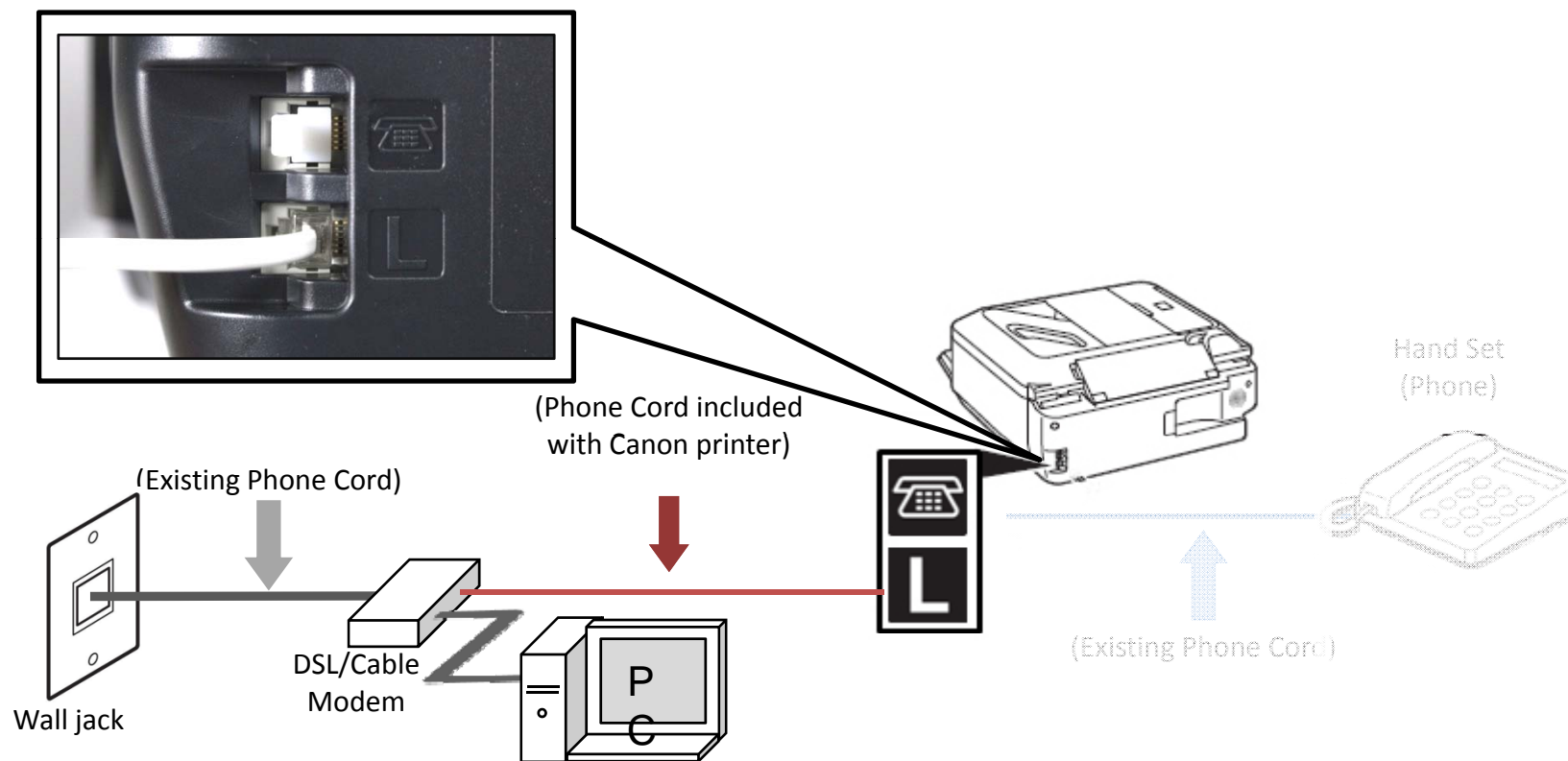

Fax to Phone Line Connection

- Remove the white plug (D) from the upper jack

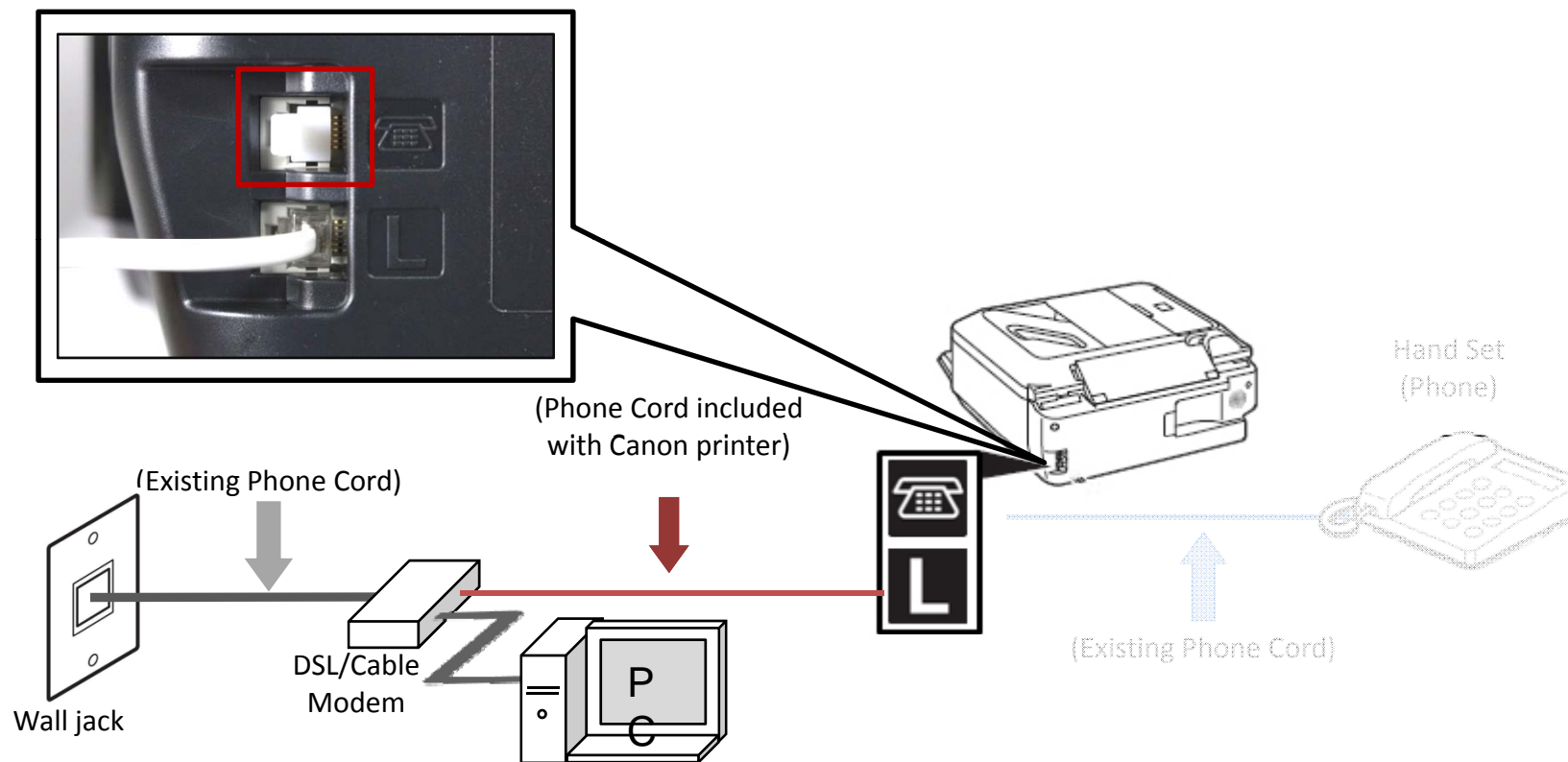

Fax to Phone Line Connection

- Plug the second phone cord into the “telephone” jack located on the rear of the multifunction

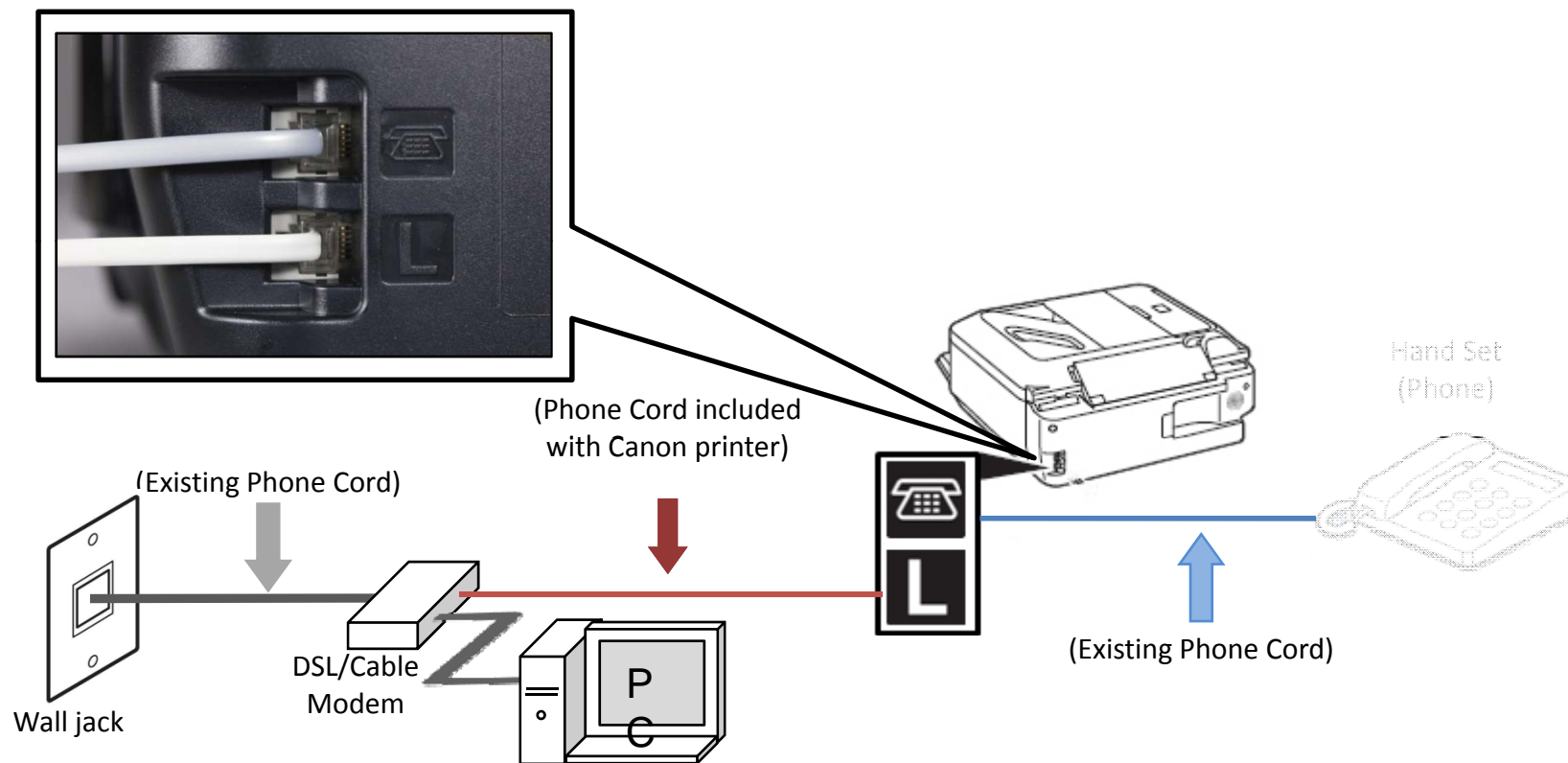

Previous

Next



Fax to Phone Line Connection

- Plug the existing phone cord into the phone

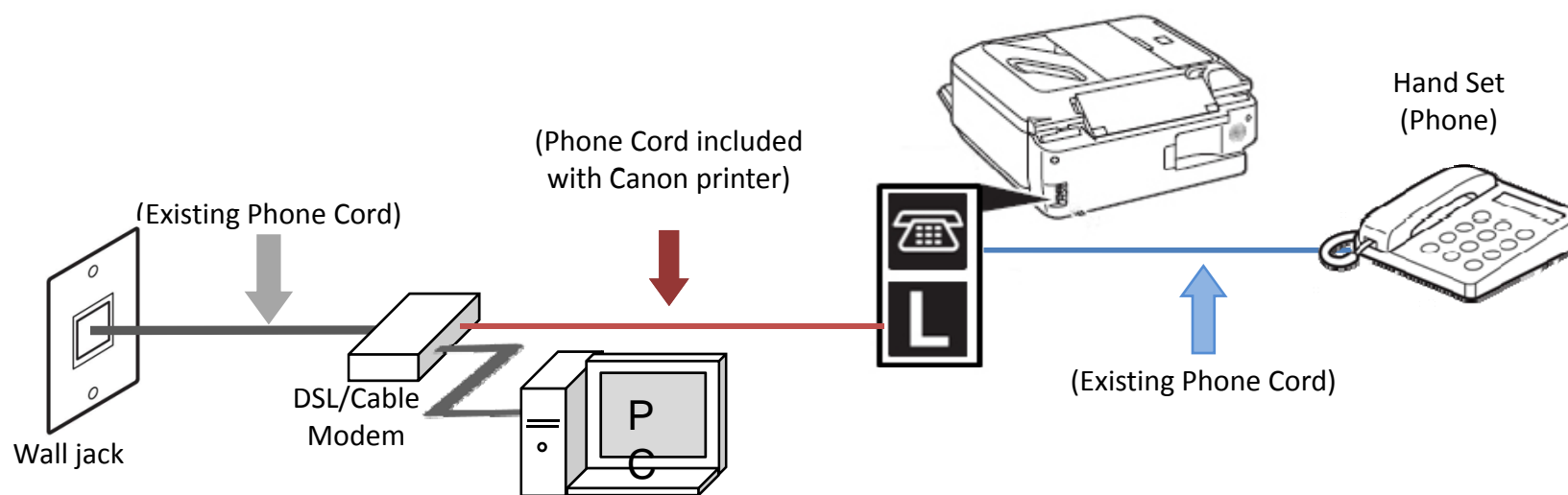



Setting Up The Receive Mode



Return To “Connecting Your Phone/Answering Machine”

Next



Step 1

Turn on the MX320 by pressing the **ON** button.



Step 2

Press the **FAX** button.



Step 3

The fax standby screen will appear.



Step 4

Press **Menu** button.



Step 5

The Fax settings menu will appear.



Step 6

Press the **OK** button.



Step 7

The “Receive mode set.” screen will appear.



Step 8

Use the **LEFT** or **RIGHT** button to select “TEL priority mode”.

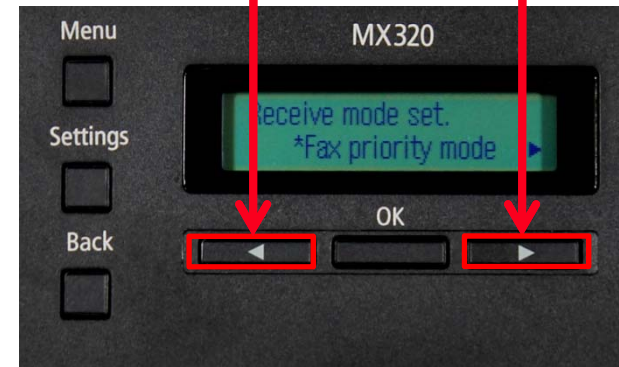

Step 9

Ensure “TEL priority mode” is selected



Step 10

Press the **OK** button



Step 11

Your MX320 is now set to TEL priority mode. Notice that the mode is listed on the fax standby screen.

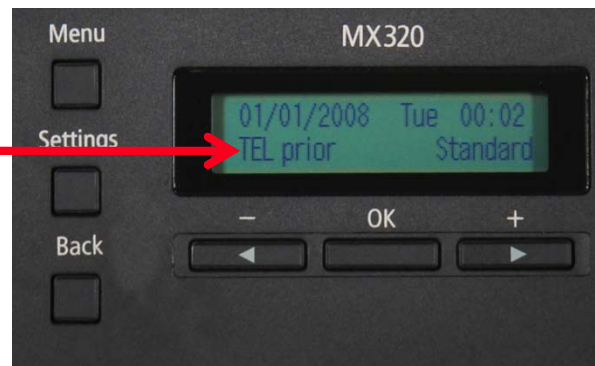

Receiving A Fax

To receive a fax when you are home you will:

- Pick up the handset on the phone connected to the MX320.
- Listen for fax tones.
- When the tones stop hang up the handset.
- The MX320 will receive the fax document.

To receive a fax while you are away:

- The answering machine will answer the call.
- If fax tones are heard by the MX320 it will take over the call and receive the fax document.

IMPORTANT: In order to receive a fax, you must either pick up the handset on a phone that is connected to the MX320 or let your answering machine answer the call.

