



# Distinctive Ring Pattern Detection (DRPD) Fax Line Setup Guide



# Fax Easy Setup

Click [Next](#) to step through this image-friendly version of **Fax Easy Setup**.

---

If you started **Fax Easy Setup**, on the fax machine's operation panel, and prefer to go through this image-friendly version...

## Step 1

Press the **FAX** button at any screen to go to fax standby mode.

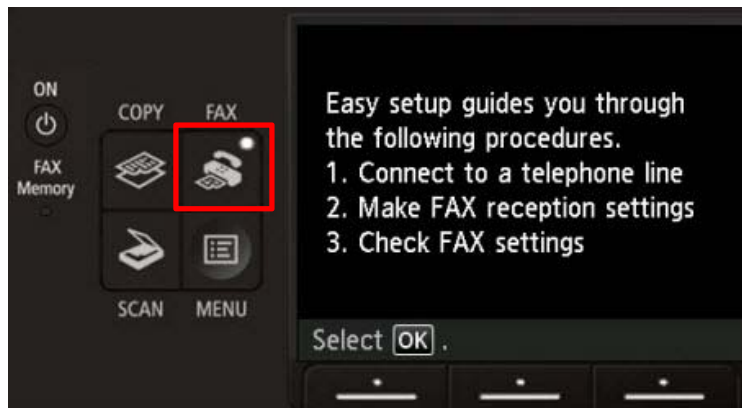

## Step 2

Click [Next](#) to proceed through the setup.

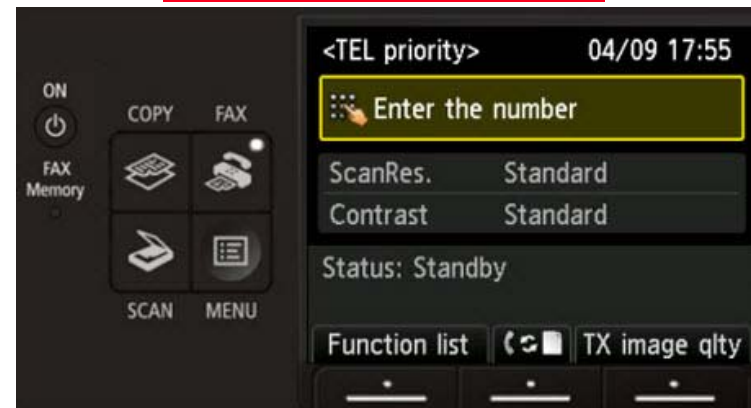



# Connecting The Phone Lines



# Fax to Phone Line Connection

**Before**

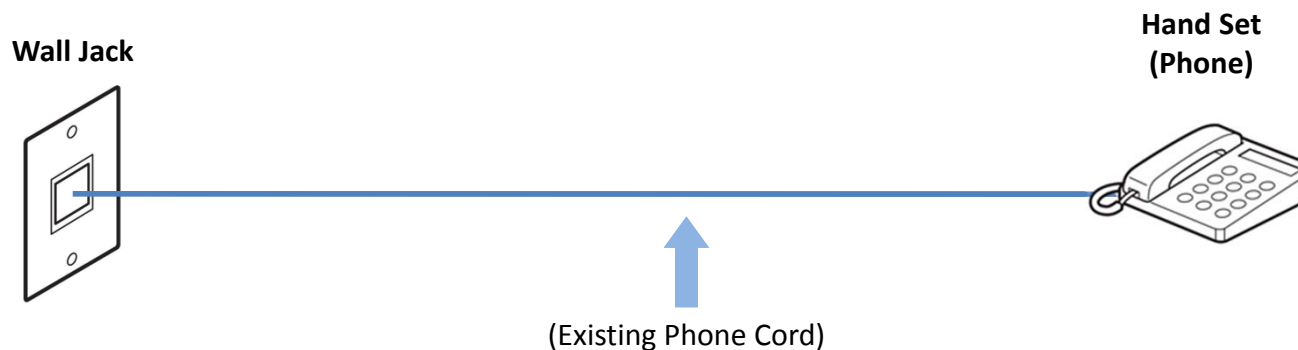

**After**

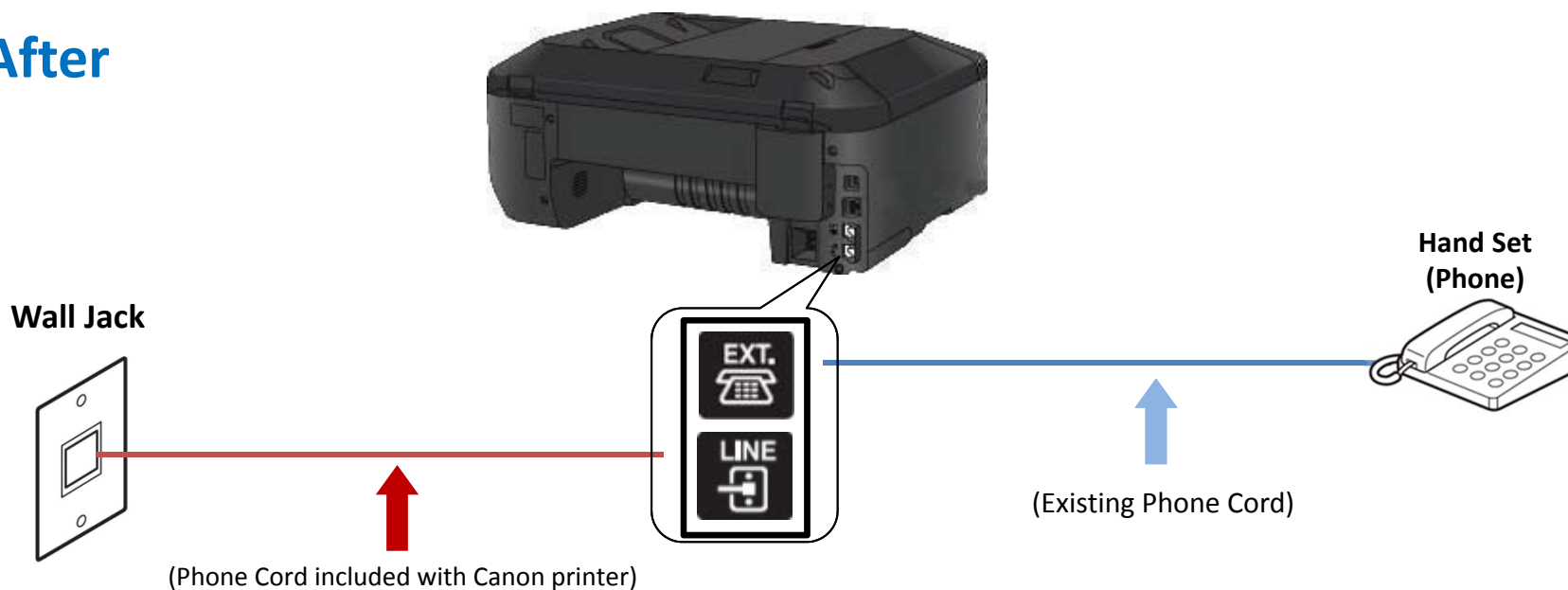

 **Previous**

**Next** 

# Fax to Phone Line Connection

- Plug the provided phone cord into the wall jack

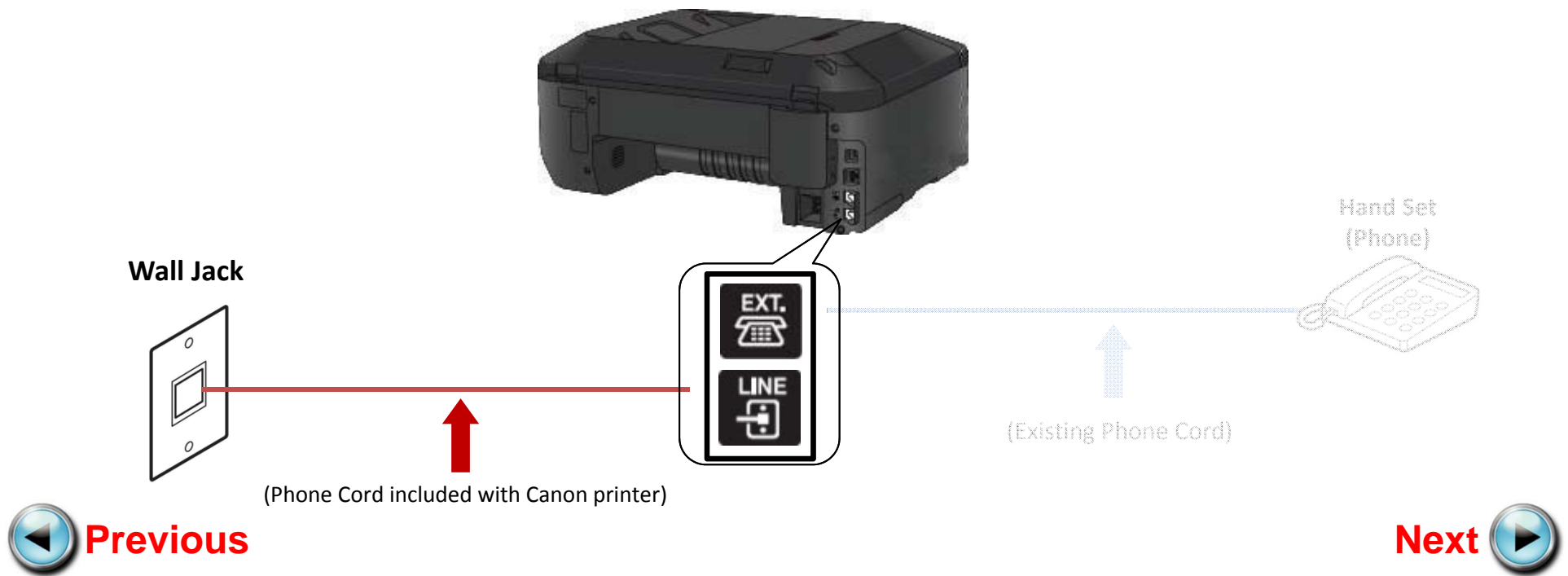

# Fax to Phone Line Connection

- Plug the provided phone cord into the “LINE” jack located on the rear of the multifunction

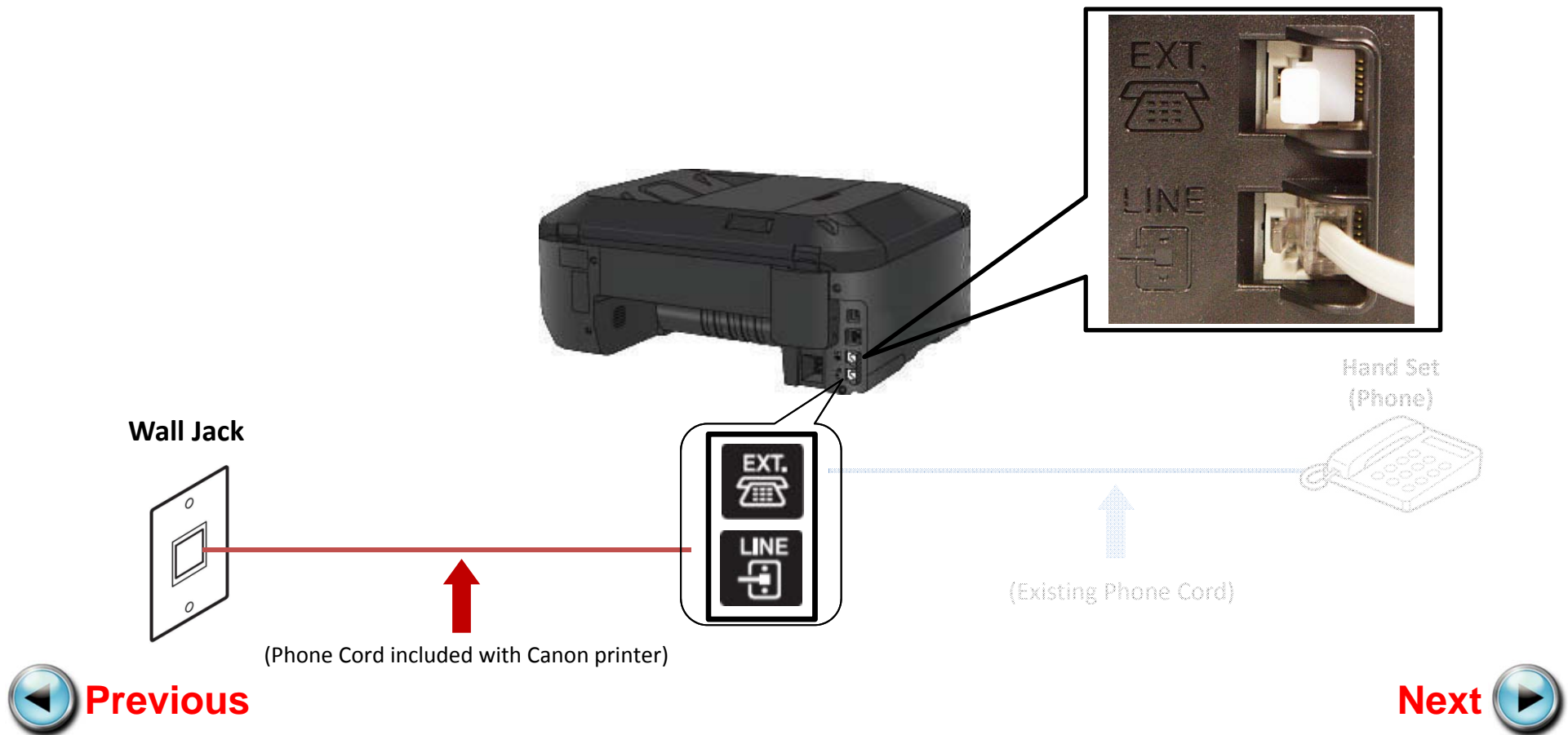

# Fax to Phone Line Connection

- Remove the white plug from the upper jack labeled "EXT."

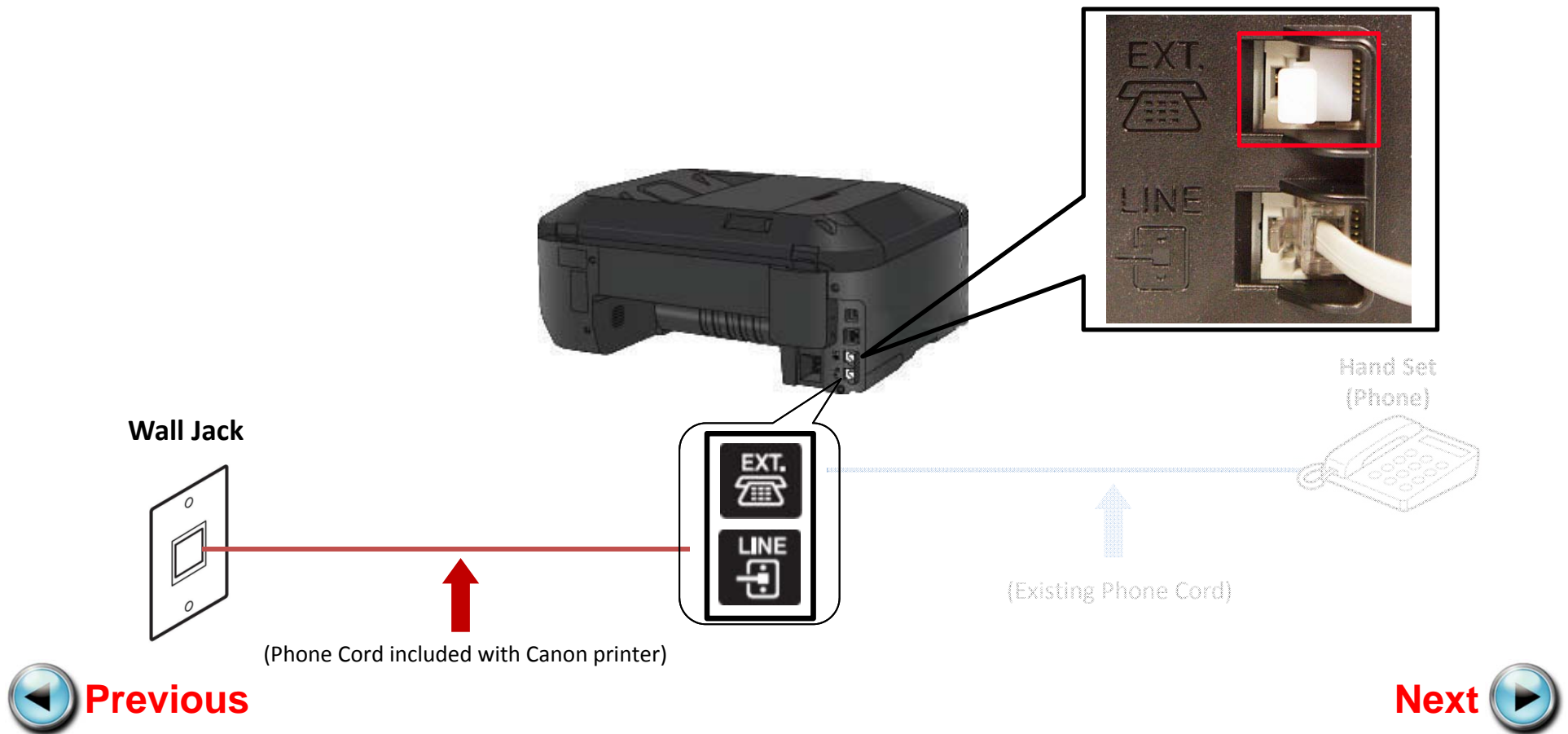

# Fax to Phone Line Connection

- Plug the second phone cord into the “EXT.” jack located on the rear of the multifunction

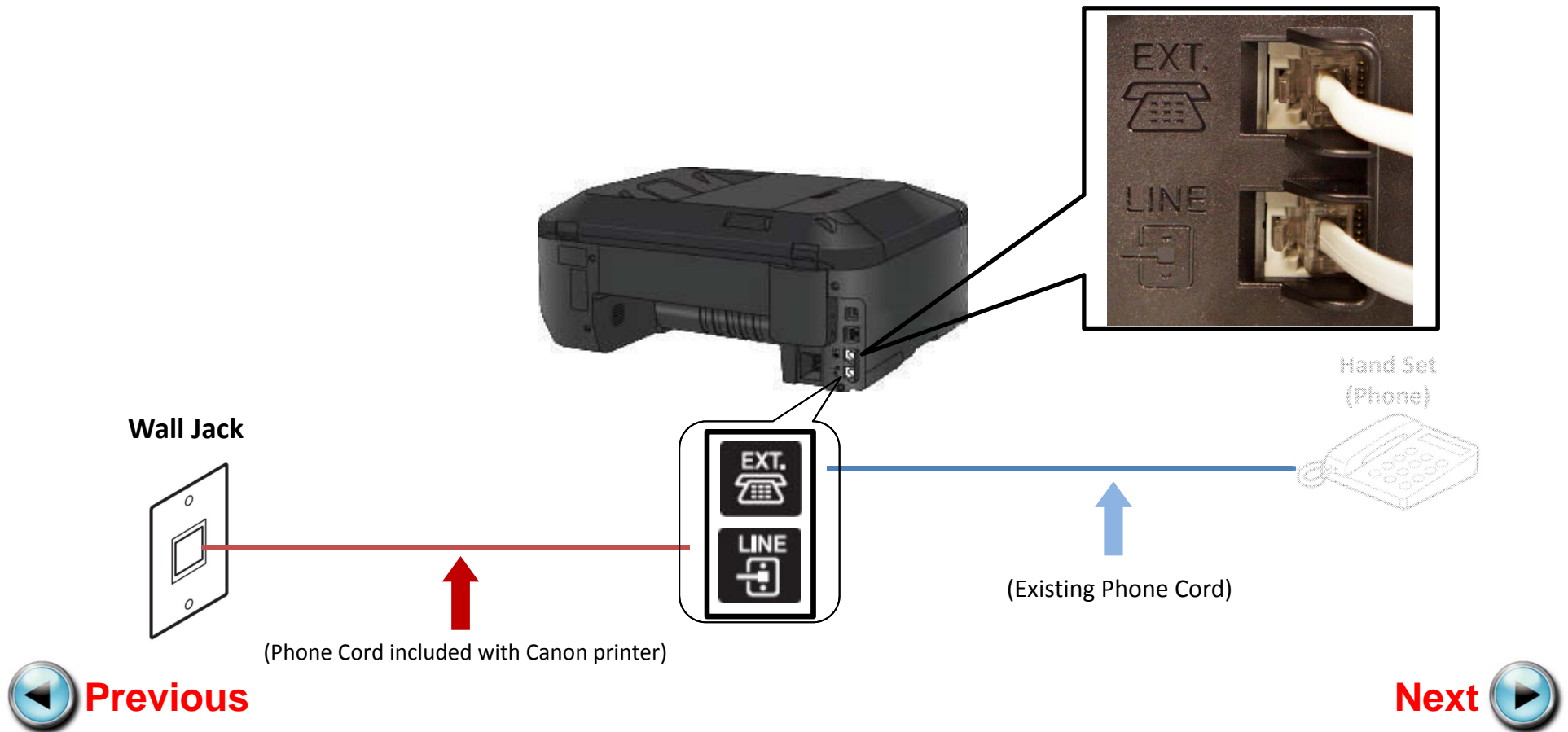



# Fax to Phone Line Connection

- Plug the second phone cord into the phone

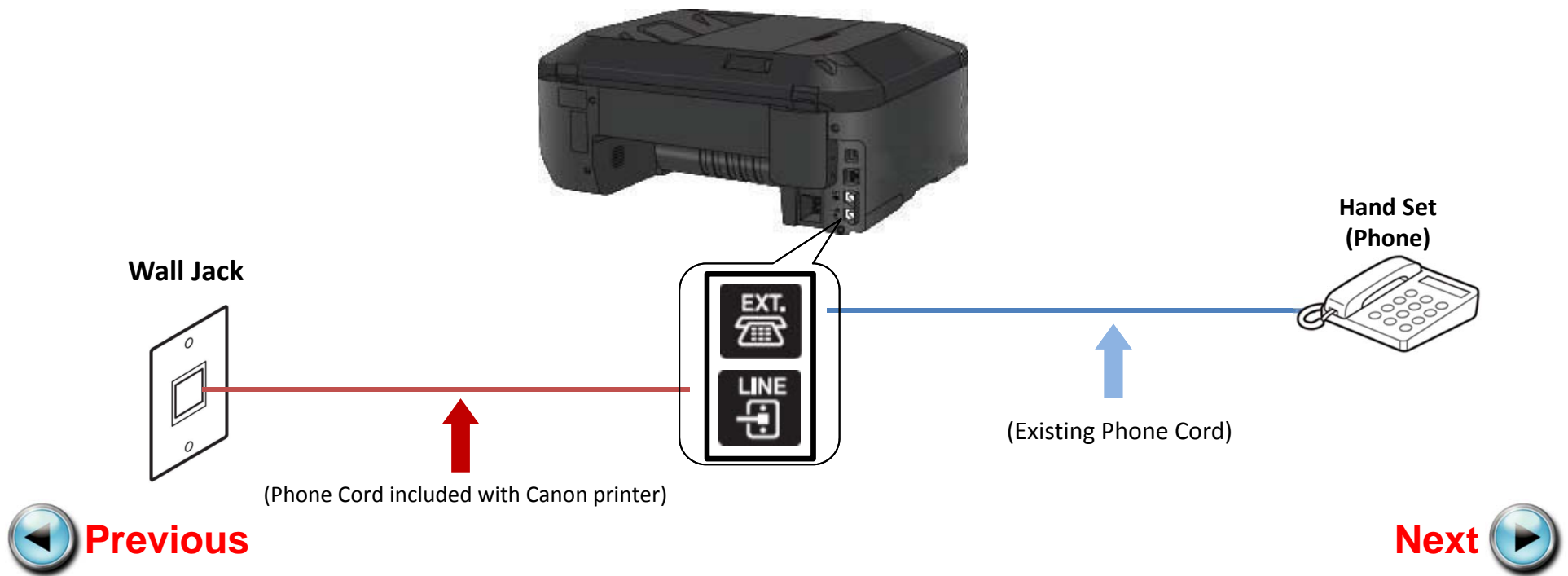



# Setting Up The Receive Mode



## Step 1

Turn on the MX522 by pressing the **ON** button if the machine is not powered on already.

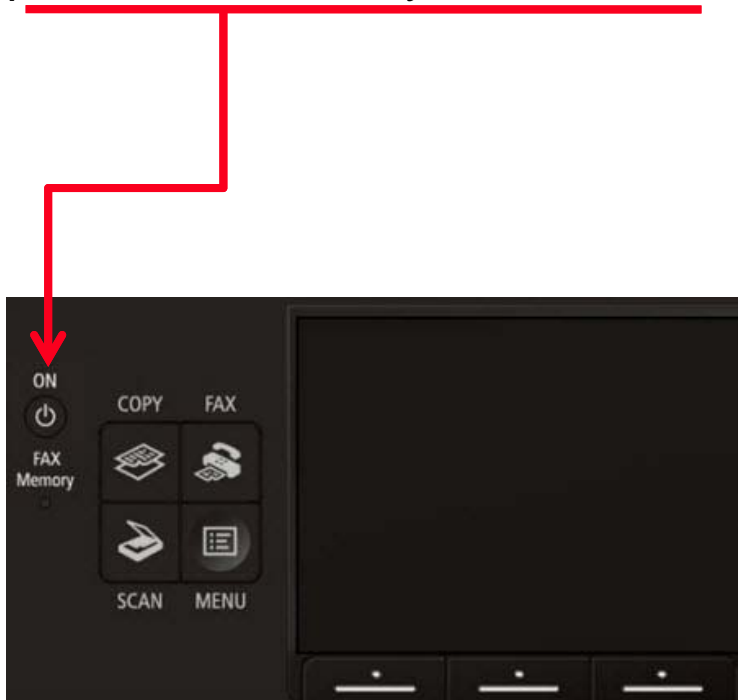

## Step 2

Press the **FAX** button.

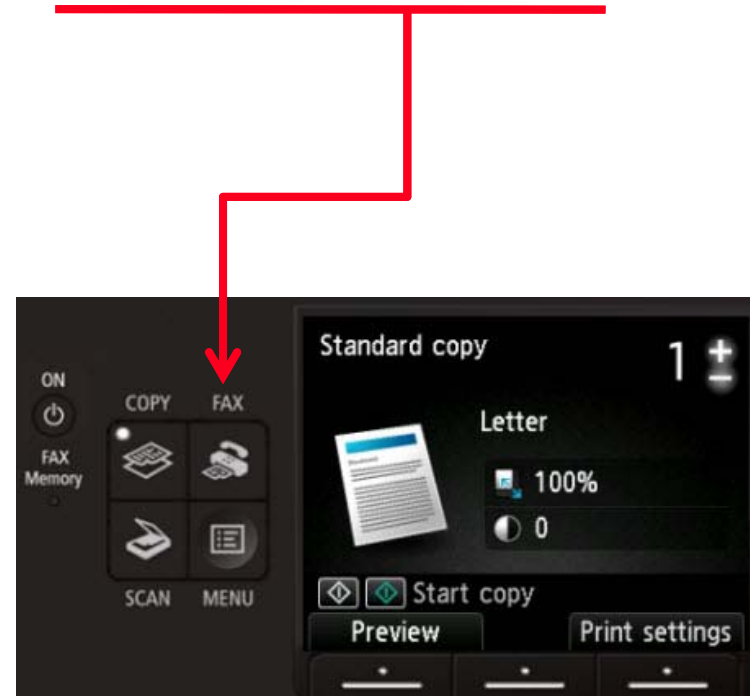

## Step 3

The fax standby screen will appear.

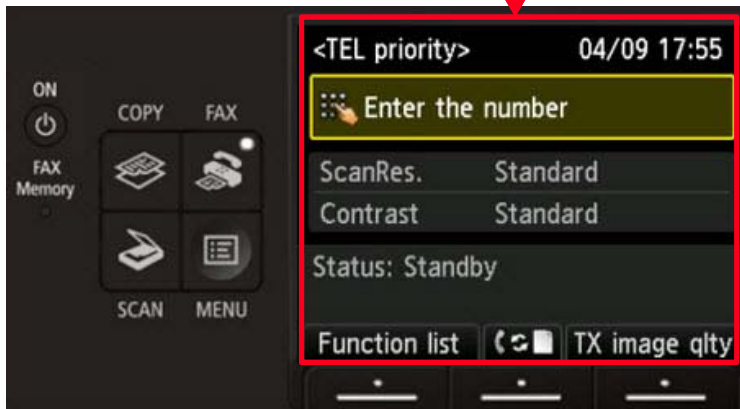

## Step 4

Press the center **FUNCTION** button.

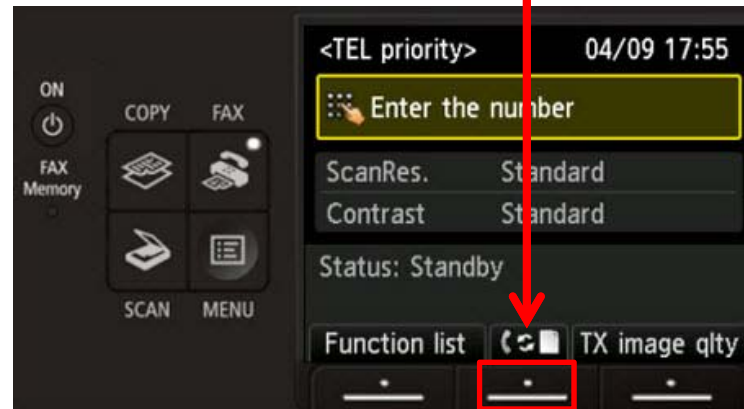

## Step 5

The **Receive mode settings** screen will appear.

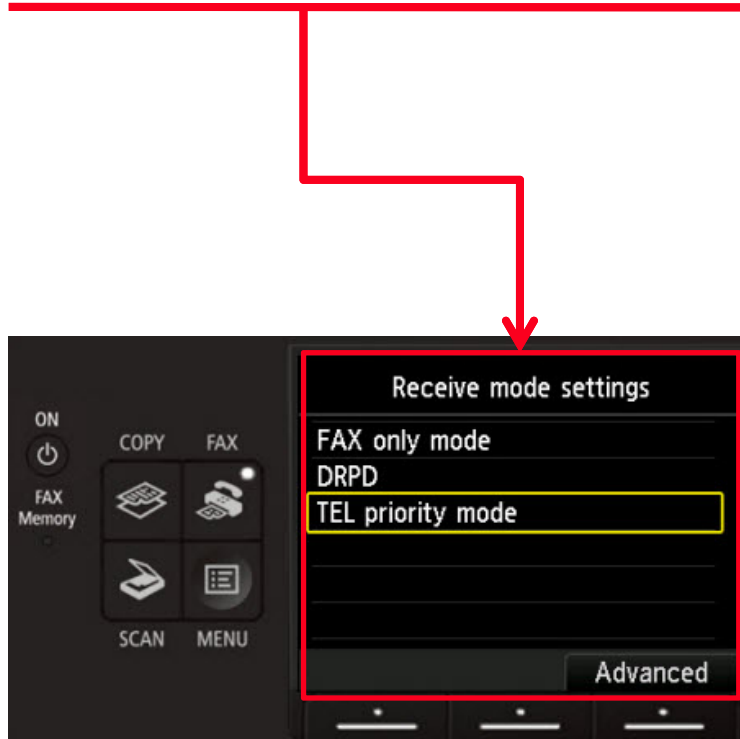

## Step 6

Use the **UP** or **Down** button to highlight "DRPD".

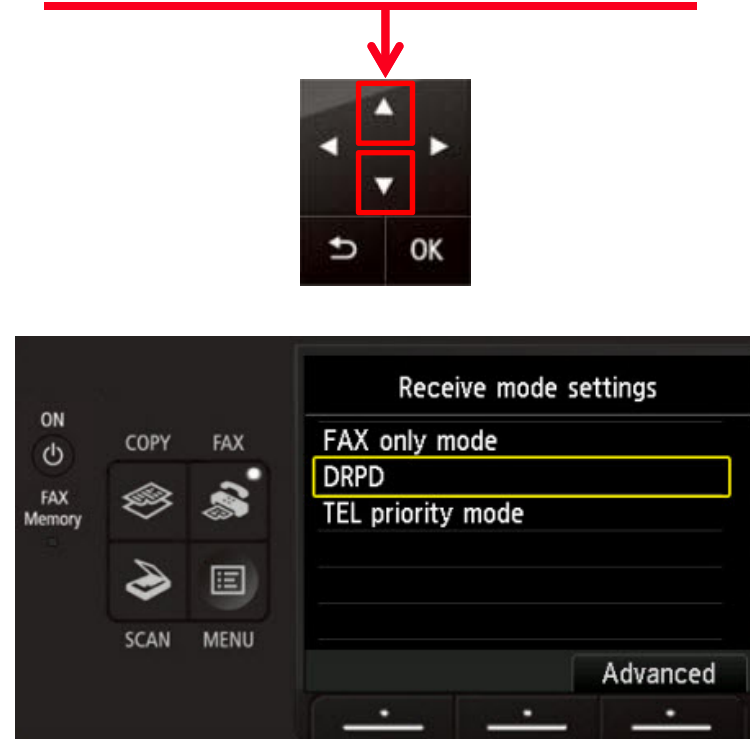

## Step 7

Press the right **FUNCTION** button under the **Advanced** label.

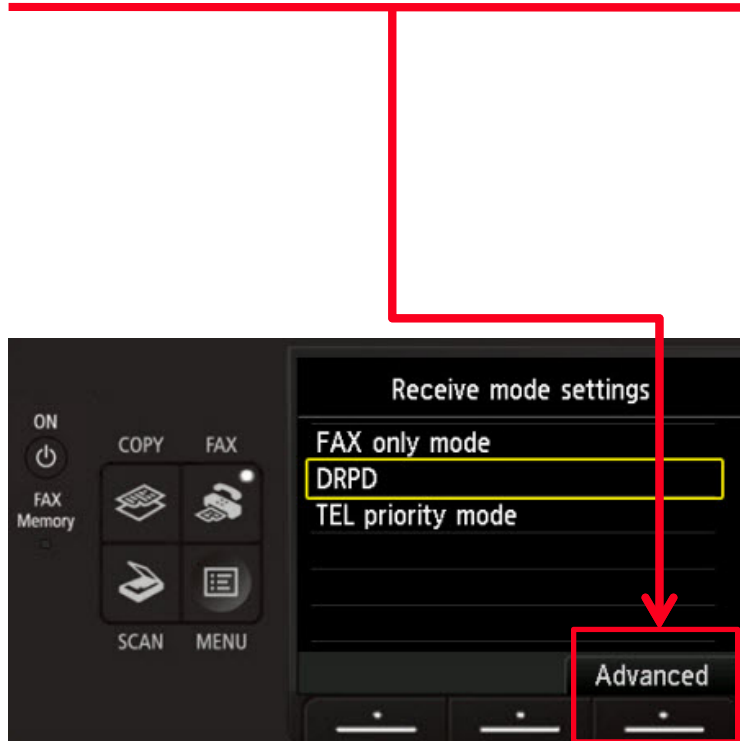

## Step 8

The **Advanced** screen will appear.



## Step 9

Use the **UP** or **Down** button to select “DRPD: FAX ring pattern”.



## Step 10

Press the **OK** button.

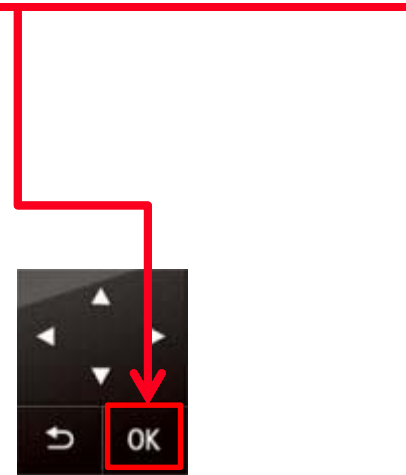

## Step 11

The **DRPD: FAX ring pattern** screen will appear.

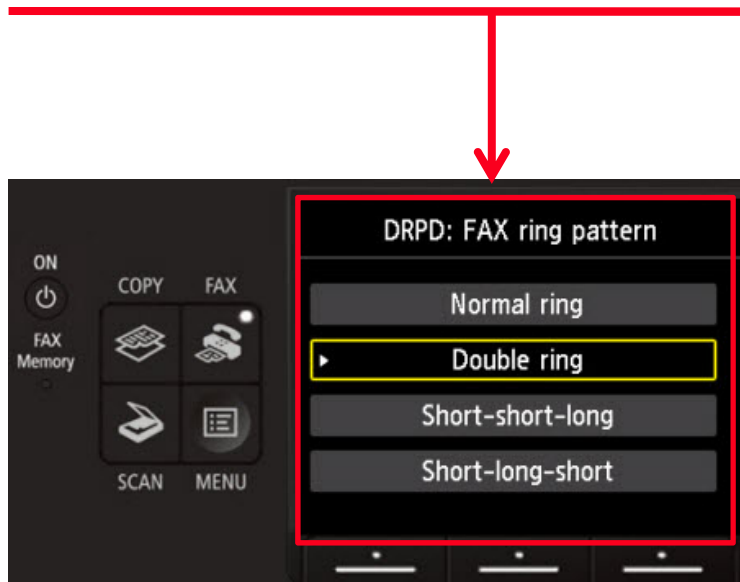

## Step 12

Use the **UP** or **DOWN** button to select the ring pattern assigned to your fax number. Your phone service provider assigns this pattern.

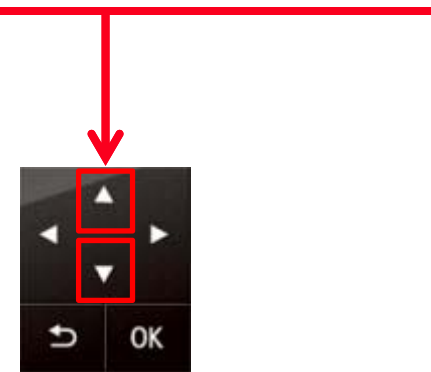

**Note:** The optional ring patterns are:

- Double ring
- Short-short-long
- Short-long-short
- Normal ring



## Step 13

Press the **OK** button.

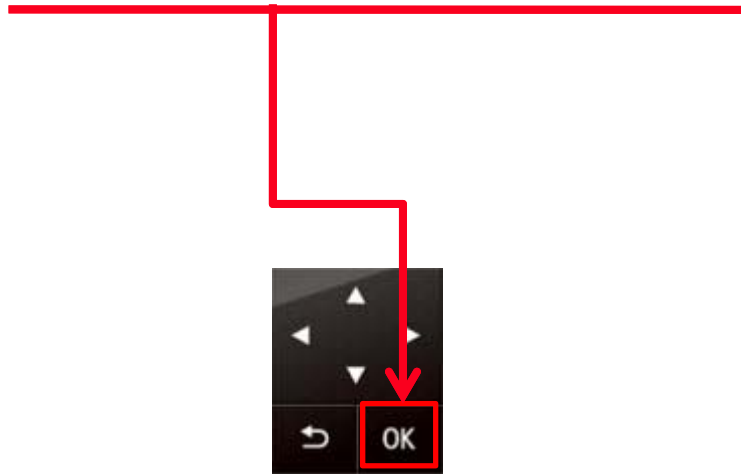

## Step 14

The screen will quickly flash “DRPD: FAX ring pattern” with the selected ring type.

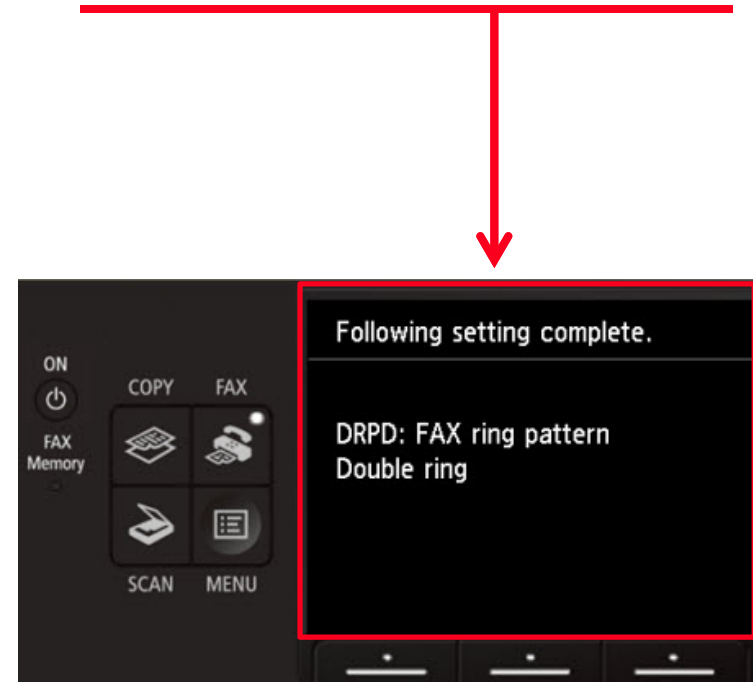

## Step 15

The **Advanced** screen will appear.

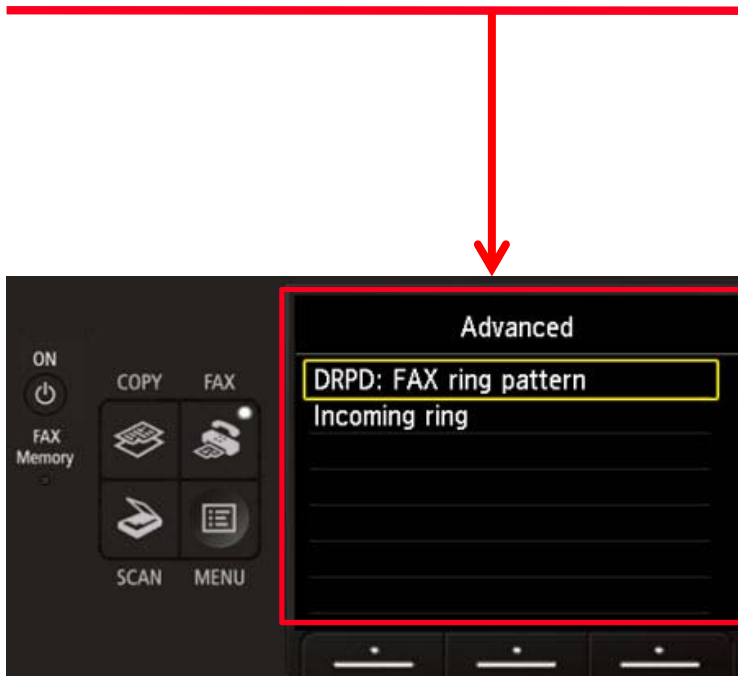

## Step 16

Press the Back button to return to the **Receive mode settings** screen.

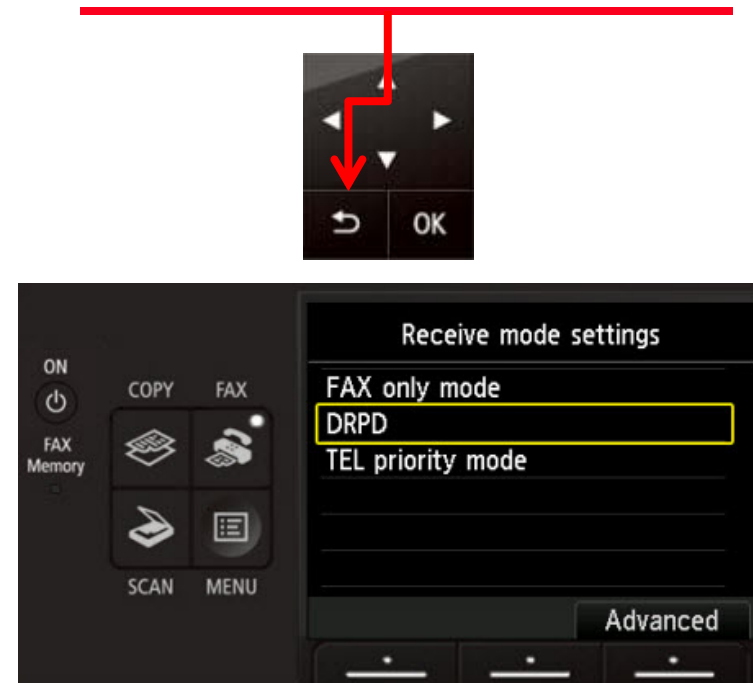

## Step 17

Ensure “DRPD: Fax ring pattern is selected, then press the **OK** button.

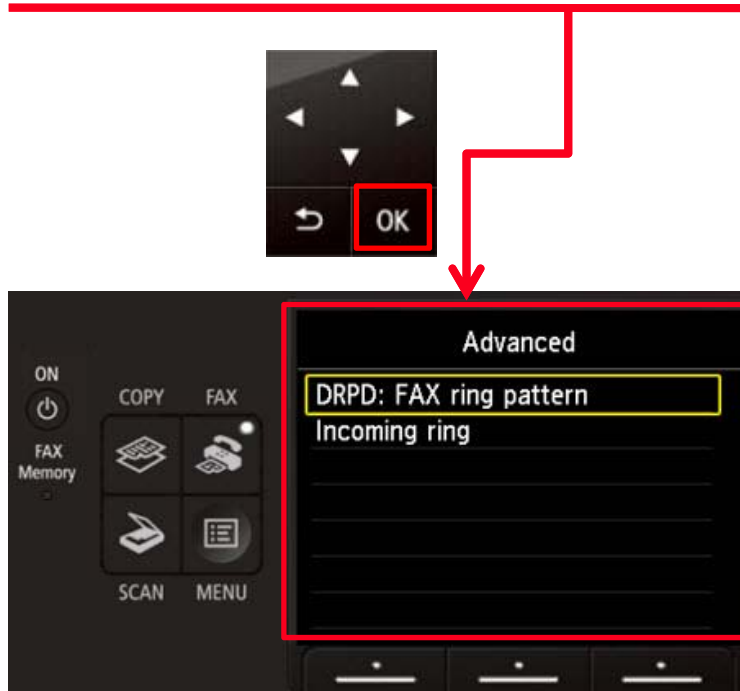

## Step 18

You will return to the “Fax standby screen” and DRPD will appear on the top left corner of the display.

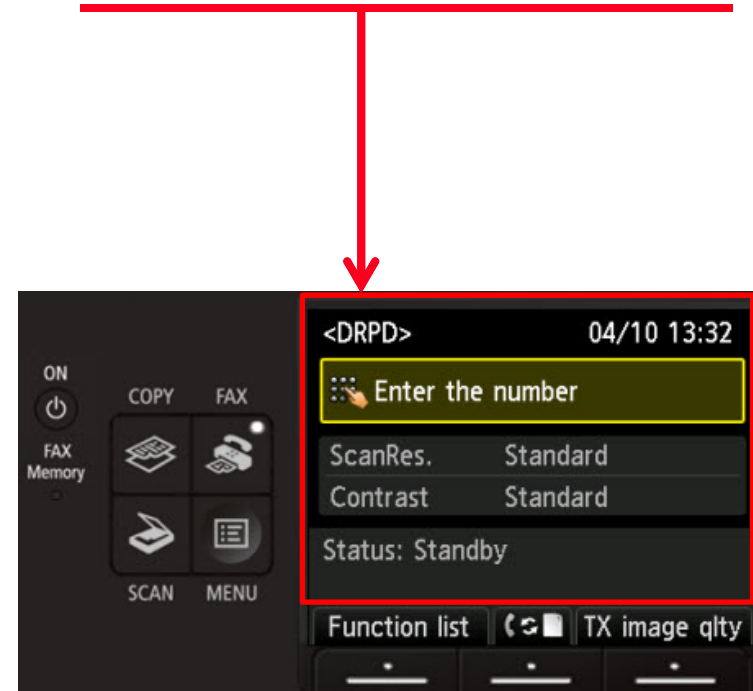

# Receiving A Fax

When a person dials your DRPD number the MX522 will recognize the distinctive ring pattern and will answer the call.

It will begin receiving the fax automatically.

You do not need to be home or interact with the MX522 in order to receive a fax.

