



Dedicated Fax Line Setup Guide

MX432



Connecting The Phone Lines

Connecting The Phone Lines

Before

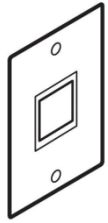

Wall jack

After



Wall jack

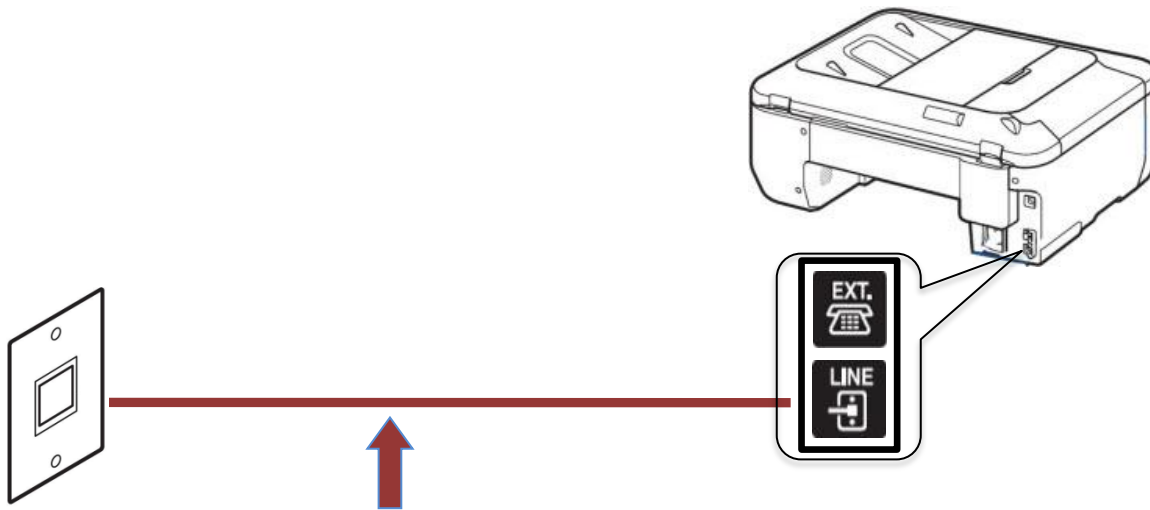

(Phone Cord included with Canon printer)

If Your Wall Plate Has Two Jacks

Use the jack that supports the fax line.



If Your Wall Plate Has One Jack For Two Lines

If your wall jack provides one jack for two phone lines, it would be best to use a “2 Line 3 Way Adapter.” This adapter can be purchased at most stores that sell electronics. This device creates three plugs where there was one. One jack will be for your voice line. The other jack can be used for your fax transactions. In most cases, line 1 (L1) is used for phone calls; L2 is used of faxing. The third jack (L1+L2) allows access to both lines. This is where you would plug in a 2-line telephone, if available.



The L1 jack is usually your voice line

The L2 jack is usually your fax line

Fax to Phone Line Connection

First, connect one end of the supplied telephone cord to the telephone jack on the wall.

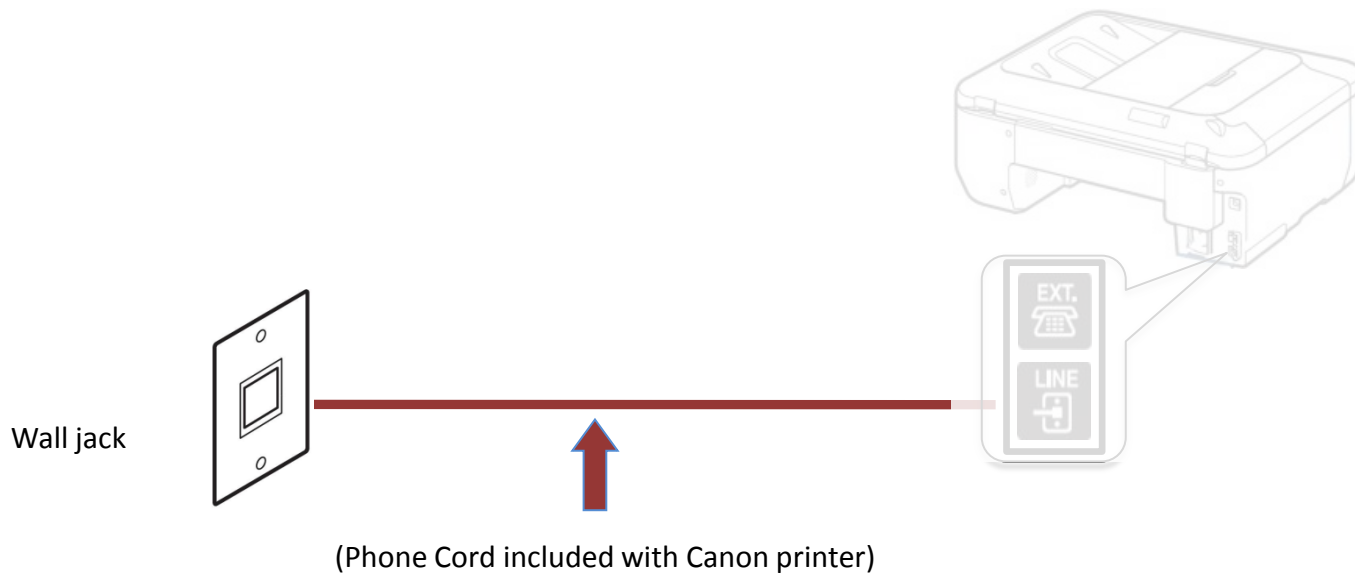

Fax to Phone Line Connection

Next, connect the other end of the supplied telephone cord to the lower jack (labeled "LINE") on the rear of the MX432.

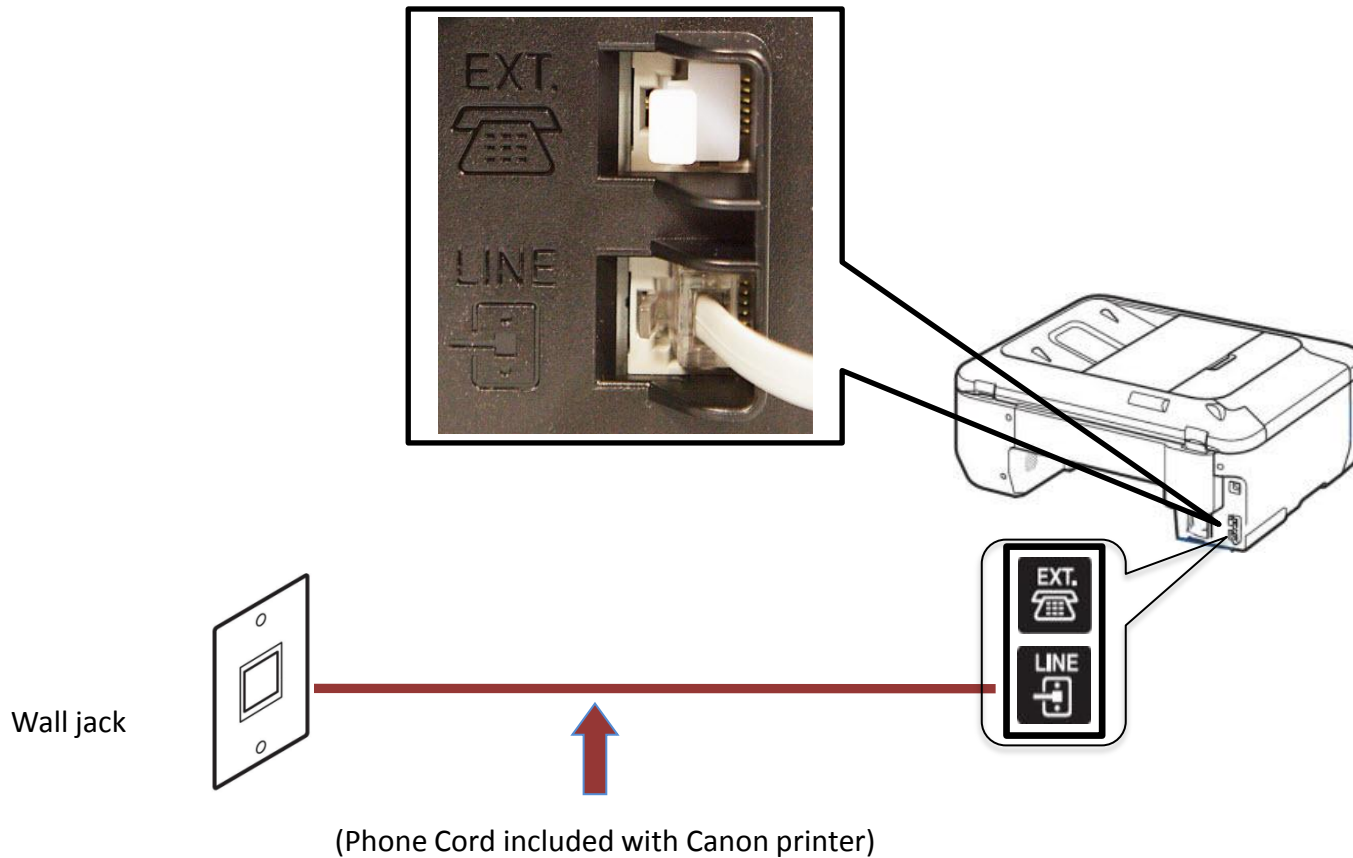

Setting Up The Receive Mode

Step 1

Turn on the MX432 by pressing the **ON** button.



Step 2

Press the **FAX** button.

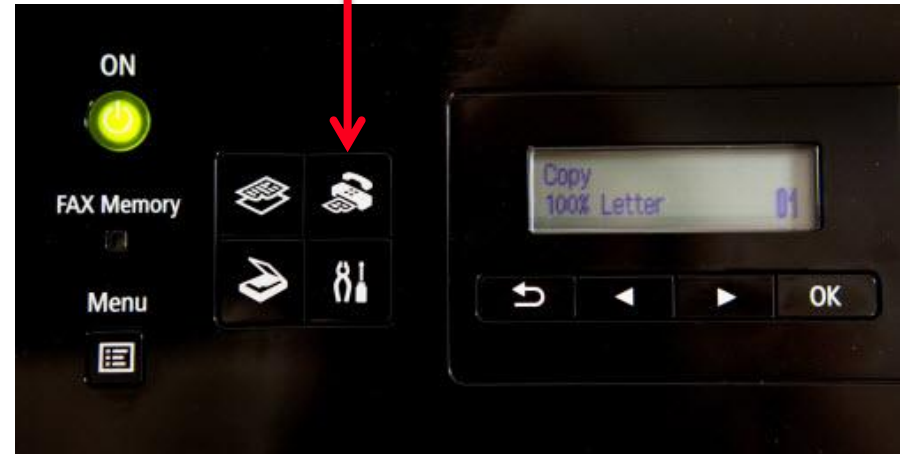

Step 3

The fax standby screen will appear.



Step 4

Press the **Menu** button.



Step 5

The **FAX menu** screen will appear.



Step 6

Use the **LEFT** or **RIGHT** button to select "Receive mode set".

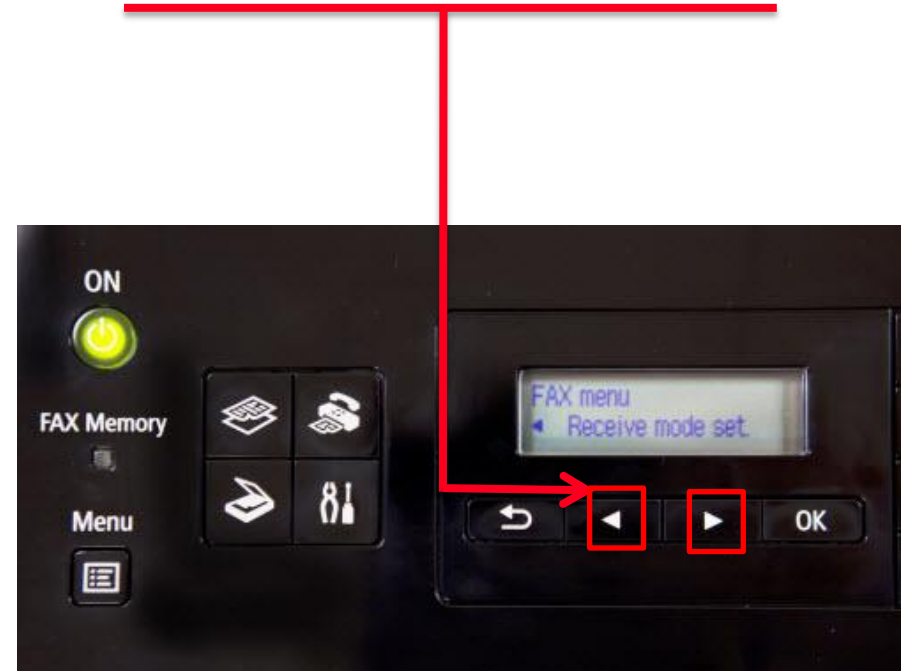

Step 7

Press the **OK** button.



Step 8

Use the **LEFT** or **RIGHT** button to select "FAX only mode".



Step 9

Press the **OK** button.

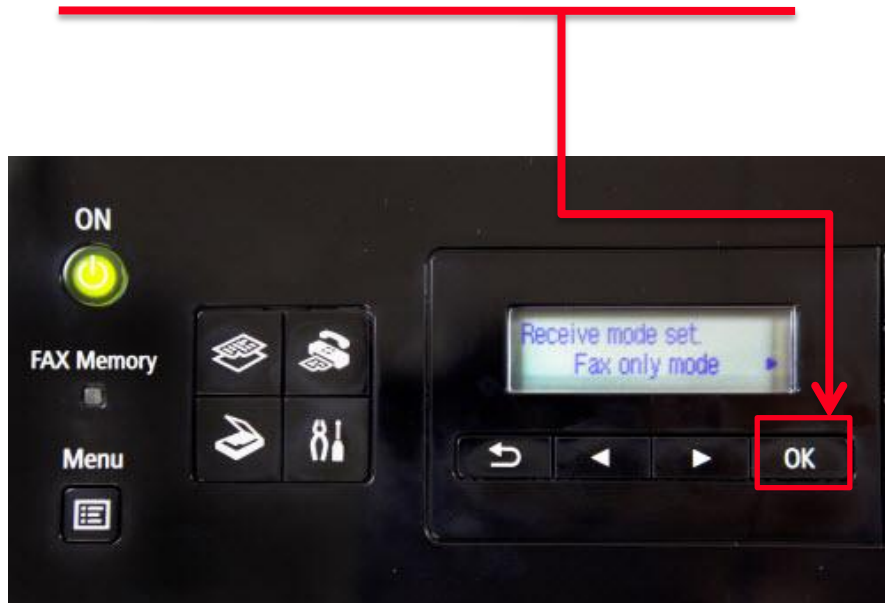

Step 10

Use the **LEFT** or **RIGHT** button to select "No" at **Make adv. settings** screen.

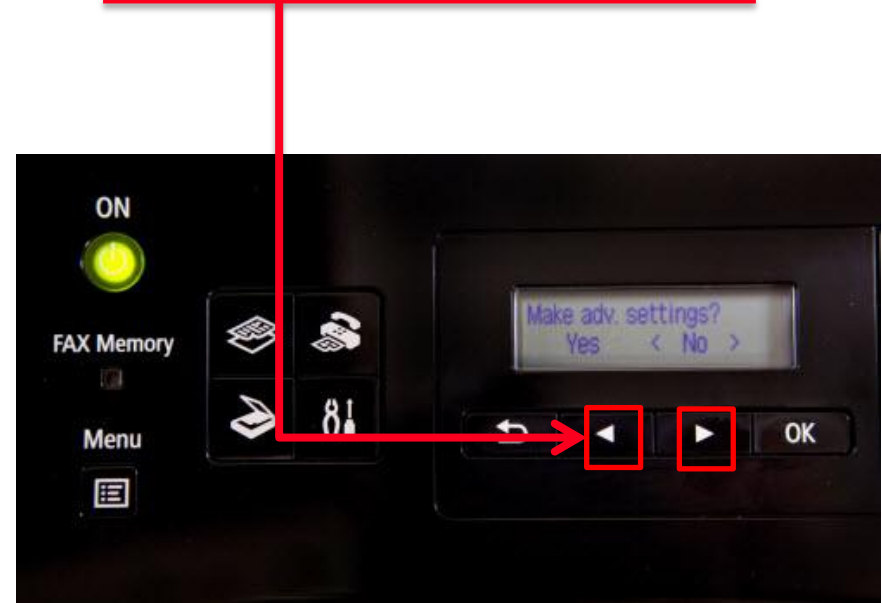

Step 15

Press the **OK** button.



Step 16

You will return to the "Fax standby screen" and the receive mode will appear on the screen.

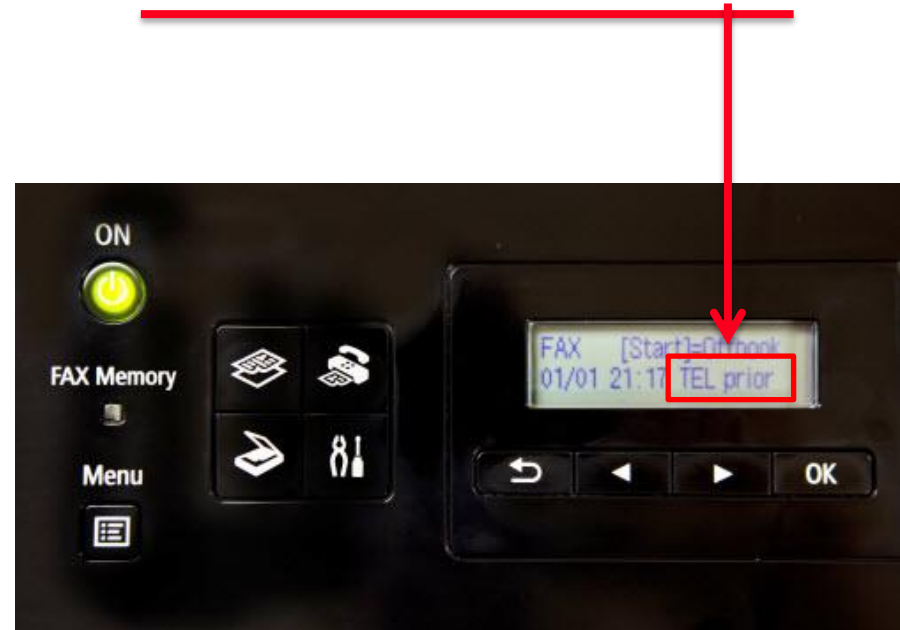

Note: The above screen shows **TEL priority** as the receive mode.

To Receive A Fax

When a call comes in on the fax line, the MX432 will answer the call and begin receiving the fax.

You do not have to be home or interact with the MX432 to receive a fax.

