



How to Use Google Cloud Print

Starting Printing Manually

If you would like to print manually using Google Cloud Print

If the print data is not received by the printer automatically, or if you would like to print immediately after you send the print data, printing can be started manually.

1. Confirm that the printer is turned on.
2. Flick the screen right or left, and tap [**Setup**].

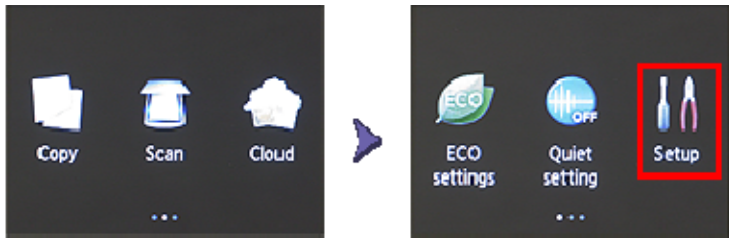

3. Tap [**Web service inquiry**].

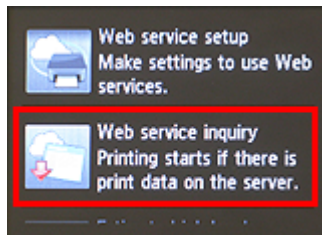

4. Tap [**Print from Google Cloud Print**].



5. The message is displayed asking if you would like to connect to the server to check for the print data. Tap [**Yes**].

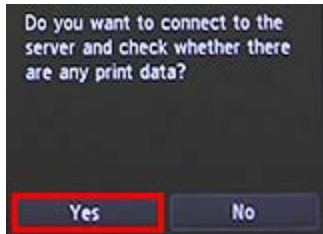

6. When print data exists, it will be received and printed by the printer.

REFERENCE

The [**Start Cloud Print**] option does not appear in the menu unless the printer is properly registered to Google Cloud Print.